

LED

Leuchten-Katalog



Kollektion 2016

INDICE • CONTENTS

Lampade LED Gypsolyte • LED Gypsolyte lamps

MOON & FLAG	Pag. 2
FOLD	Pag. 4
FRAME	Pag. 6
BRIDGE	Pag. 8
BRICK	Pag. 10
SHARD	Pag. 12
LOGOS	Pag. 14
CHRONOS	Pag. 16
GIPSY	Pag. 18
BOB	Pag. 20
FREEWAY	Pag. 22

Incassi Gypsolyte • Gypsolyte fixtures

ARAGON	Pag. 24
ARAGON XL	Pag. 26
ARAGON GLASS	Pag. 28
ARAGON FLAT	Pag. 30
ARAGON TWIN	Pag. 32
OBLÒ	Pag. 34
OBLÒ XL	Pag. 36
OBLÒ FLAT	Pag. 38
SLIDE	Pag. 40
DIAGONAL	Pag. 42
FLARE	Pag. 44
WIZ SISTEM	Pag. 46
NEOS	Pag. 48
ARGO	Pag. 50
CUBE	Pag. 52
PIPE	Pag. 54
ARIEL & PEGASUS	Pag. 56

Incassi Alluminio • Aluminium fixtures

MAYA	Pag. 58
CROWN	Pag. 60
BABEL	Pag. 62
DOME	Pag. 64
BASIC	Pag. 66
INKA	Pag. 68
TEBE	Pag. 70
ECLYPSE	Pag. 72
ZENITH	Pag. 74
SONAR	Pag. 76
GLAM	Pag. 78
FLIP	Pag. 80

Pannelli LED • LED Panels

LED PANEL 60x60 FRAMELESS	Pag. 82
LED PANEL 60x60 - 60x120	Pag. 84
LED PANEL DRI 60x60	Pag. 86
LED PANEL 30x30 - 30x60 - 30x120	Pag. 88
LED PANEL RGB	Pag. 90

Incassi LED • LED downlights

ROUND	Pag. 92
SQUARE	Pag. 94
BUD	Pag. 96
ORION	Pag. 98
ORION RGB	Pag. 100
OPERA	Pag. 102
KARMA	Pag. 104

Proiettori LED • LED floods

GIANT	Pag. 106
SLIM	Pag. 108
MEXICO	Pag. 110
DAKOTA	Pag. 112

Plafoniere stagne LED • LED waterproof fixtures

TORPEDO	Pag. 114
FUTURA	Pag. 116
BILLY	Pag. 118
AQUA	Pag. 120
ZERO	Pag. 122
JAZZ	Pag. 124
ZEUS	Pag. 126

Campane LED • LED High Bay

HIGH BAY 100	Pag. 128
HIGH BAY 150	Pag. 130
HIGH BAY 200	Pag. 132
HIGH BAY EVO	Pag. 134

Lampioni LED • LED street lights

ALASKA 30 - TEXAS 60	Pag. 136
KITS	Pag. 138

MOON & FLAG



Lampade LED Gypsolyte • LED Gypsolyte lamps

MOON & FLAG Lampade LED Gypsolyte • LED Gypsolyte lamps

 Made in Italy



MOON



FLAG

CE EN 55015 • EN 61547 • EN 61347-2-13 • EN 60598-1 • EN 61000-3-2

EMC **IP40** Low Voltage Safety Voltage **RoHS**

Type	Part N°	Input (V)	Power (W)	Lumen	Light Colour	°Kelvin (±10%)	CRI	Dimensions (mm)	Packing box dimensions (mm)	Weight (kg)
MOON	BW8446GLEDNW	230 AC	9±1	690	NW	4000°K	>80	Ø260x50h	310x310x95h	2,10
FLAG	BW8442GLEDNW	100÷240 AC	17±1	1150	NW	4000°K	>80	300x300x50h	360x360x105h	3,00
MOON	BW8446GLEDWW	230 AC	9±1	650	WW	3000°K	>80	Ø260x50h	310x310x95h	2,10
FLAG	BW8442GLEDWW	100÷240 AC	17±1	1380	WW	3000°K	>80	300x300x50h	360x360x105h	3,00

Applique LED

- Struttura in Gypsolyte
- Grande omogeneità luminosa
- Funziona in bassa tensione con trasformatore incorporato
- Consumo molto limitato
- Lunga durata

LED wall lamp

- Structure in Gypsolyte
- Homogeneous light output
- Safety low voltage with specific included driver
- Limited consumption
- Long life time

LED Wandleuchte

- Struktur in Gypsolyte
- Homogenes Licht
- NV-Betrieb durch besonderen Transformator
- Begrenzter Verbrauch
- Lange Lebensdauer

Applique LED

- Corps en Gypsolyte
- Luminosité très homogène
- Il marche en basse tension avec alimentation intégrée
- Consommation très limitée
- Longue durée de vie

Lamparas de pared LED

- Estructura de Gypsolyte
- Excelente homogeneidad luminica
- Alta seguridad por funcionamiento a baja tension, con transformador integrado
- Consumo muy limitado- Larga vida

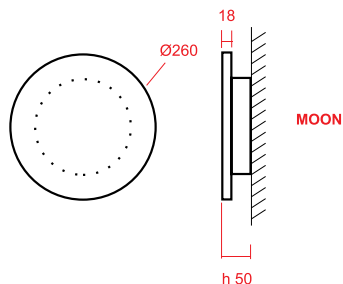

MOON

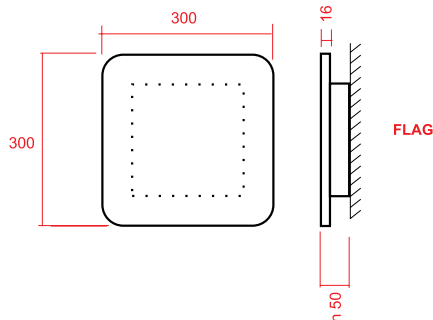

FLAG

FOLD



Lampade LED Gypsolyte • LED Gypsolyte lamps

FOLD Lampade LED Gypsolyte • LED Gypsolyte lamps

Made in Italy

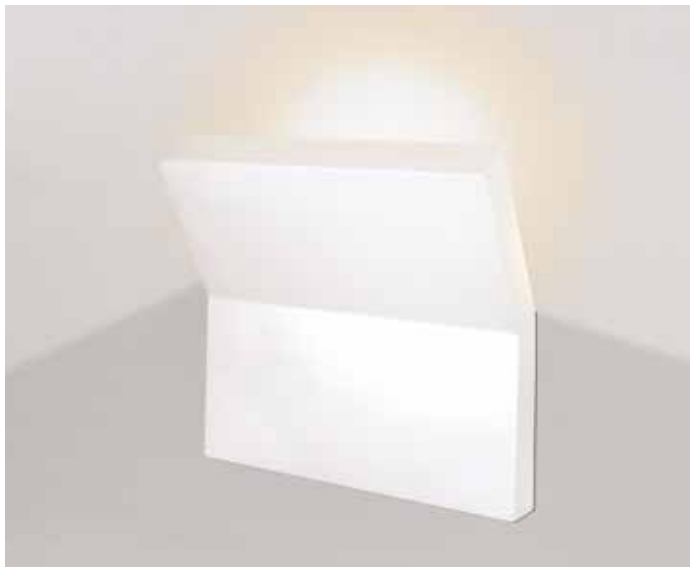

CE EN 55015 • EN 61547 • EN 61347-2-13 • EN 60598-1 • EN 61000-3-2

P.F. 0,96 P.F. 0,60 IP40 EMC RoHS

Type	Part N°	Input (V)	Power (W)	Lumen	Light Colour	°Kelvin (±10%)	CRI	Dimensions (mm)	Packing box dimensions (mm)	Weight (kg)
FOLD SMALL	BW8421GLEDNW	230 AC	10±1	840	NW	4000°K	>80	135x80x300h	370x150x140h	1,30
FOLD LARGE	BW8422GLEDNW	230 AC	29±1	2800	NW	4000°K	>80	135x300x300h	380x370x160h	3,00
FOLD SMALL	BW8421GLEDWW	230 AC	10±1	800	WW	3000°K	>80	135x80x300h	370x150x140h	1,30
FOLD LARGE	BW8422GLEDWW	230 AC	29±1	2650	WW	3000°K	>80	135x300x300h	380x370x160h	3,00

Applique LED

- Struttura in Gypsolyte
- Grande omogeneità luminosa
- Funziona in bassa tensione con trasformatore incorporato
- Consumo molto limitato
- Lunga durata
- P.F. >0,96 (Fold Large), >0,60 (Fold Small)

LED wall lamp

- Structure in Gypsolyte
- Homogeneous light output
- Safety low voltage with specific included driver
- Limited consumption
- Long life time
- P.F. >0,96 (Fold Large), >0,60 (Fold Small)

LED Wandleuchte

- Struktur in Gypsolyte
- Homogenes Licht
- NV-Betrieb durch besonderen Transformator
- Begrenzter Verbrauch
- Lange Lebensdauer
- P.F. >0,96 (Fold Large), >0,60 (Fold Small)

Applique LED

- Corps en Gypsolyte
- Luminosité très homogène

- Il marche en basse tension avec alimentation intégrée
- Consommation très limitée
- Longue durée de vie
- P.F. >0,96 (Fold Large), >0,60 (Fold Small)

Lamparas de pared LED

- Estructura de Gypsolyte
- Excelente homogeneidad luminica
- Alta seguridad por funcionamiento a baja tension, con transformador integrado
- Consumo muy limitado- Larga vida
- P.F. >0,96 (Fold Large), >0,60 (Fold Small)

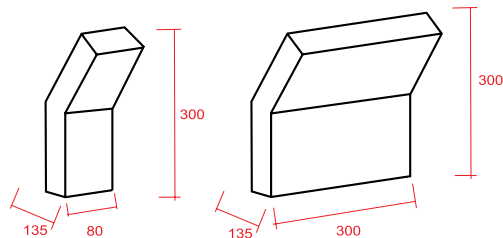

FRAME



Lampade LED Gypsolyte • LED Gypsolyte lamps

FRAME Lampade LED Gypsolyte • LED Gypsolyte lamps

 Made in Italy

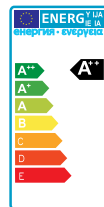

CE EN 55015 • EN 61547 • EN 61347-2-13 • EN 60598-1 • EN 61000-3-2

Low Voltage
Safety Voltage

P.F. 0,60

IP40

EMC RoHS

Type	Part N°	Input (V)	Power (W)	Lumen	Light Colour	°Kelvin (±10%)	CRI	Dimensions (mm)	Packing box dimensions (mm)	Weight (kg)
FRAME RD	BW8439GLEDNW	100÷240 AC	9±1	850	NW	4000°K	>80	202x150x50h	245x205x105h	1,10
FRAME SQ	BW8438GLEDNW	100÷240 AC	9±1	850	NW	4000°K	>80	222x150x50h	265x210x110h	1,30
FRAME RD	BW8439GLEDWW	100÷240 AC	9±1	800	WW	3000°K	>80	202x150x50h	245x205x105h	1,10
FRAME SQ	BW8438GLEDWW	100÷240 AC	9±1	800	WW	3000°K	>80	222x150x50h	265x210x110h	1,30

Applique LED

- Struttura in Gypsolyte
- Grande omogeneità luminosa
- Funziona in bassa tensione con trasformatore incorporato
- Consumo molto limitato
- Lunga durata

- Alta seguridad por funcionamiento a baja tension, con transformador integrado
- Consumo muy limitado
- Larga vida

LED wall lamp

- Structure in Gypsolyte
- Homogeneous light output
- Safety low voltage with specific included driver
- Limited consumption
- Long life time

LED Wandleuchte

- Struktur in Gypsolyte
- Homogenes Licht
- NV-Betrieb durch besonderen Transformator
- Begrenzter Verbrauch
- Lange Lebensdauer

Applique LED

- Corps en Gypsolyte
- Luminosité très homogène
- Il marche en basse tension avec alimentation intégrée
- Consommation très limitée
- Longue durée de vie

Lamparas de pared LED

- Estructura de Gypsolyte
- Excelente homogeneidad luminica

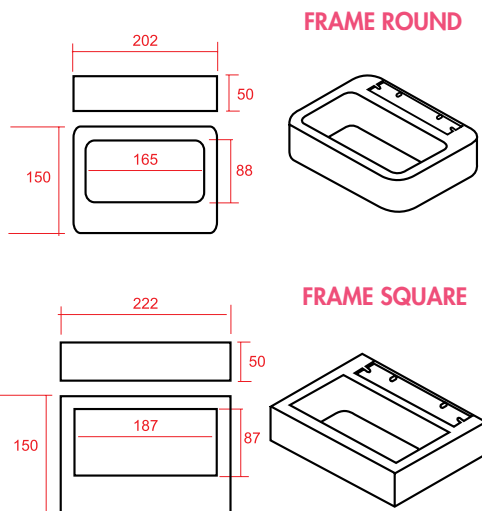

BRIDGE



Lampade LED Gypsolyte • LED Gypsolyte lamps

BRIDGE Lampade LED Gypsolyte • LED Gypsolyte lamps

 Made in Italy

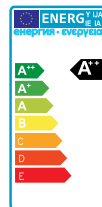

CE EN 55015 • EN 61547 • EN 61347-2-13 • EN 60598-1 • EN 61000-3-2

Low Voltage
Safety Voltage

P.F. 0,60

IP40

EMC RoHS

Type	Part N°	Input (V)	Power (W)	Lumen	Light Colour	°Kelvin (±10%)	CRI	Dimensions (mm)	Packing box dimensions (mm)	Weight (kg)
BRIDGE	BW8430GLEDNW	230 AC	14±1	1380	NW	4000°K	>80	318x134x56h	370x210x100h	1,60
BRIDGE	BW8430GLEDWW	230 AC	14±1	1300	WW	3000°K	>80	318x134x56h	370x210x100h	1,60

Applique LED

- Struttura in Gypsolyte
- Grande omogeneità luminosa
- Funziona in bassa tensione con trasformatore incorporato
- Consumo molto limitato
- Lunga durata

LED wall lamp

- Structure in Gypsolyte
- Homogeneous light output
- Safety low voltage with specific included driver
- Limited consumption
- Long life time

LED Wandleuchte

- Struktur in Gypsolyte
- Homogenes Licht
- NV-Betrieb durch besonderen Transformator
- Begrenzter Verbrauch
- Lange Lebensdauer

Applique LED

- Corps en Gypsolyte
- Luminosité très homogène
- Il marche en basse tension avec alimentation intégrée
- Consommation très limitée
- Longue durée de vie

Lamparas de pared LED

- Estructura de Gypsolyte
- Excelente homogeneidad luminica
- Alta seguridad por funcionamiento a baja tension, con transformador integrado
- Consumo muy limitado- Larga vida

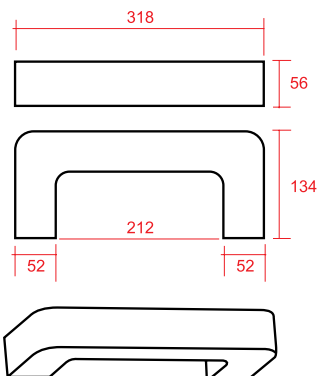

BRICK



Lampade LED Gypsolyte • LED Gypsolyte lamps

BRICK Lampade LED Gypsolyte • LED Gypsolyte lamps

 Made in Italy



CE EN 55015 • EN 61547 • EN 61347-2-13 • EN 60598-1 • EN 61000-3-2

P.F. 0,99

IP40

EMC RoHS

Type	Part N°	Input (V)	Power (W)	Lumen	Light Colour	°Kelvin (±10%)	CRI	Dimensions (mm)	Packing box dimensions (mm)	Weight (kg)
BRICK	BW8211GLEDNW	230 AC	10±1	840	NW	4000°K	>80	275x94x57h	340x150x120h	1,30
BRICK	BW8211GLEDWW	230 AC	10±1	800	WW	3000°K	>80	275x94x57h	340x150x120h	1,30

Applique LED

- Struttura in Gypsolyte
- Grande omogeneità luminosa
- Funziona in bassa tensione con trasformatore incorporato
- Consumo molto limitato
- Lunga durata

LED wall lamp

- Structure in Gypsolyte
- Homogeneous light output
- Safety low voltage with specific included driver
- Limited consumption
- Long life time

LED Wandleuchte

- Struktur in Gypsolyte
- Homogenes Licht
- NV-Betrieb durch besonderen Transformator
- Begrenzter Verbrauch
- Lange Lebensdauer

Applique LED

- Corps en Gypsolyte
- Luminosité très homogène
- Il marche en basse tension avec alimentation intégrée
- Consommation très limitée
- Longue durée de vie

Lamparas de pared LED

- Estructura de Gypsolyte
- Excelente homogeneidad luminica
- Alta seguridad por funcionamiento a baja tension, con transformador integrado
- Consumo muy limitado- Larga vida

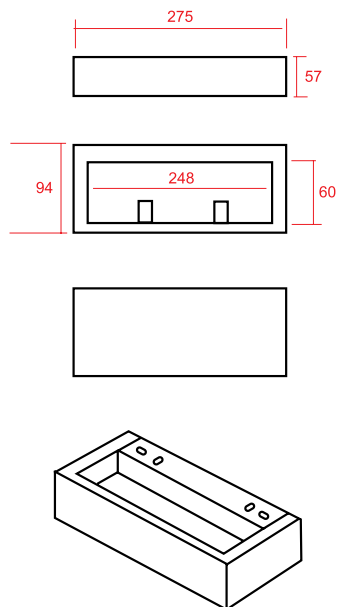

SHARD



Lampade LED Gypsolyte • LED Gypsolyte lamps

SHARD Lampade LED Gypsolyte • LED Gypsolyte lamps

 Made in Italy



CE EN 55015 • EN 61547 • EN 61347-2-13 • EN 60598-1 • EN 61000-3-2

P.F. 0,85 **IP40** EMC RoHS

Type	Part N°	Input (V)	Power (W)	Lumen	Light Colour	°Kelvin (±10%)	CRI	Dimensions (mm)	Packing box dimensions (mm)	Weight (kg)
SHARD NW	BW8432GLEDNW	230 AC	18±1	1700	NW	4000°K	>80	250x125x59h	330x310x135h	2,20
SHARD WW	BW8432GLEDWW	230 AC	18±1	1600	WW	3000°K	>80	250x125x59h	330x310x135h	2,20

Applique LED

- Struttura in Gypsolyte
- Grande omogeneità luminosa
- Funziona in bassa tensione con trasformatore incorporato
- Consumo molto limitato
- Lunga durata

LED wall lamp

- Structure in Gypsolyte
- Homogeneous light output
- Safety low voltage with specific included driver
- Limited consumption
- Long life time

LED Wandleuchte

- Struktur in Gypsolyte
- Homogenes Licht
- NV-Betrieb durch besonderen Transformator
- Begrenzter Verbrauch
- Lange Lebensdauer

Applique LED

- Corps en Gypsolyte
- Luminosité très homogène
- Il marche en basse tension avec alimentation intégrée
- Consommation très limitée
- Longue durée de vie

Lamparas de pared LED

- Estructura de Gypsolyte
- Excelente homogeneidad luminica
- Alta seguridad por funcionamiento a baja tension, con transformador integrado
- Consumo muy limitado- Larga vida

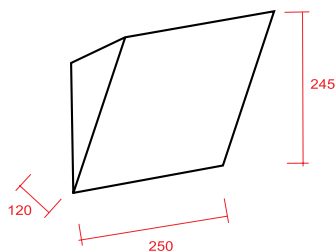

LOGOS



Lampade LED Gypsolyte • LED Gypsolyte lamps

LOGOS Lampade LED Gypsolyte • LED Gypsolyte lamps

 Made in Italy

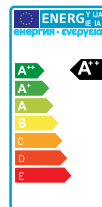

CE EN 55015 • EN 61547 • EN 61347-2-13 • EN 60598-1 • EN 61000-3-2

Low Voltage
Safety Voltage

P.F. 0,60

IP40

EMC RoHS

Type	Part N°	Input (V)	Power (W)	Lumen	Light Colour	°Kelvin (±10%)	CRI	Dimensions (mm)	Packing box dimensions (mm)	Weight (kg)
LOGOS	BW8339GLEDNW	100÷240 AC	9±1	830	NW	4000°K	>80	125x125x59h	170x170x110h	1,00
LOGOS	BW8339GLEDWW	100÷240 AC	9±1	780	WW	3000°K	>80	125x125x59h	170x170x110h	1,00

Applique LED

- Struttura in Gypsolyte
- Grande omogeneità luminosa
- Funziona in bassa tensione con trasformatore incorporato
- Consumo molto limitato
- Lunga durata

LED wall lamp

- Structure in Gypsolyte
- Homogeneous light output
- Safety low voltage with specific included driver
- Limited consumption
- Long life time

LED Wandleuchte

- Struktur in Gypsolyte
- Homogenes Licht
- NV-Betrieb durch besonderen Transformator
- Begrenzter Verbrauch
- Lange Lebensdauer

Applique LED

- Corps en Gypsolyte
- Luminosité très homogène
- Il marche en basse tension avec alimentation intégrée
- Consommation très limitée
- Longue durée de vie

Lamparas de pared LED

- Estructura de Gypsolyte
- Excelente homogeneidad luminica
- Alta seguridad por funcionamiento a baja tension, con transformador integrado
- Consumo muy limitado- Larga vida

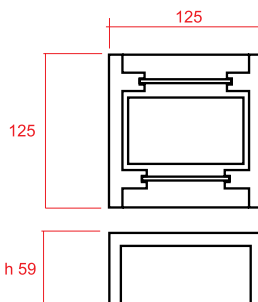
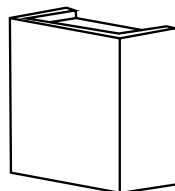

CHRONOS



Lampade LED Gypsolyte • LED Gypsolyte lamps

CHRONOS Lampade LED Gypsolyte • LED Gypsolyte lamps

 Made in Italy

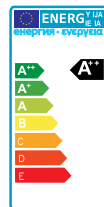

CE EN 55015 • EN 61547 • EN 61347-2-13 • EN 60598-1 • EN 61000-3-2

Low Voltage
Safety Voltage

P.F. 0,60

IP40

EMC RoHS

Type	Part N°	Input (V)	Power (W)	Lumen	Light Colour	°Kelvin (±10%)	CRI	Dimensions (mm)	Packing box dimensions (mm)	Weight (kg)
CHRONOS	BW8440GLEDNW	100÷240 AC	9±1	830	NW	4000°K	>80	Ø155x59h	200x200x130h	1,00
CHRONOS	BW8440GLEDWW	100÷240 AC	9±1	780	WW	3000°K	>80	Ø155x59h	200x200x130h	1,00

Applique LED

- Struttura in Gypsolyte
- Grande omogeneità luminosa
- Funziona in bassa tensione con trasformatore incorporato
- Consumo molto limitato
- Lunga durata

LED wall lamp

- Structure in Gypsolyte
- Homogeneous light output
- Safety low voltage with specific included driver
- Limited consumption
- Long life time

LED Wandleuchte

- Struktur in Gypsolyte
- Homogenes Licht
- NV-Betrieb durch besonderen Transformator
- Begrenzter Verbrauch
- Lange Lebensdauer

Applique LED

- Corps en Gypsolyte
- Luminosité très homogène
- Il marche en basse tension avec alimentation intégrée
- Consommation très limitée
- Longue durée de vie

Lamparas de pared LED

- Estructura de Gypsolyte
- Excelente homogeneidad luminica
- Alta seguridad por funcionamiento a baja tension, con transformador integrado
- Consumo muy limitado- Larga vida

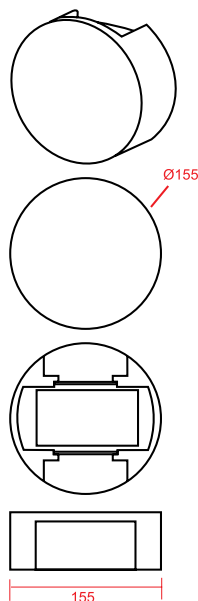

GIPSY



Lampade LED Gypsolyte • LED Gypsolyte lamps

GIPSY Lampade LED Gypsolyte • LED Gypsolyte lamps

 Made in Italy

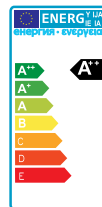

CE EN 55015 • EN 61547 • EN 61347-2-13 • EN 60598-1 • EN 61000-3-2

Low Voltage
Safety Voltage

P.F. 0,60

IP40

EMC RoHS

Type	Part N°	Input (V)	Power (W)	Lumen	Light Colour	°Kelvin (±10%)	CRI	Dimensions (mm)	Packing box dimensions (mm)	Weight (kg)
GIPSY	BW8437GLEDNW	100÷240 AC	9±1	830	NW	4000°K	>80	120x60x222h	180x135x275h	0,97
GIPSY	BW8437GLEDWW	100÷240 AC	9±1	780	WW	3000°K	>80	120x60x222h	180x135x275h	0,97

Applique LED

- Struttura in Gypsolyte
- Grande omogeneità luminosa
- Funziona in bassa tensione con trasformatore incorporato
- Consumo molto limitato
- Lunga durata

LED wall lamp

- Structure in Gypsolyte
- Homogeneous light output
- Safety low voltage with specific included driver
- Limited consumption
- Long life time

LED Wandleuchte

- Struktur in Gypsolyte
- Homogenes Licht
- NV-Betrieb durch besonderen Transformator
- Begrenzter Verbrauch
- Lange Lebensdauer

Applique LED

- Corps en Gypsolyte
- Luminosité très homogène
- Il marche en basse tension avec alimentation intégrée
- Consommation très limitée
- Longue durée de vie

Lamparas de pared LED

- Estructura de Gypsolyte
- Excelente homogeneidad luminica
- Alta seguridad por funcionamiento a baja tension, con transformador integrado
- Consumo muy limitado- Larga vida

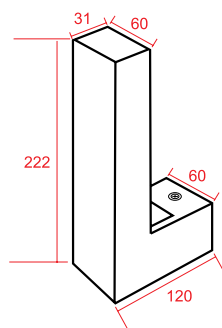

BOB



Lampade LED Gypsolyte • LED Gypsolyte lamps

BOB Lampade LED Gypsolyte • LED Gypsolyte lamps

 Made in Italy

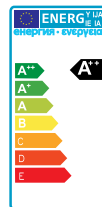

CE EN 55015 • EN 61547 • EN 61347-2-13 • EN 60598-1 • EN 61000-3-2

Low Voltage
Safety Voltage

P.F. 0,60

IP40

EMC RoHS

Type	Part N°	Input (V)	Power (W)	Lumen	Light Colour	°Kelvin (±10%)	CRI	Dimensions (mm)	Packing box dimensions (mm)	Weight (kg)
BOB	BW8417GLEDWW	100±230 AC	7	350	WW	3000°K	>80	150x125x100h	210x200x180h	1,47

Applique LED

- Struttura in Gypsolyte
- Grande omogeneità luminosa
- Funziona in bassa tensione con trasformatore incorporato
- Consumo molto limitato
- Lunga durata

LED wall lamp

- Structure in Gypsolyte
- Homogeneous light output
- Safety low voltage with specific included driver
- Limited consumption
- Long life time

LED Wandleuchte

- Struktur in Gypsolyte
- Homogenes Licht
- NV-Betrieb durch besonderen Transformator
- Begrenzter Verbrauch
- Lange Lebensdauer

Applique LED

- Corps en Gypsolyte
- Luminosité très homogène
- Il marche en basse tension avec alimentation intégrée
- Consommation très limitée
- Longue durée de vie

Lamparas de pared LED

- Estructura de Gypsolyte
- Excelente homogeneidad luminica
- Alta seguridad por funcionamiento a baja tension, con transformador integrado
- Consumo muy limitado- Larga vida

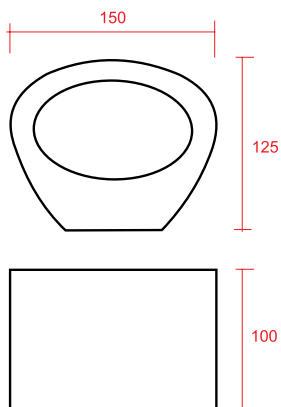

FREEWAY



Lampade LED Gypsolyte • LED Gypsolyte lamps

FREEWAY Incassi Gypsolyte • Gypsolyte fixtures

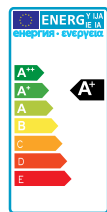

FREEWAY LED

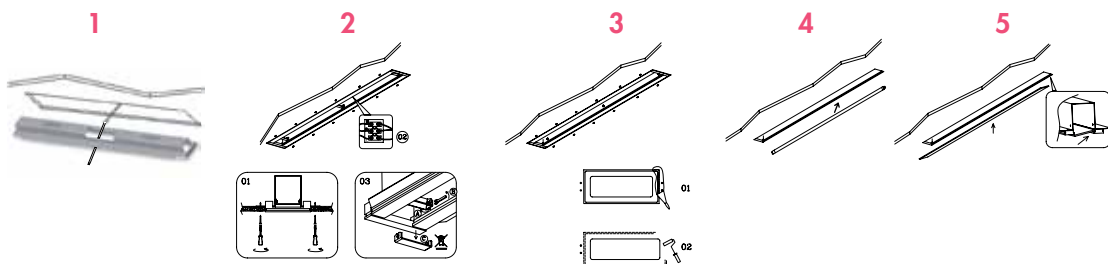

Type	Part n°	Dimensions mm	Colour	 mm	Packing box dimensions (mm)	Packing box (kg)
FREEWAY CW	B9250G120L1B	1190x175x55h	White	1250x130	1250x220x120	4,50

Type	Part n°	Dimensions mm	Input V	Power W	Lumen mm	Colour °K	 (mm)	Packing box dimensions (mm)	Packing box (kg)
FREEWAY CW	B9250LED500B	1190x175x55h	90÷250V	20	2000	5000°	1250x130	1250x220x120	5,50
FREEWAY NW	B9250LED440B	1190x175x55h	90÷250V	20	1950	4400°	1250x130	1250x220x120	5,50
FREEWAY WW	B9250LED300B	1190x175x55h	90÷250V	20	1750	3000°	1250x130	1250x220x120	5,50

- Incasso in Gypsolyte per controsoffitti**
- Incasso invisibile per controsoffitti
 - Dopo aver rasato a gesso il controsoffitto, l'incasso risulta parte integrante del soffitto stesso e può essere finteggiato
 - Apertura per installazione 1250x130 mm.
 - Spessore controsoffitto 13mm
 - Profondità minima: 100 mm.
 - Disponibile con barra LED da 20W

- Gypsolyte fitting for counter ceiling**
- Invisible fitting for counter ceilings
 - Once the counter ceiling is finished with smoothing plaster, the fitting is almost invisible and can be painted together with the ceiling
 - Installation hole mm 1250x130
 - Counter ceiling thickness 13mm.
 - Minimum depth: 100mm.
 - Available with 20W LED bar

- Einbaustrahler aus Gypsolyte für Unterdecken**
- Unsichtbare Einbaustrahler für Unterdecken
 - Sobald die Unterdecke durch Gips glatt gemacht ist, wird der Einbaustrahler fast unsichtbar und kann zusammen mit

- der Unterdecke gemalt werden
- Montageöffnung 1250x130 mm.
- Dicke der Unterdecke: 13mm.
- Min. Tiefe: 100mm.
- Verfügbar mit 20W Led-Streife

- Encastrable en Gypsolyte pour plafond**
- Encastrable invisible pour faux plafond
 - Après avoir lissé le faux-plafond, le boîtier encastrable devient partie intégrante du faux-plafond lui même et peut être peint
 - Ouverture dans le plafond pour l'installation: 1250x130 mm.
 - Épaisseur du faux plafond: 13mm.
 - Profondeur Min.: 100mm.
 - Disponible avec barre à LED de 20W

- Cazoleta para falso techo**
- Cazoleta para falso techo Gypsolyte
 - Cazoleta invisible para falsos techos
 - Una vez terminado el falso techo con yeso la carcasa es casi invisible y puede ser pintado junto con el techo
 - Medidas del orificio para la instalación 1250x130 mm.
 - Disponible con tira LED de 20W

ARAGON



Incassi Gypsolyte • Gypsolyte fixtures

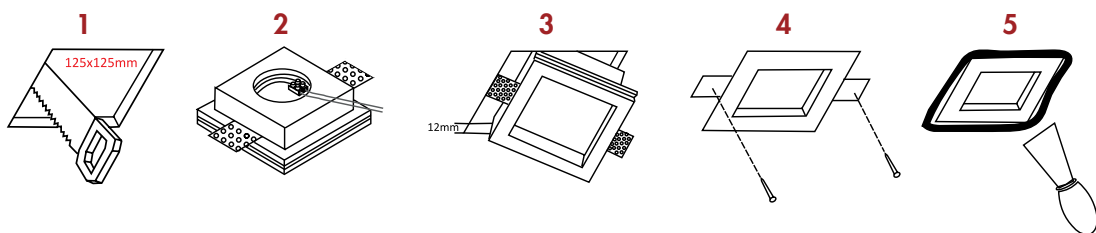

Type	Part n°	Dimensions mm	Standard	Colour	 mm	Packing box dimensions (mm)	Packing box (kg)
ARAGON Q1B	B9129G050Q1B	120x120x55h	MR16	White	125x125	170x170x110	0,64

Vedere pagina 138 per i kit che includono la lampadina LED - See page 138 for kits including LED lamp

Incasso in Gypsolyte per controsoffitti (per moduli LED)

- Incasso invisibile per controsoffitti
- Dopo aver rasato a gesso il controsoffitto, l'incasso risulta parte integrante del soffitto stesso e può essere tinteggiato
- Apertura per installazione 125x125 mm.
- Adatto a moduli LED standard MR16

Gypsolyte fitting for counter ceiling (for LED modules)

- Invisible fitting for counter ceilings
- Once the counter ceiling is finished with smoothing plaster, the fitting is almost invisible and can be painted together with the ceiling
- Installation hole mm 125x125
- Suitable for standard MR16 LED modules

Einbaustrahler aus Gypsolyte für Unterdecken (für Led-Modulen geeignet)

- Unsichtbare Einbaustrahler für Unterdecken
- Sobald die Unterdecke durch Gips glatt gemacht ist, wird der Einbaustrahler fast unsichtbar und kann zusammen mit der Unterdecke gemalt werden
- Montageöffnung 125x125 mm.
- Für Standard MR16 LED-Module geeignet

Encastrable en Gypsolyte pour plafond (pour modules à LED)

- Encastrable invisible pour faux plafond
- Après avoir lissé le faux-plafond, le boîtier encastrable devient partie intégrante du faux-plafond lui même et peut être peint
- Ouverture dans le plafond pour l'installation: 125x125 mm.
- Adapté aux modules LED MR16 standard

Cazoleta para falso techo (para módulos de LED) in Gypsolyte

- Cazoleta para falso techo Gypsolyte (para módulos de LED)
- Cazoleta invisible para falsos techos
- Una vez terminado el falso techo con yeso la carcasa es casi invisible y puede ser pintado junto con el techo
- Medidas del orificio para la instalación 125x125 mm.
- Apropiado para módulos estándar de LED MR16

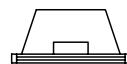

55

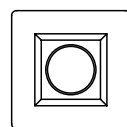

73 120



Optional Class II Gu10 lampholder
Part N°: BPORTGU1020N

—73—
120

ARAGON XL



Incassi Gypsolyte • Gypsolyte fixtures

ARAGON XL Incassi Gypsolyte • Gypsolyte fixtures

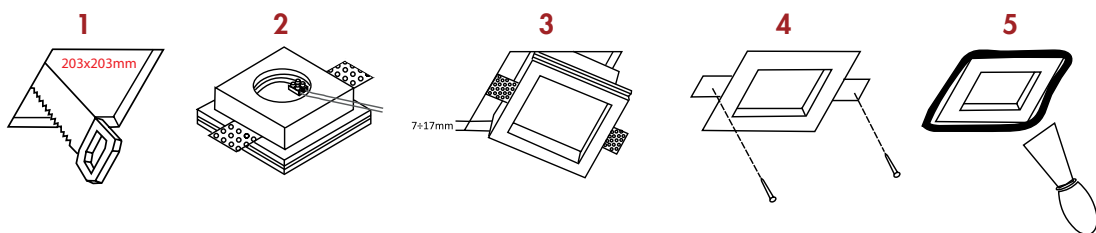
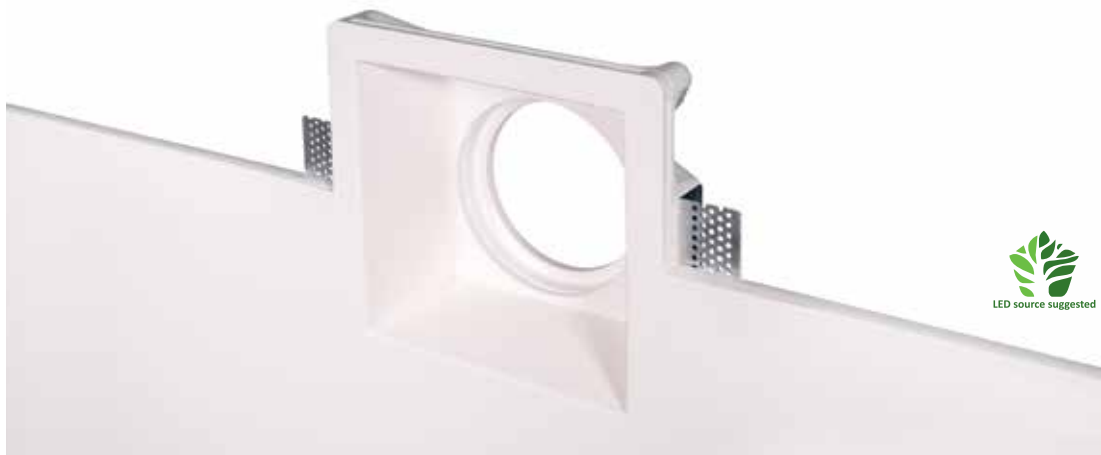

Type	Part n°	Dimensions mm	Standard	Colour	 mm	Packing box dimensions (mm)	Packing box (kg)
ARAGON XL Q1B	B9247G111Q1B	200x200x75h	AR111	White	203x203	250x270x130	1,80

Vedere pagina 138 per i kit che includono la lampadina LED - See page 138 for kits including LED lamp

Incasso in Gypsolyte per controsoffitti (per moduli LED)

- Incasso invisibile per controsoffitti
- Dopo aver rasato a gesso il controsoffitto, l'incasso risulta parte integrante del soffitto stesso e può essere tinteggiato
- Apertura per installazione 203x203 mm.
- Adatto a moduli LED standard AR111
- Spessore controsoffitto 9÷15mm.

Gypsolyte fitting for counter ceiling (for LED modules)

- Invisible fitting for counter ceilings
- Once the counter ceiling is finished with smoothing plaster, the fitting is almost invisible and can be painted together with the ceiling
- Installation hole mm 203x203
- Suitable for standard AR111 LED modules
- Counter ceiling thickness 9÷15mm.

Einbaustrahler aus Gypsolyte für Unterdecken (für Led-Modulen geeignet)

- Unsichtbare Einbaustrahler für Unterdecken
- Sobald die Unterdecke durch Gips glatt gemacht ist, wird der Einbaustrahler fast unsichtbar und kann zusammen mit der Unterdecke gemalt werden
- Montageöffnung 203x203mm.
- Für Standard AR111 LED-Module geeignet
- Dicke der Unterdecke: 9÷15mm.

Encastrable en Gypsolyte pour plafond (pour modules à LED)

- Encastrable invisible pour faux plafond

- Après avoir lissé le faux-plafond, le boîtier encastrable devient partie intégrante du faux-plafond lui même et peut être peint
- Ouverture dans le plafond pour l'installation: 203x203 mm.
- Adapté aux modules led AR111 standard
- Épaisseur du faux plafond: 9÷15mm.

Cazoleta para falso techo (para módulos de LED) in Gypsolyte

- Cazoleta para falso techo Gypsolyte (para módulos de led)
- Cazoleta invisible para falsos techos
- Una vez terminado el falso techo con yeso la carcasa es casi invisible y puede ser pintado junto con el techo
- Medidas del orificio para la instalación 203x203 mm
- Apropriado para módulos estándar de led AR111

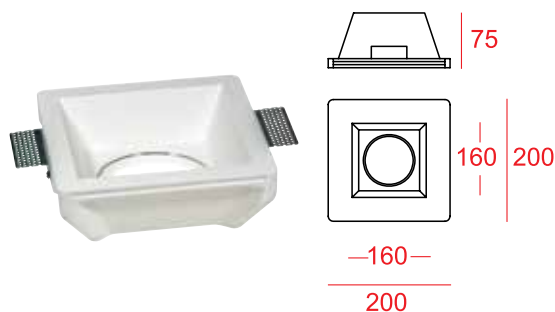

ARAGON GLASS



Incassi Gypsolyte • Gypsolyte fixtures

ARAGON GLASS Incassi Gypsolyte • Gypsolyte fixtures

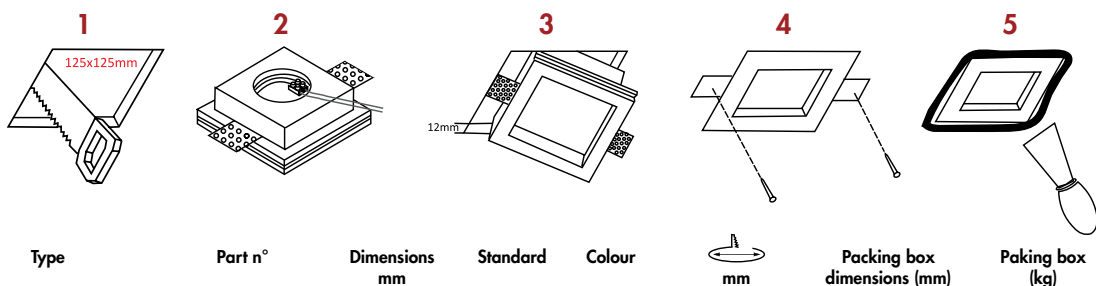

Type	Part n°	Dimensions mm	Standard	Colour	mm	Packing box dimensions (mm)	Packing box (kg)
ARAGON GLASS	B9128GV50Q1B	120x120x55h	MR16	White	125x125	170x170x110	0,64

Vedere pagina 138 per i kit che includono la lampadina LED - See page 138 for kits including LED lamp

Incasso in Gypsolyte per controsoffitti (per moduli LED)

- L'aggiunta di un vetro satinato permette di eliminare l'abbagliamento della fonte di luce
- Incasso invisibile per controsoffitti
- Dopo aver rasato a gesso il controsoffitto, l'incasso risulta parte integrante del soffitto stesso e può essere tinteggiato
- Apertura per installazione 125x125 mm.
- Adatto a moduli LED standard MR16

Gypsolyte fitting for counter ceiling (for LED modules)

- A frosted glass avoids dazzle
- Invisible fitting for counter ceilings
- Once the counter ceiling is finished with smoothing plaster, the fitting is almost invisible and can be painted together with the ceiling
- Installation hole mm 125x125
- Suitable for standard MR16 LED modules

Einbaustrahler aus Gypsolyte für Unterdecken (für Led-Modulen geeignet)

- Der Zusatz einer Milchglas macht es möglich, den Schein der Lichtquelle zu beseitigen
- Unsichtbare Einbaustrahler für Unterdecken
- Sobald die Unterdecke durch Gips glatt gemacht ist, wird der Einbaustrahler fast unsichtbar und kann zusammen mit der Unterdecke gemalt werden
- Montageöffnung 125x125 mm.
- Für Standard MR16 LED-Module geeignet

Encastrable en Gypsolyte pour plafond (pour modules à LED)

- L'ajout d'une vitre satinée permet d'éliminer l'éblouissement dû à la source de lumière

- Encastrable invisible pour faux plafond
- Après avoir lissé le faux-plafond, le boîtier encastrable devient partie intégrante du faux-plafond lui-même et peut être peint
- Ouverture dans le plafond pour l'installation: 125x125 mm.
- Adapté aux modules LED MR16 standard

Cazoleta para falso techo (para módulos de LED) in Gypsolyte

- Un cristal esmerilado evita los deslumbramientos
- Cazoleta para falso techo Gypsolyte (para módulos de LED)
- Cazoleta invisible para falsos techos
- Una vez terminado el falso techo con yeso la carcasa es casi invisible y puede ser pintado junto con el techo
- Medidas del orificio para la instalación 125x125 mm.
- Apropiado para módulos estándar de LED MR16

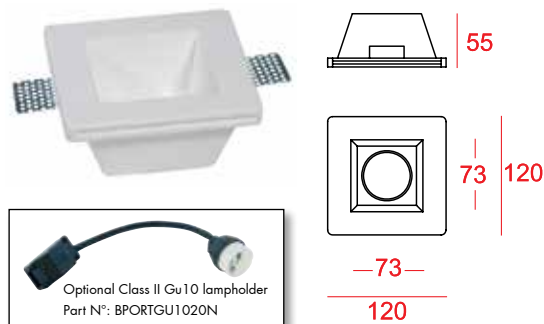

ARAGON FLAT



Incassi Gypsolyte • Gypsolyte fixtures

ARAGON FLAT Incassi Gypsolyte • Gypsolyte fixtures

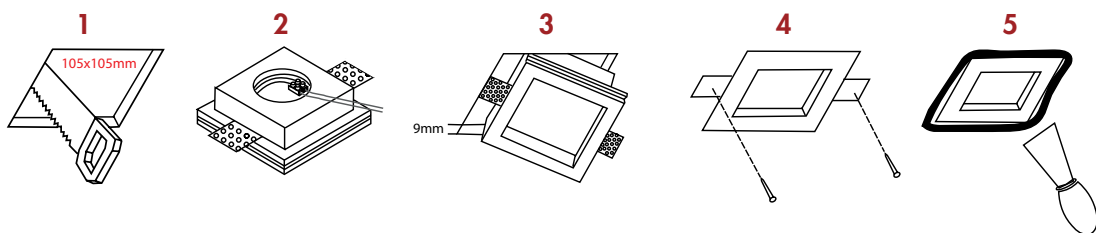

Type	Part n°	Dimensions mm	Standard	Colour	 mm	Packing box dimensions (mm)	Packing box (kg)
ARAGON FLAT Q1B	B9222G050Q1B	100x100x27h	MR16	White	105x105	150x150x80	0,40

Vedere pagina 138 per i kit che includono la lampadina LED - See page 138 for kits including LED lamp

Incasso in Gypsolyte per controsoffitti (per moduli LED)

- Incasso invisibile per controsoffitti
- Dopo aver rasato a gesso il controsoffitto, l'incasso risulta parte integrante del soffitto stesso e può essere tinteggiato
- Apertura per installazione 105x105 mm.
- Adatto a moduli LED standard MR16

Gypsolyte fitting for counter ceiling (for LED modules)

- Invisible fitting for counter ceilings
- Once the counter ceiling is finished with smoothing plaster, the fitting is almost invisible and can be painted together with the ceiling
- Installation hole mm 105x105
- Suitable for standard MR16 LED modules

Einbaustrahler aus Gypsolyte für Unterdecken (für Led-Modulen geeignet)

- Unsichtbare Einbaustrahler für Unterdecken
- Sobald die Unterdecke durch Gips glatt gemacht ist, wird der Einbaustrahler fast unsichtbar und kann zusammen mit der Unterdecke gemalt werden
- Montageöffnung 105x105 mm.
- Für Standard MR16 LED-Module geeignet

Encastrable en Gypsolyte pour plafond (pour modules à LED)

- Encastrable invisible pour faux plafond
- Après avoir lissé le faux-plafond, le boîtier encastrable devient partie intégrante du faux-plafond lui même et peut être peint

- Ouverture dans le plafond pour l'installation: 105x105 mm.
- Adapté aux modules LED MR16 standard

Cazoleta para falso techo (para módulos de LED) in Gypsolyte

- Cazoleta para falso techo Gypsolyte (para módulos de LED)
- Cazoleta invisible para falsos techos
- Una vez terminado el falso techo con yeso la carcasa es casi invisible y puede ser pintado junto con el techo
- Medidas del orificio para la instalación 105x105 mm.
- Apropiado para módulos estándar de LED MR16

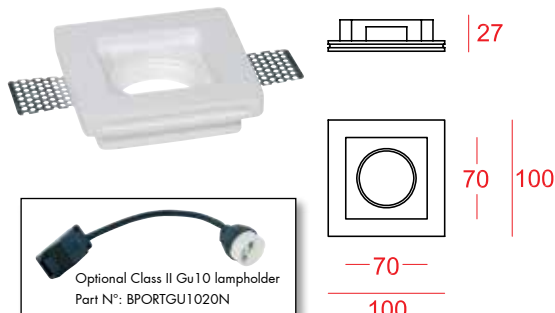

ARAGON TWIN



Incassi Gypsolyte • Gypsolyte fixtures

ARAGON TWIN Incassi Gypsolyte • Gypsolyte fixtures

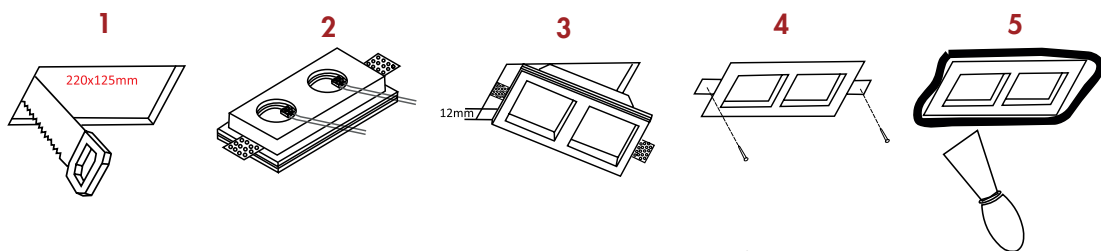

Type	Part n°	Dimensions mm	Standard	Colour	mm	Packing box dimensions (mm)	Packing box (kg)
ARAGON TWIN Q2B	B9223G050Q2B	215x120x55h	2x MR16	White	200x125	260x165x110	1,10

Vedere pagina 138 per i kit che includono la lampadina LED - See page 138 for kits including LED lamp

Incasso in Gypsolyte per controsoffitti (per moduli LED)

- Incasso invisibile per controsoffitti
- Dopo aver rasato a gesso il controsoffitto, l'incasso risulta parte integrante del soffitto stesso e può essere tinteggiato
- Apertura per installazione 220x125 mm.
- Adatto a moduli LED standard MR16

Gypsolyte fitting for counter ceiling (for LED modules)

- Invisible fitting for counter ceilings
- Once the counter ceiling is finished with smoothing plaster, the fitting is almost invisible and can be painted together with the ceiling
- Installation hole mm 220x125
- Suitable for standard MR16 LED modules

Einbaustrahler aus Gypsolyte für Unterdecken (für Led-Modulen geeignet)

- Unsichtbare Einbaustrahler für Unterdecken
- Sobald die Unterdecke durch Gips glatt gemacht ist, wird der Einbaustrahler fast unsichtbar und kann zusammen mit der Unterdecke gemalt werden
- Montageöffnung 220x125 mm.
- Für Standard MR16 LED-Module geeignet

Encastrable en Gypsolyte pour plafond (pour modules à LED)

- Encastrable invisible pour faux plafond
- Après avoir lissé le faux-plafond, le boîtier encastrable devient partie intégrante du faux-plafond lui même et peut être peint

- Ouverture dans le plafond pour l'installation: 220x125 mm.
- Adapté aux modules LED MR16 standard

Cazoleta para falso techo (para módulos de LED) in Gypsolyte

- Cazoleta para falso techo Gypsolyte (para módulos de LED)
- Cazoleta invisible para falsos techos
- Una vez terminado el falso techo con yeso la carcasa es casi invisible y puede ser pintado junto con el techo
- Medidas del orificio para la instalación 220x125 mm.
- Aproprioado para módulos estándar de LED MR16

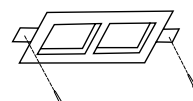
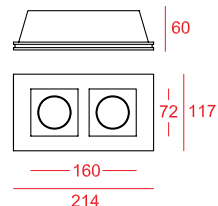

OBLÒ



Incassi Gypsolyte • Gypsolyte fixtures

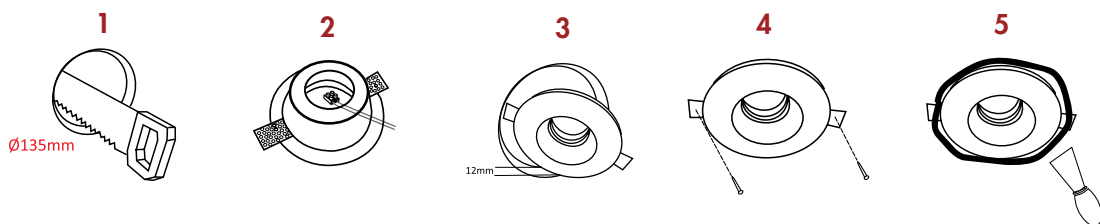

Type	Part n°	Dimensions mm	Standard	Colour	mm	Packing box dimensions (mm)	Packing box (kg)
OBLÒ T1B	B9130G050T1B	Ø130x45h	MR16	White	Ø135	170x170x110	0,57

Vedere pagina 138 per i kit che includono la lampadina LED - See page 138 for kits including LED lamp

🇮🇹 Incasso in Gypsolyte per controsoffitti (per moduli LED)

- Incasso invisibile per controsoffitti
- Dopo aver rasato a gesso il controsoffitto, l'incasso risulta parte integrante del soffitto stesso e può essere tinteggiato
- Apertura per installazione Ø135 mm.
- Adatto a moduli LED standard MR16

🇬🇧 Gypsolyte fitting for counter ceiling (for LED modules)

- Invisible fitting for counter ceilings
- Once the counter ceiling is finished with smoothing plaster, the fitting is almost invisible and can be painted together with the ceiling
- Installation hole mm Ø135
- Suitable for standard MR16 LED modules

🇩🇪 Einbaustrahler aus Gypsolyte für Unterdecken (für Led-Modulen geeignet)

- Unsichtbare Einbaustrahler für Unterdecken
- Sobald die Unterdecke durch Gips glatt gemacht ist, wird der Einbaustrahler fast unsichtbar und kann zusammen mit der Unterdecke gemalt werden
- Montageöffnung Ø135 mm.
- Für Standard MR16 LED-Module geeignet

🇫🇷 Encastrable en Gypsolyte pour plafond (pour modules à LED)

- Encastrable invisible pour faux plafond
- Après avoir lissé le faux-plafond, le boîtier encastrable devient partie intégrante du faux-plafond lui même et peut être peint

- Ouverture dans le plafond pour l'installation: Ø135 mm.
- Adapté aux modules LED MR16 standard

🇪🇸 Cazoleta para falso techo (para módulos de LED) in Gypsolyte

- Cazoleta para falso techo Gypsolyte (para módulos de LED)
- Cazoleta invisible para falsos techos
- Una vez terminado el falso techo con yeso la carcasa es casi invisible y puede ser pintado junto con el techo
- Medidas del orificio para la instalación Ø135 mm.
- Apropiado para módulos estándar de LED MR16

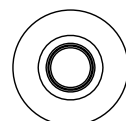

- Ø73 -
Ø130

OBLÒ XL



Incassi Gypsolyte • Gypsolyte fixtures

OBLÒ XL Incassi Gypsolyte • Gypsolyte fixtures

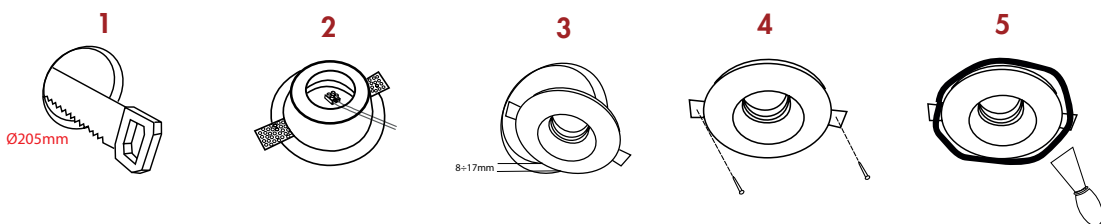

Type	Part n°	Dimensions mm	Standard	Colour	mm	Packing box dimensions (mm)	Packing box (kg)
OBLÒ XL T1B	B9248G111T1B	Ø200x75h	AR111	White	Ø205	250x270x130	1,40

Vedere pagina 138 per i kit che includono la lampadina LED - See page 138 for kits including LED lamp

Incasso in Gypsolyte per controsoffitti (per moduli LED)

- Incasso invisibile per controsoffitti
- Dopo aver rasato a gesso il controsoffitto, l'incasso risulta parte integrante del soffitto stesso e può essere tinteggiato
- Apertura per installazione Ø 205 mm.
- Adatto a moduli LED standard AR111

Gypsolyte fitting for counter ceiling (for LED modules)

- Invisible fitting for counter ceilings
- Once the counter ceiling is finished with smoothing plaster, the fitting is almost invisible and can be painted together with the ceiling
- Installation hole mm Ø 205 mm.
- Suitable for standard AR111 LED modules

Einbaustrahler aus Gypsolyte für Unterdecken (für Led-Modulen geeignet)

- Unsichtbare Einbaustrahler für Unterdecken
- Sobald die Unterdecke durch Gips glatt gemacht ist, wird der Einbaustrahler fast unsichtbar und kann zusammen mit der Unterdecke gemalt werden
- Montageöffnung Ø 205 mm.
- Für Standard AR111 LED-Module geeignet

Encastrable en Gypsolyte pour plafond (pour modules à LED)

- Encastrable invisible pour faux plafond
- Après avoir lissé le faux-plafond, le boîtier encastrable devient

- partie intégrante du faux-plafond lui même et peut être peint
- Ouverture dans le plafond pour l'installation: Ø205 mm.
- Adapté aux modules led AR111 standard.

Cazoleta para falso techo (para módulos de LED) in Gypsolyte

- Cazoleta para falso techo Gypsolyte (para módulos de led)
- Cazoleta invisible para falsos techos
- Una vez terminado el falso techo con yeso la carcasa es casi invisible y puede ser pintado junto con el techo
- Medidas del orificio para la instalación Ø 205 mm.
- Apropriado para módulos estándar de led AR111.

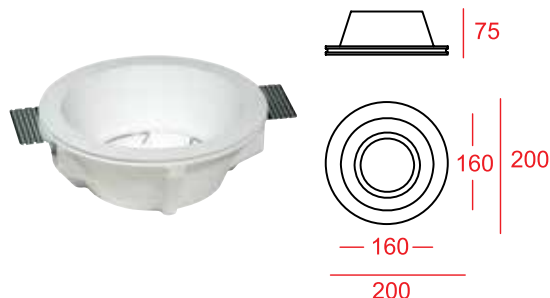

OBLÒ FLAT



Incassi Gypsolyte • Gypsolyte fixtures

OBLÒ FLAT Incassi Gypsolyte • Gypsolyte fixtures

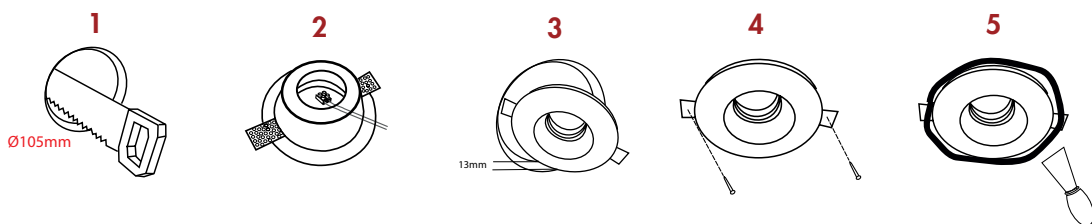

Type	Part n°	Dimensions mm	Standard	Colour	mm	Packing box dimensions (mm)	Packing box (kg)
OBLÒ FLAT T1B	B9224G050T1B	Ø100x27h	MR16	White	Ø105	150x150x80	0,26

Vedere pagina 138 per i kit che includono la lampadina LED - See page 138 for kits including LED lamp

Incasso in Gypsolyte per controsoffitti (per moduli LED)

- Incasso invisibile per controsoffitti
- Dopo aver rasato a gesso il controsoffitto, l'incasso risulta parte integrante del soffitto stesso e può essere tinteggiato
- Apertura per installazione Ø105 mm.
- Adatto a moduli LED standard MR16

Gypsolyte fitting for counter ceiling (for LED modules)

- Invisible fitting for counter ceilings
- Once the counter ceiling is finished with smoothing plaster, the fitting is almost invisible and can be painted together with the ceiling
- Installation hole mm Ø105
- Suitable for standard MR16 LED modules

Einbaustrahler aus Gypsolyte für Unterdecken (für Led-Modulen geeignet)

- Unsichtbare Einbaustrahler für Unterdecken
- Sobald die Unterdecke durch Gips glatt gemacht ist, wird der Einbaustrahler fast unsichtbar und kann zusammen mit der Unterdecke gemalt werden
- Montageöffnung Ø105 mm.
- Für Standard MR16 LED-Module geeignet

Encastrable en Gypsolyte pour plafond (pour modules à LED)

- Encastrable invisible pour faux plafond
- Après avoir lissé le faux-plafond, le boîtier encastrable devient partie intégrante du faux-plafond lui même et peut être peint

- Ouverture dans le plafond pour l'installation: Ø105 mm.
- Adapté aux modules LED MR16 standard

Cazoleta para falso techo (para módulos de LED) in Gypsolyte

- Cazoleta para falso techo Gypsolyte (para módulos de LED)
- Cazoleta invisible para falsos techos
- Una vez terminado el falso techo con yeso la carcasa es casi invisible y puede ser pintado junto con el techo
- Medidas del orificio para la instalación Ø105 mm.
- Apropiado para módulos estándar de LED MR16

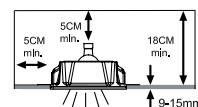
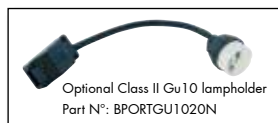



SLIDE

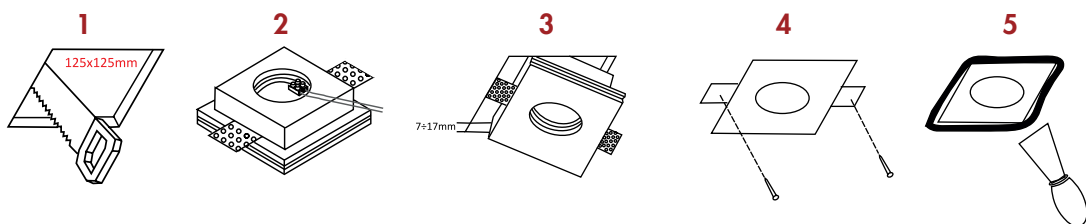
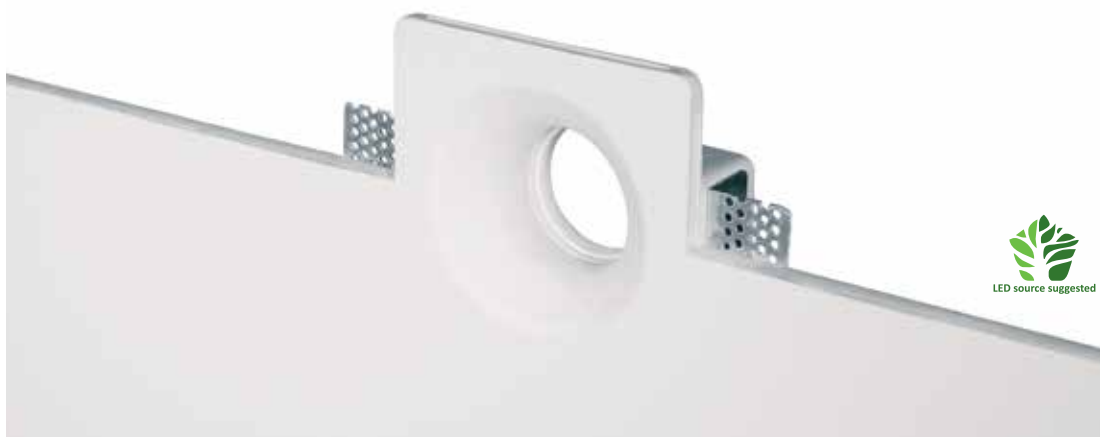

Incassi Gypsolyte • Gypsolyte fixtures

SLIDE Incassi Gypsolyte • Gypsolyte fixtures



Type	Part n°	Dimensions mm	Standard	Colour	 mm	Packing box dimensions (mm)	Packing box (kg)
SLIDE Q1B	B9131G050Q1B	120x120x40h	MR16	White	125x125	170x170x110	0,52

Vedere pagina 138 per i kit che includono la lampadina LED - See page 138 for kits including LED lamp

Incasso in Gypsolyte per controsoffitti (per moduli LED)

- Incasso invisibile per controsoffitti
- Dopo aver rasato a gesso il controsoffitto, l'incasso risulta parte integrante del soffitto stesso e può essere tinteggiato
- Apertura per installazione 125x125 mm.
- Adatto a moduli LED standard MR16

Gypsolyte fitting for counter ceiling (for LED modules)

- Invisible fitting for counter ceilings
- Once the counter ceiling is finished with smoothing plaster, the fitting is almost invisible and can be painted together with the ceiling
- Installation hole mm 125x125
- Suitable for standard MR16 LED modules

Einbaustrahler aus Gypsolyte für Unterdecken (für Led-Module geeignet)

- Unsichtbare Einbaustrahler für Unterdecken
- Sobald die Unterdecke durch Gips glatt gemacht ist, wird der Einbaustrahler fast unsichtbar und kann zusammen mit der Unterdecke gemalt werden
- Montageöffnung 125x125 mm.
- Für Standard MR16 LED-Module geeignet

Encastrable en Gypsolyte pour plafond (pour modules à LED)

- Encastrable invisible pour faux plafond
- Après avoir lissé le faux-plafond, le boîtier encastrable devient partie intégrante du faux-plafond lui même et peut être peint
- Ouverture dans le plafond pour l'installation: 125x125 mm.
- Adapté aux modules LED MR16 standard

Cazoleta para falso techo (para módulos de LED) in Gypsolyte

- Cazoleta para falso techo Gypsolyte (para módulos de LED)
- Cazoleta invisible para falsos techos
- Una vez terminado el falso techo con yeso la carcasa es casi invisible y puede ser pintado junto con el techo
- Medidas del orificio para la instalación 125x125 mm.
- Apropiado para módulos estándar de LED MR16

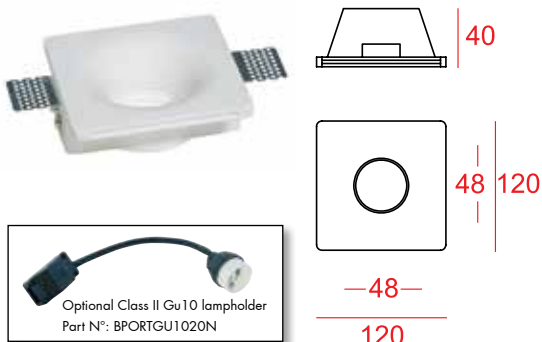

DIAGONAL



Incassi Gypsolyte • Gypsolyte fixtures

DIAGONAL Incassi Gypsolyte • Gypsolyte fixtures

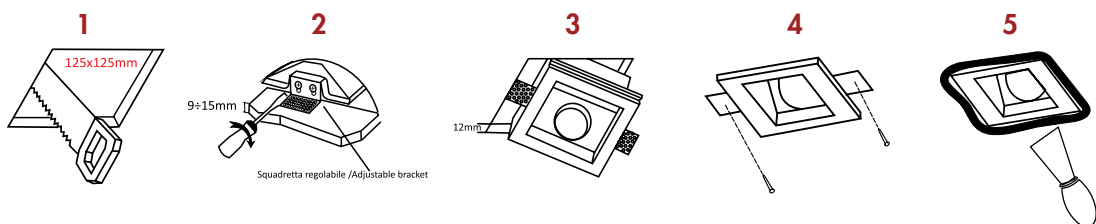

Type	Part n°	Dimensions mm	Standard	Colour	 mm	Packing box dimensions (mm)	Packing box (kg)
DIAGONAL Q1B	B9229G050Q1B	120x120x65h	MR16	White	125x125	170x170x110	0,75

Vedere pagina 138 per i kit che includono la lampadina LED - See page 138 for kits including LED lamp

Incasso in Gypsolyte per controsoffitti (per moduli LED)

- Incasso invisibile per controsoffitti
- Dopo aver rasato a gesso il controsoffitto, l'incasso risulta parte integrante del soffitto stesso e può essere tinteggiato
- Apertura per installazione 125x125 mm.
- Adatto a moduli LED standard MR16
- Spessore controsoffitto 9÷15mm - Profondità minima: 130 mm.

Gypsolyte fitting for counter ceiling (for LED modules)

- Invisible fitting for counter ceilings
- Once the counter ceiling is finished with smoothing plaster, the fitting is almost invisible and can be painted together with the ceiling
- Installation hole mm 125x125
- Suitable for standard MR16 LED modules
- Counter ceiling thickness 9÷15mm - Minimum depth: 130mm.

Einbaustrahler aus Gypsolyte für Unterdecken (für Led-Modulen geeignet)

- Unsichtbare Einbaustrahler für Unterdecken
- Sobald die Unterdecke durch Gips glatt gemacht ist, wird der Einbaustrahler fast unsichtbar und kann zusammen mit der Unterdecke gemalt werden
- Montageöffnung 125x125 mm.
- Für Standard MR16 LED-Module geeignet
- Dicke der Unterdecke: 9÷15mm - Min. Tiefe: 130mm.

Encastrable en Gypsolyte pour plafond (pour modules à LED)

- Encastrable invisible pour faux plafond
- Après avoir lissé le faux-plafond, le boîtier encastrable devient

- partie intégrante du faux-plafond lui même et peut être peint
- Ouverture dans le plafond pour l'installation: 125x125 mm.
- Adapté aux modules LED MR16 standard
- Épaisseur du faux plafond: 9÷15mm - Profondeur Min.: 130mm.

Cazoleta para falso techo (para módulos de LED) in Gypsolyte

- Cazoleta para falso techo Gypsolyte (para módulos de LED)
- Cazoleta invisible para falsos techos
- Una vez terminado el falso techo con yeso la carcasa es casi invisible y puede ser pintado junto con el techo
- Medidas del orificio para la instalación 125x125 mm.
- Apropiado para módulos estándar de LED MR16



FLARE



Incassi Gypsolyte • Gypsolyte fixtures

FLARE Incassi Gypsolyte • Gypsolyte fixtures



Type	Part n°	Dimensions mm	Standard	Colour	mm	Packing box dimensions (mm)	Packing box (kg)
FLARE SMALL	B9431G030Q1B	180x120x55h	Ø 30mm	White	125x185	230x170x100h	1,05
FLARE MEDIUM	B3013G050Q1B	250x210x76h	MR16	White	215x255	310x260x140h	2,65
FLARE LARGE	B3014G050Q1B	330x290x76h	MR16	White	290x330	410x335x140h	3,10

Vedere pagina 138 per i kit che includono la lampadina LED - See page 138 for kits including LED lamp

Incasso in Gypsolyte per pareti (per moduli LED)

- Incasso invisibile per pareti
- Dopo aver rasato a gesso l'incasso risulta parte integrante della parete stessa e può essere tinteggiato
- Adatto a moduli LED standard MR16 (Medium e Large), MR8 (Small) Ø 30mm

Gypsolyte fitting for walls (for LED modules)

- Invisible fitting for walls
- Once the wall is finished with smoothing plaster, the fitting is almost invisible and can be painted together with the wall
- Suitable for standard MR16 LED modules (Medium and Large), MR8 (Small) Ø 30mm

Einbaustrahler aus Gypsolyte für Wandeinsatz (für Led-Modulen geeignet)

- Unsichtbare Einbaustrahler für Wandeinsatz
- Sobald die Wand durch Gips glatt gemacht ist, wird der Einbaustrahler fast unsichtbar und kann zusammen mit der Wand gemalt werden
- Für Standard MR16 LED-Module geeignet (Medium und Large), MR8 (Small) Ø 30mm

Encastrable en Gypsolyte au mur (pour modules à LED)

- Encastrable invisible au mur
- Après avoir lissé les murs, le boîtier encastrable devient partie intégrante du mêmes et peut être peint
- Adapté aux modules led MR16 standard (Medium et Large), MR8 (Small) Ø 30mm

Cazoleta para pared (para módulos de LED) in Gypsolyte

- Cazoleta invisible para pared Gypsolyte (para módulos de led)
- Una vez terminada la pared con yeso la carcasa es casi invisible y puede ser pintado junto con la pared
- Aproprioado para módulos estándar de led MR16 (Medium y Large), MR8 (Small) Ø 30mm

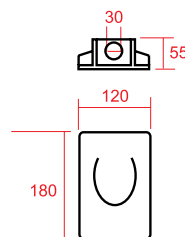
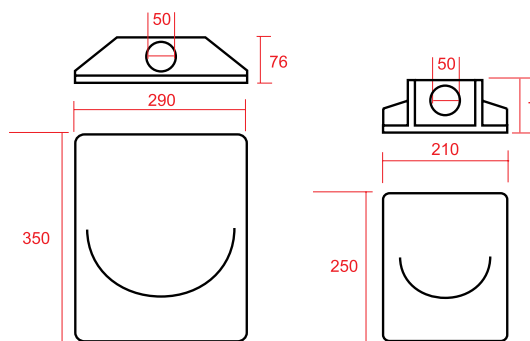



WIZ System

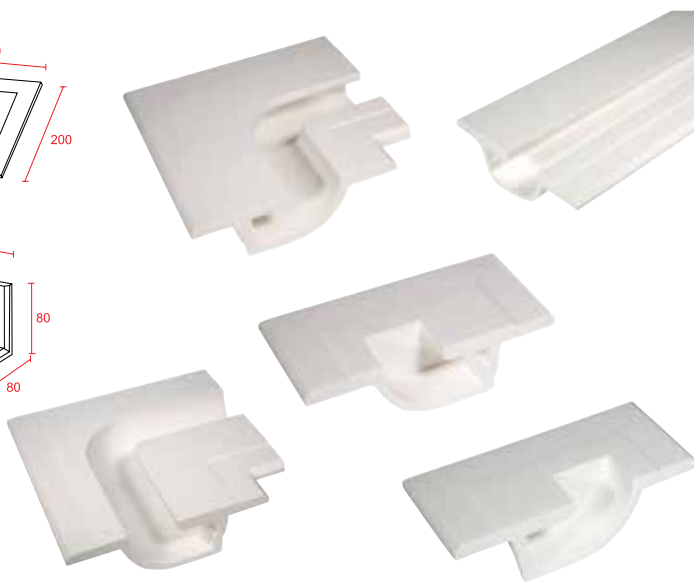
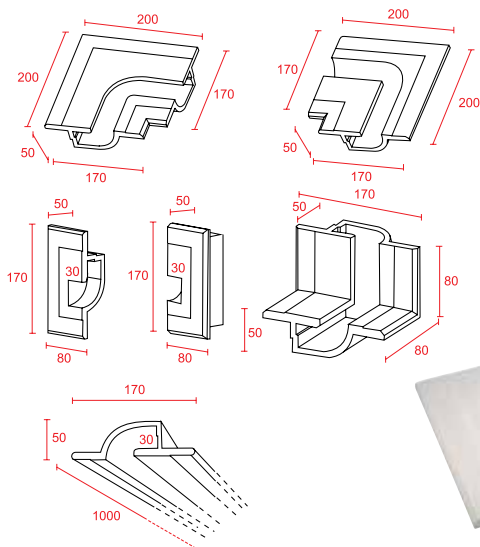

Incassi Gypsolyte • Gypsolyte fixtures

WIZ System Incassi Gypsolyte • Gypsolyte fixtures



Type	Part n°		Dimensions mm	Colour	 mm	Packing box dim. (mm)	Packing box (kg)
WIZ System LINE	B9703WIZ100B	Modular system cm 100	170x1000x50	White	170x1000	250x125x120	3,90
WIZ System Corner A	B9703WIZCARB	Modular system Corner A RIGHT	200x200x50	White	200x200	250x250x12	1,00
WIZ System Corner B	B9703WIZCBLB	Modular system Corner B LEFT	200x200x50	White	200x200	250x250x12	1,00
WIZ System Corner Z	B9703WIZCAZB	Modular system Corner Z 90°	170x130x50	White	70x80x2	250x250x12	1,00
WIZ System Caps	B9703WIZCABP	Modular system Caps TWIN	170x80x50	White	170x80	250x250x10	0,65

Sistema modulare WIZ

- Sistema modulare invisibile per contro pareti e controsoffitti
- Permette la creazione di tagli con luce indiretta
- Specifico per l'applicazione di strisce LED adesive
- Facilmente componibile composto da sezioni diritte, curve e angolari
- Permette una illimitata possibilità di esecuzioni

Modular System WIZ

- Invisible modular system for drywall and counter ceilings
- Once the counter wall/ceiling is finished with smoothing plaster, the fitting is almost invisible and can be painted with the same color of wall/ceiling

Modularsystem WIZ

- Unsichtbar Modularsystem für Unterwänden und Unterdecken
- Nachdem die Unterdecke durch Gips glatt gemacht ist, wird das System Teil der Wänden selbst und kann gemalt werden
- Lichtschnitten mit indirektem Licht
- Spezifisch für Anwendungen mit Led Streifen (separat verkauft)
- Bestehend aus geraden, gebogenen und eckigen Teilen
- Vielfachen Anwendungen möglich

Système modulaire WIZ

- Système modulaire invisible pour contre-parois et faux-plafonds
- Après avoir lissé le faux-plafond, le système fait partie intégrante de la paroi elle-même et peut être peint
- Permet la création de coupes de lumière avec des lumières indirectes
- Spécifique pour l'application de rubans led adhésifs vendus séparément
- Composé de sections droites, incurvée et angulaires
- Possibilité illimitée d'exécutions

Sistema modular WIZ

- Sistema modular invisible para paredes de PLY

- (Placa de Yeso Laminado) y techos falsos
- Una vez que a la pared o techo se le da un acabado enlucido con yeso, el accesorio es prácticamente invisible y puede ser pintado del mismo color
- Permite efectos de iluminación indirecta
- Especifico para la instalación en su interior de tiras LED adhesivas (las tiras LED se venden por separado)
- Existen módulos rectos, en curva, angulares y tapas finales
- Permite un número de composiciones ilimitado



WIZ System

Beyond light



NEOS



Strutture Gypsolyte • Gypsolyte fixtures

NEOS Strutture Gypsolyte • Gypsolyte fixtures



Type	Part n°	Dimensions mm	Standard	Colour	Packing box dimensions (mm)	Packing box (kg)
NEOS SMALL	B9262G050Q1B	71x71x90h	MR16	White	120x120x135h	0,47
NEOS MEDIUM	B9263G050Q1B	71x71x129h	MR16	White	120x120x180h	0,64
NEOS LARGE	B9264G050Q1B	71x71x169h	MR16	White	120x120x210h	0,84

Vedere pagina 138 per i kit che includono la lampadina LED - See page 138 for kits including LED lamp

Alloggiamento da soffitto in Gypsolyte

- Struttura in Gypsolyte
- Adatto a moduli LED standard MR16
- Installazione a soffitto

Gypsolyte fixture for ceiling

- Structure in Gypsolyte
- Suitable for standard MR16 LED modules
- To be installed on ceiling

Deckeneinbau aus Gypsolyte

- Körper aus Gypsolyte
- Für Standard MR16 LED
- Module geeignet- Deckeneinsatz

Structure pour plafond en Gypsolyte

- Corps en Gypsolyte
- Adapté aux modules LED MR16 standard
- Installation au plafond

Estructura para techo

- Estructura de Gypsolyte
- Apropriado para módulos estandar LED MR16
- Instalacion para techo

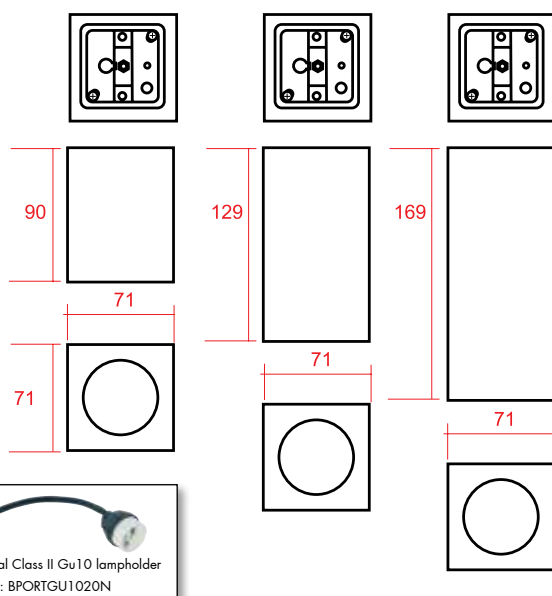

ARGO



Strutture Gypsolyte • Gypsolyte fixtures

ARGO Strutture Gypsolyte • Gypsolyte fixtures



Type	Part n°	Dimensions mm	Standard	Colour	Packing box dimensions (mm)	Packing box (kg)
ARGO SMALL	B9268G050T1B	Ø70x90h	MR16	White	120x120x135h	0,46
ARGO MEDIUM	B9269G050T1B	Ø70x130h	MR16	White	120x120x180h	0,61
ARGO LARGE	B9270G050T1B	Ø70x170h	MR16	White	120x120x210h	0,76

Vedere pagina 138 per i kit che includono la lampadina LED - See page 138 for kits including LED lamp

Alloggiamento da soffitto in Gypsolyte

- Struttura in Gypsolyte
- Adatto a moduli LED standard MR16
- Installazione a soffitto

Gypsolyte fixture for ceiling

- Structure in Gypsolyte
- Suitable for standard MR16 LED modules
- To be installed on ceiling

Deckeneinbau aus Gypsolyte

- Körper aus Gypsolyte
- Für Standard MR16 LED
- Module geeignet- Deckeneinsatz

Structure pour plafond en Gypsolyte

- Corps en Gypsolyte
- Adapté aux modules LED MR16 standard
- Installation au plafond

Estructura para techo

- Estructura de Gypsolyte
- Apropriado para módulos estandar LED MR16
- Instalacion para techo

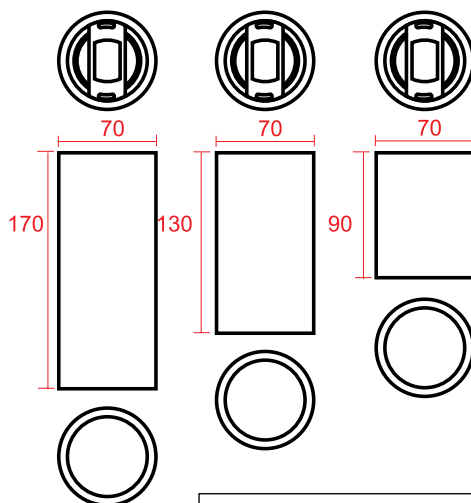

CUBE



Strutture Gypsolyte • Gypsolyte fixtures



Type	Part n°	Dimensions mm	Standard	Colour	Packing box dimensions (mm)	Packing box (kg)
CUBE	B9259G111Q1B	190x190x220h	AR111	White	290x245x250h	5,10

Vedere pagina 138 per i kit che includono la lampadina LED - See page 138 for kits including LED lamp

Alloggiamento da soffitto in Gypsolyte

- Struttura in Gypsolyte
- Adatto a moduli LED standard AR111
- Installazione a soffitto

Gypsolyte fixture for ceiling

- Structure in Gypsolyte
- Suitable for standard AR111 LED modules
- To be installed on ceiling

Deckeneinbau aus Gypsolyte

- Körper aus Gypsolyte
- Für Standard AR111 LED
- Module geeignet- Deckeneinsatz

Structure pour plafond en Gypsolyte

- Corps en Gypsolyte
- Adapté aux modules LED AR111 standard
- Installation au plafond

Estructura para techo

- Estructura de Gypsolyte
- Apropriado para módulos estandar LED AR111
- Instalacion para techo

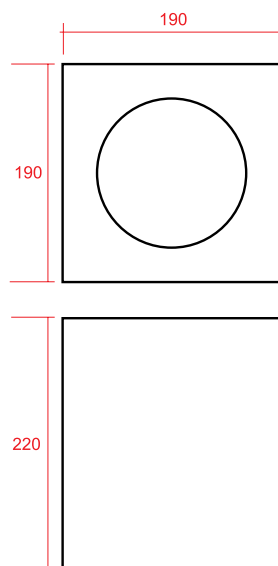

PIPE



Strutture Gypsolyte • Gypsolyte fixtures

PIPE Strutture Gypsolyte • Gypsolyte fixtures



Type	Part n°	Dimensions mm	Standard	Colour	Packing box dimensions (mm)	Packing box (kg)
PIPE Round	B8444G050T2B	98x74x249h	2x MR16	White	290x150x120h	1,20
PIPE Square	B8443G050Q2B	98x74x249h	2x MR16	White	290x150x120h	1,20

Vedere pagina 138 per i kit che includono la lampadina LED - See page 138 for kits including LED lamp

Applique in Gypsolyte

- Struttura in Gypsolyte
- Adatto a moduli LED standard MR16
- Installazione a parete

Gypsolyte wall fixture

- Structure in Gypsolyte
- Suitable for standard MR16 LED modules
- To be installed on wall

Wandleuchte aus Gypsolyte

- Körper aus Gypsolyte
- Für Standard MR16 LED
- Module geeignet
- Wandeeinsatz

Applique en Gypsolyte

- Corps en Gypsolyte
- Adapté aux modules LED MR16 standard
- Installation au mur

Estructura para pared en Gypsolyte

- Estructura de Gypsolyte
- Apropriada para módulos estandar LED MR16
- Instalacion para pared

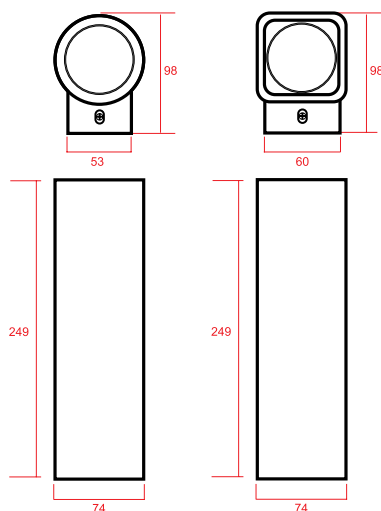

ARIEL & PEGASUS



Strutture Gypsolyte • Gypsolyte fixtures

ARIEL & PEGASUS Strutture Gypsolyte • Gypsolyte fixtures



Type	Part n°	Dimensions mm	Standard	Colour	Packing box dimensions (mm)	Packing box (kg)
ARIEL	B2308G050Q1B	70x70x250h	MR16	White	300x180x130h	1,80
PEGASUS	B2309G050T1B	∅70x250h	MR16	White	300x180x130h	1,30

Vedere pagina 138 per i kit che includono la lampadina LED - See page 138 for kits including LED lamp

Sospensione in Gypsolyte

- Struttura in Gypsolyte
- Adatto a moduli LED standard MR16
- Installazione a plafone

Gypsolyte pendant fixture

- Structure in Gypsolyte
- Suitable for standard MR16 LED modules
- Ceiling installation (pendant)

Hängeleuchte aus Gypsolyte

- Körper aus Gypsolyte
- Für Standard MR16 LED-Module geeignet
- Deckeneinsatz

Suspension en Gypsolyte

- Corps en Gypsolyte
- Adapté aux modules LED MR16 standard
- Installation au plafond

Suspensión en Gypsolyte

- Estructura de Gypsolyte
- Apropriado para módulos estandar LED MR16
- Instalacion para techo

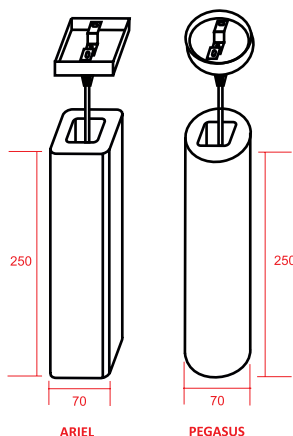

MAYA



Incassi Alluminio • Aluminium fixtures



Type	Part N°	Dimensions (mm)	Standard	Colour	 (mm)	Packing box dimensions (mm)	Packing box weight (kg)
MAYA T1A	B10221050T1A	Ø93	MR16	Aluminium	80	100x100x50h	0,16
MAYA T1N	B10231050T1N	Ø93	MR16	Black	80	100x100x50h	0,16
MAYA T1B	B10221050T1B	Ø93	MR16	White	80	100x100x50h	0,16

 **Faretti per incasso in Alluminio (per Moduli LED)**

- Corpo in alluminio
- Orientabile
- Adatto per moduli led QLT serie: TR16, Q-LAMP H1, H2, H3, H5, Spotty
- Per utilizzo in controsoffitti, fissaggio con molle

 **Recessed Aluminium light fixtures (for LED Modules)**

- Aluminium body
- Adjustable
- Suitable for QLT led modules series: TR16, Q-LAMP H1, H2, H3, H5, Spotty
- To be used in counter ceilings

 **Aluminium-Einbaustrahler (für LED-Module)**

- Aluminiumkörper
- Schwenkbar
- Geeignet für QLT LED-Module Type: TR16, Q-LAMP H1, H2, H3, H5, Spotty
- Einsatz in Hängedecken, Befestigung durch Sprengringen

 **Spots encastrables en Aluminium (pour platine LED)**

- Corps en aluminium
- Orientable
- Adapté aux platines à LED de QLT type: TR16, Q-LAMP H1, H2, H3, H5, Spotty
- Pour utilisation en faux-plafond, fixation avec ressorts

 **Focos empotrables de Aluminio (para Módulos de LED)**

- Cuerpo de aluminio
- Ajustable
- Adecuado para los módulos de leds de QLT de la serie: TR16, Q-LAMP H1, H2, H3, H5, Spotty
- Para ser utilizado en techo

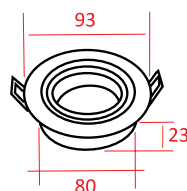

- A richiesta
 - On request
 - Auf Anfrage
 - Sur Demande
 - Bajo pedido
- ZTLA0B001000

CROWN



Incassi Alluminio • Aluminium fixtures



Type	Part N°	Dimensions (mm)	Standard	Colour	 (mm)	Packing box dimensions (mm)	Packing box weight (kg)
CROWN T1A	B12906050T1A	Ø128	MR16	Aluminium	Ø105	170x140x85h	0,20
CROWN T1B	B12906050T1B	Ø128	MR16	White	Ø105	170x140x85h	0,20

 **Faretti per incasso in Alluminio (per Moduli LED)**

- Corpo in alluminio
- Fonte luminosa arretrata anti-abbagliamento
- Adatto per moduli led QLT serie: TR16, Q-LAMP H1, H2, H3, H5, Spotty
- Per utilizzo in controsoffitti, fissaggio con molle

 **Recessed Aluminium light fixtures (for LED Modules)**

- Aluminum body
- Recessed light source - No dazzle
- Suitable for QLT led modules series: TR16, Q-LAMP H1, H2, H3, H5, Spotty
- To be used in counter ceilings

 **Aluminium-Einbaustrahler (für LED-Module)**

- Aluminiumkörper
- Einbaulichtequelle - Keine Blendung
- Geeignet für QLT LED-Module Type: TR16, Q-LAMP H1, H2, H3, H5, Spotty
- Einsatz in Hängedecken, Befestigung durch Sprengingen

 **Spots encastrables en Aluminium (pour platine LED)**

- Corps en aluminium
- Source lumineuse en retrait - Anti-éblouissement
- Adapté aux platines à LED de QLT type: TR16, Q-LAMP H1, H2, H3, H5, Spotty
- Pour utilisation en faux-plafond, fixation avec ressorts

 **Focos empotrables de Aluminio (para Módulos de LED)**

- Cuerpo de aluminio
- Foco empotrable - No deslumbra
- Adecuado para los módulos de leds de QLT de la serie: TR16, Q-LAMP H1, H2, H3, H5, Spotty
- Para ser utilizado en techo

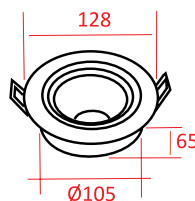

BABEL



Incassi Alluminio • Aluminium fixtures

BABEL Incassi Alluminio • Aluminium Fixtures



Type	Part N°	Dimensions (mm)	Standard	Colour	 (mm)	Packing box dimensions (mm)	Packing box weight (kg)
BABEL Q1A	B10421050Q1A	93x93x23h	MR16	Aluminium	Ø80	115x100x45h	0,16
BABEL Q2A	B18293050Q2A	175x90x23h	MR16	Aluminium	160x80	185x160x45h	0,34
BABEL Q1N	B10423050Q1N	93x93x23h	MR16	Black	Ø80	115x100x45h	0,16
BABEL Q2N	B11824050Q2N	175x90x23h	MR16	Black	160x80	185x160x45h	0,34
BABEL Q1B	B10421050Q1B	93x93x23h	MR16	White	Ø80	115x100x45h	0,16
BABEL Q2B	B18293050Q2B	175x90x23h	MR16	White	160x80	185x160x45h	0,34

Faretto per incasso in Alluminio (per Moduli LED)

- Corpo in alluminio
- Orientabile
- Adatto per moduli led QLT serie: TR16, Q-LAMP H1, H2, H3, H5, Spotty
- Per utilizzo in controsoffitti, fissaggio con molle

Recessed Aluminium light fixtures (for LED Modules)

- Aluminium body
- Adjustable
- Suitable for QLT led modules series: TR16, Q-LAMP H1, H2, H3, H5, Spotty
- To be used in counter ceilings



Aluminium-Einbaustrahler (für LED-Module)

- Aluminiumkörper
- Schwenkbar
- Geeignet für QLT LED-Module Type: TR16, Q-LAMP H1, H2, H3, H5, Spotty
- Einsatz in Hängedecken, Befestigung durch Sprengringen

Spots encastrables en Aluminium (pour platine LED)

- Corps en aluminium
- Orientable
- Adapté aux platines à LED de QLT type: TR16, Q-LAMP H1, H2, H3, H5, Spotty
- Pour utilisation en faux-plafond, fixation avec ressorts

Focos empotrables de Aluminio (para Módulos de LED)

- Cuerpo de aluminio
- Ajustable
- Adecuado para los módulos de leds de QLT de la serie: TR16, Q-LAMP H1, H2, H3, H5, Spotty
- Para ser utilizado en techo

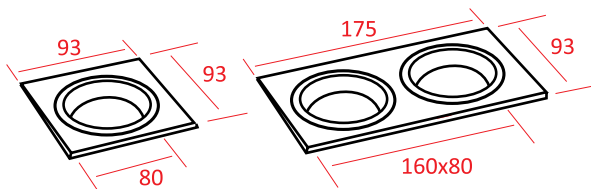

DOME

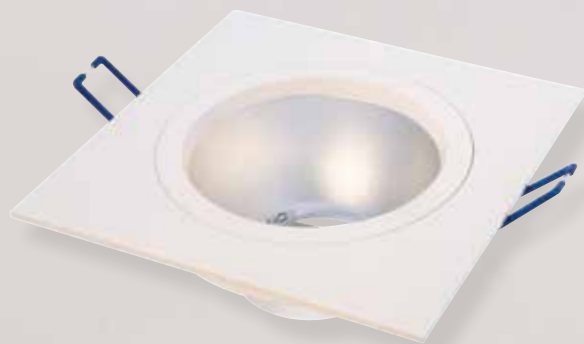

Incassi Alluminio • Aluminium fixtures

DOME Incassi Alluminio • Aluminium Fixtures



Type	Part N°	Dimensions (mm)	Standard	Colour	 (mm)	Packing box dimensions (mm)	Packing box weight (kg)
DOME Q1A	B13101050Q1A	128x128x65h	MR16	Aluminium	Ø80	170x140x85h	0,20
DOME Q2A	B13201050Q2A	240x128x65h	MR16	Aluminium	210x105	250x165x85h	0,43
DOME Q3A	B13301050Q3A	353x128x65h	MR16	Aluminium	325x105	365x165x85h	0,61
DOME Q4A	B13301050Q4A	240x240x65h	MR16	Aluminium	210x210	275x250x90h	0,80
DOME Q1B	B13101050Q1B	128x128x65h	MR16	White	Ø80	170x140x85h	0,20
DOME Q2B	B13201050Q2B	240x128x65h	MR16	White	210x105	250x165x85h	0,43
DOME Q3B	B13301050Q3B	353x128x65h	MR16	White	325x105	365x165x85h	0,61
DOME Q4A	B13301050Q4B	240x240x65h	MR16	White	210x210	275x250x90h	0,80



DOME Q1

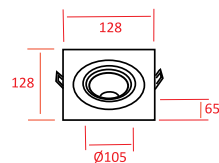

DOME Q2

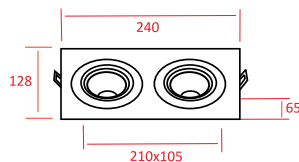

DOME Q3

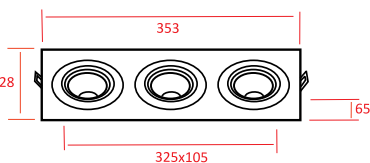

DOME Q4

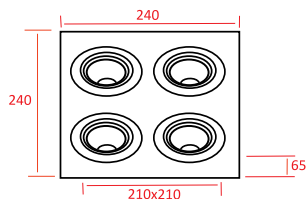

Faretto per incasso in Alluminio (per Moduli LED)

- Corpo in alluminio
- Fonte luminosa arretrata anti-abbagliamento
- Adatto per moduli led QLT serie: TR16, Q-LAMP H1, H2, H3, H5, Spotty
- Per utilizzo in controsoffitti, fissaggio con molle

Recessed Aluminium light fixtures (for LED Modules)

- Aluminum body
- Recessed light source - No dazzle
- Suitable for QLT led modules series: TR16, Q-LAMP H1, H2, H3, H5, Spotty
- To be used in counter ceilings

Aluminium-Einbaustrahler (für LED-Module)

- Aluminiumkörper
- Einbaulichtequelle - Keine Blendung
- Geeignet für QLT LED-Module Type: TR16, Q-LAMP H1, H2, H3, H5, Spotty
- Einsatz in Hängedecken, Befestigung durch Sprenglingen

Spots encastrables en Aluminium (pour platine LED)

- Corps en aluminium
- Source lumineuse en retrait - Anti-éblouissement
- Adapté aux platines à LED de QLT type: TR16, Q-LAMP H1, H2, H3, H5, Spotty
- Pour utilisation en faux-plafond, fixation avec ressorts

Focos empotrables de Aluminio (para Módulos de LED)

- Cuerpo de aluminio
- Foco empotrable - No deslumbra
- Adecuado para los módulos de leds de QLT de la serie: TR16, Q-LAMP H1, H2, H3, H5, Spotty
- Para ser utilizado en techo

- A richiesta
- On request
- Auf Anfrage
- Sur Demande
- Bajo pedido



ZTLA0B001000

BASIC



Incassi Alluminio • Aluminium fixtures



Type	Part N°	Dimensions (mm)	Standard	Colour	 (mm)	Packing box dimensions (mm)	Packing box weight (kg)
BASIC 50	B11265E50T1A	Ø78	MR16	Aluminium	Ø60	95x75x45h	0,090
BASIC 35	B10701E35T1A	Ø53	MR11	Aluminium	Ø43	95x80x50h	0,055

Faretti per incasso in Alluminio (per Moduli LED)

- Corpo in alluminio
- Orientamento fisso
- Adatto a moduli led QLT serie: TR16, Q-LAMP H1, H2, H3, H5, Spotty (Basic 50) - TR11, MONO2, MONOF (Basic 35)
- Per utilizzo in controsoffitti, fissaggio con molle

Recessed Aluminium light fixtures (for LED Modules)

- Aluminum body
- Not Adjustable
- Suitable for QLT led modules series: TR16, Q-LAMP H1, H2, H3, H5, Spotty (Basic 50) - TR11, MONO2, MONOF (Basic 35)
- To be used in counter ceilings

Aluminium-Einbaustrahler (für LED-Module)

- Aluminiumkörper
- Starr
- Geeignet für QLT LED-Module Type: TR16, Q-LAMP H1, H2, H3, H5, Spotty (Basic 50) - TR11, MONO2, MONOF (Basic 35)
- Einsatz in Hängedecken, Befestigung durch Sprengringen

Spots encastrables en Aluminium (pour platine LED)

- Corps en aluminium
- Orientation fixée
- Adapté aux platines à LED de QLT type: TR16, Q-LAMP H1, H2, H3, H5, Spotty (Basic 50) - TR11, MONO2, MONOF (Basic 35)
- Pour utilisation en faux-plafond, fixation avec ressorts

Focos empotrables de Aluminio (para Módulos de LED)

- Cuerpo de aluminio
- No ajustable
- Adecuado para los módulos de leds de QLT de la serie: TR16, Q-LAMP H1, H2, H3, H5, Spotty (Basic 50) - TR11, MONO2, MONOF (Basic 35)
- Para ser utilizado en techo

BASIC 50

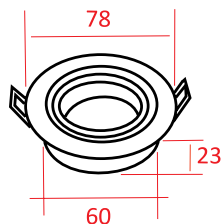

BASIC 35

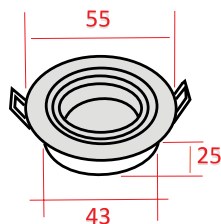

- A richiesta
- On request
- Auf Anfrage
- Sur Demande
- Bajo pedido



ZTLA0B001000

INKA



Incassi Alluminio • Aluminium fixtures



Type	Part N°	Dimensions (mm)	Standard	Colour	 (mm)	Packing box dimensions (mm)	Packing box weight (kg)
INKA T1A	B13506035T1A	Ø70	MR11	Aluminium	Ø60	100x80x45h	0,080
INKA T1N	B13505035T1N	Ø70	MR11	Black	Ø60	100x80x45h	0,080

 **Faretti per incasso in Alluminio (per Moduli LED)**

- Corpo in alluminio
- Orientabile
- Adatto per moduli led QLT serie: TR11, MONO2, MONOF
- Per utilizzo in controsoffitti, fissaggio con molle

 **Recessed Aluminium light fixtures (for LED Modules)**

- Aluminium body
- Adjustable
- Suitable for QLT led modules series: TR11, MONO2, MONOF
- To be used in counter ceilings

 **Aluminium-Einbaustrahler (für LED-Module)**

- Aluminiumkörper
- Schwenkbar
- Geeignet für QLT LED-Module Type: TR11, MONO2, MONOF
- Einsatz in Hängedecken, Befestigung durch Sprengringen

 **Spots encastrables en Aluminium (pour platine LED)**

- Corps en aluminium
- Orientable
- Adapté aux platines à LED de QLT type: TR11, MONO2, MONOF
- Pour utilisation en faux-plafond, fixation avec ressorts

 **Focos empotrables de Aluminio (para Módulos de LED)**

- Cuerpo de aluminio
- Ajustable
- Adecuado para los módulos de leds de QLT de la serie: TR11, MONO2, MONOF
- Para ser utilizado en techo

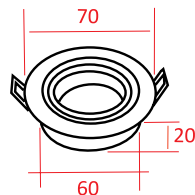

TEBE



Incassi Alluminio • Aluminium fixtures



Type	Part N°	Dimensions (mm)	Standard	Colour	 (mm)	Packing box dimensions (mm)	Packing box weight (kg)
TEBE Q1A	B13601035Q1A	70x70x19h	MR11	Aluminium	Ø60	95x80x40h	0,090
TEBE Q1B	B13601035Q1B	70x70x19h	MR11	White	Ø60	95x80x40h	0,090
REBE Q1N	B13608035Q1N	70x70x19h	MR11	Black	Ø60	95x80x40h	0,090
TEBE Q2A	B13621035Q2A	140x70x19h	MR11	Aluminium	125x60	160x110x45h	0,185
TEBE Q2N	BB13628035Q2N	140x70x19h	MR11	Black	125x60	160x110x45h	0,185

 **Faretti per incasso in Alluminio (per Moduli LED)**

- Corpo in alluminio
- Orientabile
- Adatto per moduli led QLT serie: TR11, MONO2, MONOF
- Per utilizzo in controsoffitti, fissaggio con molle

 **Recessed Aluminium light fixtures (for LED Modules)**

- Aluminum body
- Adjustable
- Suitable for QLT led modules series: TR11, MONO2, MONOF
- To be used in counter ceilings



 **Aluminium-Einbaustrahler (für LED-Module)**

- Aluminiumkörper
- Schwenkbar
- Geeignet für QLT LED-Module Type: TR11, MONO2, MONOF
- Einsatz in Hängedecken, Befestigung durch Sprenglingen

 **Spots encastrables en Aluminium (pour platine LED)**

- Corps en aluminium
- Orientable
- Adapté aux platines à LED de QLT type: TR11, MONO2, MONOF
- Pour utilisation en faux-plafond, fixation avec ressorts

 **Focos empotrables de Aluminio (para Módulos de LED)**

- Cuerpo de aluminio
- Ajustable
- Adecuado para los módulos de leds de QLT de la serie: TR11, MONO2, MONOF
- Para ser utilizado en techo

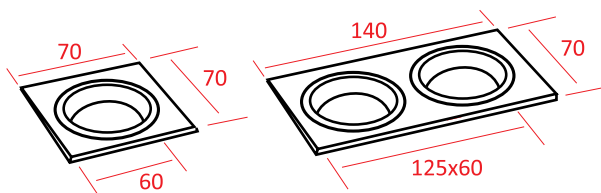

ECLYPSE

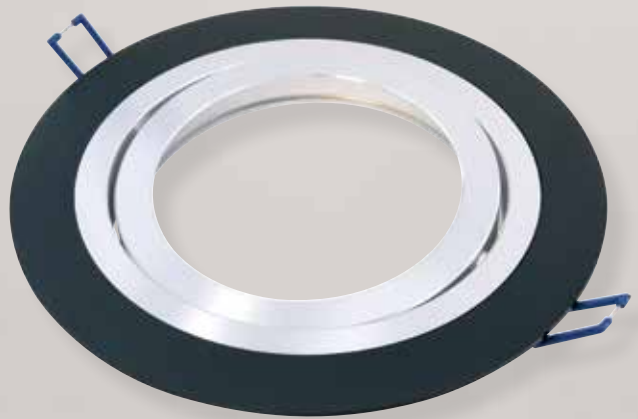

Incassi Alluminio • Aluminium fixtures



Type	Part N°	Dimensions (mm)	Standard	Colour	 (mm)	Packing box dimensions (mm)	Packing box weight (kg)
ECLYPSE T1A	B39100111T1A	Ø180	AR111	Aluminium	Ø145	210x190x45h	0,380
ECLYPSE T1N	B39400111T1N	Ø180	AR111	Black	Ø145	210x190x45h	0,380
ECLYPSE T1B	B39100111T1B	Ø180	AR111	White	Ø145	210x190x45h	0,380

Faretto per incasso in Alluminio (per Moduli LED)

- Corpo in alluminio
- Orientabile
- Adatto per moduli led QLT serie: Q-LAMP 111, U115C, U111VB, U226, U224
- Per utilizzo in controsoffitti, fissaggio con molle

Recessed Aluminium light fixtures (for LED Modules)

- Aluminum body
- Adjustable
- Suitable for QLT led modules series: Q-LAMP 111, U115C, U111VB, U226, U224
- To be used in counter ceilings

Aluminium-Einbaustrahler (für LED-Module)

- Aluminiumkörper
- Schwenkbar
- Geeignet für QLT LED-Module Type: Q-LAMP 111, U115C, U111VB, U226, U224
- Einsatz in Hängedecken, Befestigung durch Sprengringen

Spots encastrables en Aluminium (pour platine LED)

- Corps en aluminium
- Orientable
- Adapté aux platines à LED de QLT type: Q-LAMP 111, U115C, U111VB, U226, U224
- Pour utilisation en faux-plafond, fixation avec ressorts

Focos empotrables de Aluminio (para Módulos de LED)

- Cuerpo de aluminio
- Ajustable
- Adecuado para los módulos de leds de QLT de la serie: Q-LAMP 111, U115C, U111VB, U226, U224
- Para ser utilizado en techo

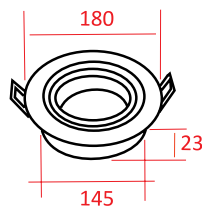

- A richiesta
- On request
- Auf Anfrage
- Sur Demande
- Bajo pedido

ZENITH

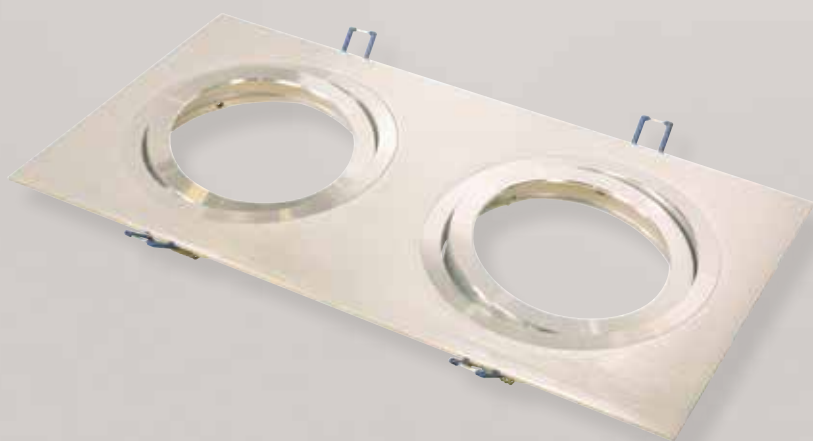

Incassi Alluminio • Aluminium fixtures



Type	Part N°	Dimensions (mm)	Standard	Colour	Ø (mm)	Packing box dimensions (mm)	Packing box weight (kg)
ZENITH Q1A	B31100111Q1A	180x180x23	AR111	Aluminium	Ø145	210x190x45h	0,320
ZENITH Q2A	B32100111Q2A	360x180x23	AR111	Aluminium	315x145	365x210x45h	0,800
ZENITH Q3A	B33100111Q3A	530x180x23	AR111	Aluminium	495x145	540x210x45h	1,170
ZENITH Q1N	B31400111Q1N	180x180x23	AR111	Black	Ø145	210x190x45h	0,320
ZENITH Q2N	B32400111Q2N	360x180x23	AR111	Black	315x145	365x210x45h	0,800
ZENITH Q3N	B33400111Q3N	530x180x23	AR111	Black	495x145	540x210x45h	1,170
ZENITH Q1B	B31100111Q1B	180x180x23	AR111	White	Ø145	210x190x45h	0,320
ZENITH Q2B	B32100111Q2B	360x180x23	AR111	White	315x145	365x210x45h	0,800
ZENITH Q3B	B33100111Q3B	530x180x23	AR111	White	495x145	540x210x45h	1,170

Faretto per incasso in Alluminio (per Moduli LED)

- Corpo in alluminio
- Orientabile
- Adatto per moduli led QLT serie: Q-LAMP 111, U115C, U111VB, U226, U224
- Per utilizzo in controsoffitti, fissaggio con molle

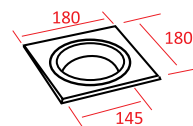

Recessed Aluminium light fixtures (for LED Modules)

- Aluminum body
- Adjustable
- Suitable for QLT led modules series: Q-LAMP 111, U115C, U111VB, U226, U224
- To be used in counter ceilings

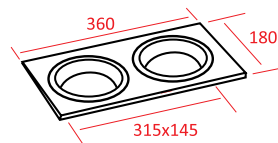
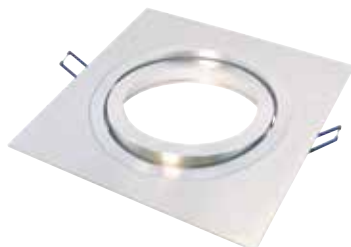

Aluminium-Einbaustrahler (für LED-Module)

- Aluminiumkörper
- Schwenkbar
- Geeignet für QLT LED-Module Type: Q-LAMP 111, U115C, U111VB, U226, U224
- Einsatz in Hängedecken, Befestigung durch Sprengringen

Spots encastrables en Aluminium (pour platine LED)

- Corps en aluminium
- Orientable
- Adapté aux platines à LED de QLT type: Q-LAMP 111, U115C, U111VB, U226, U224
- Pour utilisation en faux-plafond, fixation avec ressorts

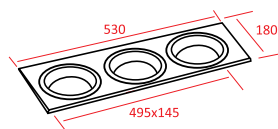

Focos empotrables de Aluminio (para Módulos de LED)

- Cuerpo de aluminio
- Ajustable
- Adecuado para los módulos de leds de QLT de la serie: Q-LAMP 111, U115C, U111VB, U226, U224
- Para ser utilizado en techo



- A richiesta
- On request
- Auf Anfrage
- Sur Demande
- Bajo pedido

SONAR



Incassi Alluminio • Aluminium fixtures

SONAR Incassi Alluminio • Aluminium Fixtures



Type	Part N°	Dimensions (mm)	Standard	Colour	Packing box dimensions (mm)	Packing box weight (kg)
SONAR T1A	B3011S111G1A	170x90x200h	AR111	Aluminium	180x100x210h	0,750
SONAR T2A	B3012S111G2A	325x90x200h	AR111	Aluminium	210x100x340h	1,230
SONAR T3A	B3013S111G3A	480x90x200h	AR111	Aluminium	210x100x490h	1,740

Suggested LED lamp and driver: QLT QL111 + T70LED



Proiettore LED

- Corpo in alluminio
- Orientabile su due assi
- Adatto a moduli led QLT serie: Q-LAMP 111, U111VB, U226, U224

LED Projector

- Aluminum body
- Adjustable on both axes
- Suitable for QLT led modules series: Q-LAMP 111, U111VB, U226, U224

LED-Projektor

- Aluminiumkörper
- Schwenkbar entlang zweier Achsen
- Geeignet für QLT LED-Module Type: Q-LAMP 111, U111VB, U226, U224

Projecteur LED

- Corps en aluminium
- Ajustable sur deux axes
- Adapté aux platines à LED de QLT type: Q-LAMP 111, U111VB, U226, U224

Proyector LED

- Cuerpo de aluminio
- Ajustable en dos ejes
- Adecuado para los módulos de leds de QLT de la serie: Q-LAMP 111, U111VB, U226, U224

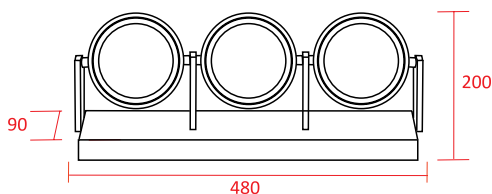
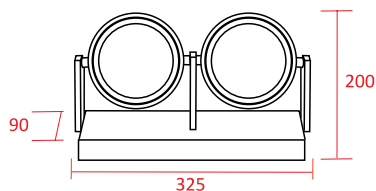
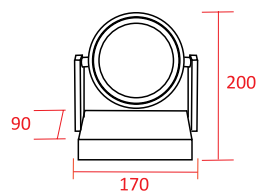

GLAM



Incassi Alluminio • Aluminium fixtures



Type	Part N°	Dimensions (mm)	Standard	Colour	 (mm)	Packing box dimensions (mm)	Packing box weight (kg)
GLAM SQUARE	B15010150Q1B	82x82x35h	MR16	White	70x70	115x95x65h	0,160
GLAM ROUND	B15010950T1B	82x35h	MR16	White	Ø70	115x95x65h	0,160

 **Faretti per incasso in Alluminio (per Moduli LED)**

- Corpo in alluminio
- Fonte luminosa arretrata anti-abbagliamento
- Adatto per moduli led QLT serie: TR16, Q-LAMP H1, H2, H3, H5, Spotty
- Per utilizzo in controsoffitti, fissaggio con molle

 **Recessed Aluminium light fixtures (for LED Modules)**

- Aluminum body
- Recessed light source - No dazzle
- Suitable for QLT led modules series: TR16, Q-LAMP H1, H2, H3, H5, Spotty
- To be used in counter ceilings

 **Aluminium-Einbaustrahler (für LED-Module)**

- Aluminiumkörper
- Einbaulichtequelle - Keine Blendung
- Geeignet für QLT LED-Module Type: TR16, Q-LAMP H1, H2, H3, H5, Spotty
- Einsatz in Hängedecken, Befestigung durch Sprengringen

 **Spots encastrables en Aluminium (pour platine LED)**

- Corps en aluminium
- Source lumineuse en retrait - Anti-éblouissement
- Adapté aux platines à LED de QLT type: TR16, Q-LAMP H1, H2, H3, H5, Spotty
- Pour utilisation en faux-plafond, fixation avec ressorts

 **Focos empotrables de Aluminio (para Módulos de LED)**

- Cuerpo de aluminio
- Foco empotrable - No deslumbra
- Adecuado para los módulos de leds de QLT de la serie: TR16, Q-LAMP H1, H2, H3, H5, Spotty
- Para ser utilizado en techo



FLIP



Incassi Alluminio • Aluminium Fixtures

FLIP Incassi Alluminio • Aluminium Fixtures



Type	Part N°	Dimensions (mm)	Standard	Colour	Ø (mm)	Packing box dimensions (mm)	Packing box weight (kg)
FLIP SMALL	B40080050T1B	Ø89,5x61,5h	MR16	White	Ø70,5	115x95x65h	0,44
FLIP LARGE	B80040111T1B	Ø148x62,5h	AR111	White	Ø120	155x155x65h	0,75

FLIP SMALL B40080050T1B

Faretti per incasso in Alluminio (per Moduli LED)

- Corpo in alluminio
- Fonte luminosa arretrata anti-abbagliamento
- Adatto per moduli led QLT serie: TR16, Q-LAMP H1, H2, H3, H5, Spotty
- Per utilizzo in controsoffitti, fissaggio con molle

Recessed Aluminium light fixtures (for LED Modules)

- Aluminum body
- Recessed light source - No dazzle
- Suitable for QLT led modules series: TR16, Q-LAMP H1, H2, H3, H5, Spotty
- To be used in counter ceilings

Aluminium-Einbaustrahler (für LED-Module)

- Aluminiumkörper
- Einbaulichtequelle - Keine Blendung
- Geeignet für QLT LED-Module Type: TR16, Q-LAMP H1, H2, H3, H5, Spotty
- Einsatz in Hängedecken, Befestigung durch Sprengringen

Spots encastrables en Aluminium (pour platine LED)

- Corps en aluminium
- Source lumineuse en retrait - Anti-éblouissement
- Adapté aux platines à LED de QLT type: TR16, Q-LAMP H1, H2, H3, H5, Spotty
- Pour utilisation en faux-plafond, fixation avec ressorts

Focos empotrables de Aluminio (para Módulos de LED)

- Cuerpo de aluminio
- Foco empotrable - No deslumbra
- Adecuado para los módulos de leds de QLT de la serie: TR16, Q-LAMP H1, H2, H3, H5, Spotty
- Para ser utilizado en techo

FLIP LARGE B80040111T1B

Faretti per incasso in Alluminio (per Moduli LED)

- Corpo in alluminio
- Fonte luminosa arretrata anti-abbagliamento
- Adatto per moduli led QLT serie: Q-LAMP 111, U115C, U111VB, U226, U224
- Per utilizzo in controsoffitti, fissaggio con molle

Recessed Aluminium light fixtures (for LED Modules)

- Aluminum body
- Recessed light source - No dazzle
- Suitable for QLT led modules series: Q-LAMP 111, U115C, U111VB, U226, U224
- To be used in counter ceilings

Aluminium-Einbaustrahler (für LED-Module)

- Aluminiumkörper
- Einbaulichtequelle - Keine Blendung
- Geeignet für QLT LED-Module Type: Q-LAMP 111, U115C, U111VB, U226, U224
- Einsatz in Hängedecken, Befestigung durch Sprengringen

Spots encastrables en Aluminium (pour platine LED)

- Corps en aluminium
- Source lumineuse en retrait - Anti-éblouissement
- Adapté aux platines à LED de QLT type: Q-LAMP 111, U115C, U111VB, U226, U224
- Pour utilisation en faux-plafond, fixation avec ressorts

Focos empotrables de Aluminio (para Módulos de LED)

- Cuerpo de aluminio
- Foco empotrable - No deslumbra
- Adecuado para los módulos de leds de QLT de la serie: Q-LAMP 111, U115C, U111VB, U226, U224
- Para ser utilizado en techo

FRAMELESS

60x60

Pannelli LED • LED panels

FRAMELESS 60x60 Pannelli LED • LED panels



IP52 RoHS

24 Volt
Safety Voltage

Vedere pagina 138 per i kit che includono l'alimentatore - See page 138 for kits including drivers

Standard: for modular ceilings

Molle BPLKITSRING

Optional: ceiling kit

Part N°: BPLKITCEIL1B

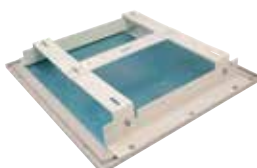
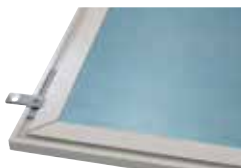

Optional: suspension kit

Part N°: BPLKIT4X150C

Optional: wall kit

Part N°: BPLKITWALLOB

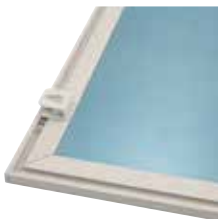
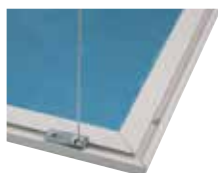

Type	Part N°	Dimensions (mm)	Colour	°Kelvin	Lumen	Power (W)	Packing box dimensions (mm)	Weight (kg)
60x60 FRAMELESS CW	BPL6060FRAMC	595x595x10,5h	Cool White	6000°K	4322	42	650x310x40h	4,2
60x60 FRAMELESS NW	BPL6060FRAMN	595x595x10,5h	Natural White	4200°K	4078	42	650x310x40h	4,2
60x60 FRAMELESS WW	BPL6060FRAMW	595x595x10,5h	Warm White	3000°K	3761	42	650x310x40h	4,2

🇮🇹 Pannelli FRAMELESS

- Struttura in alluminio senza cornice
- I pannelli si possono affiancare al fine di creare intere pareti senza interruzioni e con grande uniformità luminosa
- Adatto per sostituire incassi standard per tubi fluo
- Grande omogeneità luminosa - Spessore 10,5 mm
- Funziona in bassa tensione con trasformatore 24V DC specifico fornito a richiesta
- Consumo limitato

🇬🇧 FRAMELESS panel

- Aluminum body without frame
- Panels can be installed side by side without interruptions, granting a continuous lighting uniformity
- Suitable for replacing standard fixtures for fluo tubes
- Great homogeneity of light - Thickness 10,5 mm
- Safety low voltage with specific 24V DC drivers (supplied on request)
- Limited consumption

🇩🇪 Panelen FRAMELESS

- Struktur aus Aluminium ohne Rahme
- Die Led-Panelen können verbunden werden, um ganze Wände ohne Unterbrechung und mit großer Farb- und Helligkeitsverteilung zu erstellen
- Für direkten Ersatz von standard Leuchtstoffröhren geeignet
- Groß Homogenität des Lichts - Dicke 10,5 mm
- NV-Betrieb durch besonderen 24VDC Transformator auf Anfrage geliefert
- Begrenzter Verbrauch

🇫🇷 Panneaux LED FRAMELESS

- Structure en aluminium sans encadrement
- Les panneaux peuvent être assemblés afin de créer des parois sans interruptions et avec une grande uniformité lumineuse
- Approprié pour le remplacement des encastrables standard à tubes fluo
- Luminosité très homogène - Épaisseur 10,5 mm
- Il marche en basse tension avec un transformateur 24V DC (livré sur demande) - Consommation limitée

🇪🇸 Paneles sin marco

- Cuerpo de aluminio sin marco
- Los paneles pueden instalarse uno al lado del otro sin interrupciones, garantizando una uniformidad continua de luz
- Adecuado para remplazo directo de lampara estandar con tubos de fluorescencia
- Excelente homogeneidad luminica - Grosor 10,5 mm
- Alta seguridad por funcionamiento a baja tension, con drivers especificos de 24VDC (bajo demanda) - Bajo consume

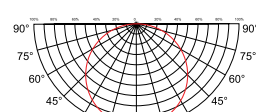
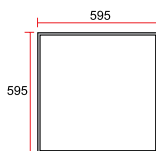

LED-SKY PANEL

60x60 • 60x120



Pannelli LED • LED panels

LED-SKY PANEL 60X60 • 60x120 Pannelli LED • LED panels



Vedere pagina 138 per i kit che includono l'alimentatore - See page 138 for kits including drivers



Standard: for modular ceilings

Molle BPLKITSRING

Optional: ceiling kit

Part N°: BPLKITCEIL1B

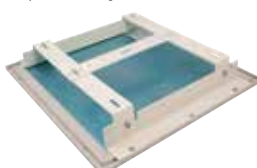
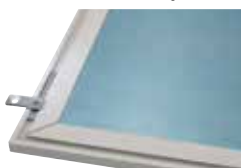

Optional: suspension kit

Part N°: BPLKIT4X150C

Optional: wall kit

Optional: closed ceiling kit (60x60 only)

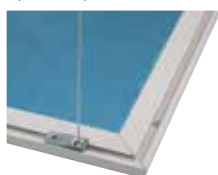

Part N°: BPLKITWALLOB



Part N°: BPLKITBOX00A Aluminium

Part N°: BPLKITBOX00B White

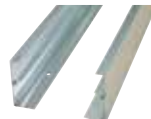

Type	Part N° (mm)	Dimensions	Colour	Frame colour	°Kelvin (W)	Lumen dimensions (mm)	Power (kg)	Packing box	Weight
60x60 CW	BPL60600EACW	595x595x10,5h	Cool White	Aluminum	6000°K	4322	42	650x650x40h	4,2
60x60 NW	BPL60600EANW	595x595x10,5h	Natural White	Aluminum	4200°K	4078	42	650x650x40h	4,2
60x60 WW	BPL60600EAWW	595x595x10,5h	Warm White	Aluminum	3000°K	3761	42	650x650x40h	4,2
60x60 CW	BPL60600EACB	595x595x10,5h	Cool White	White	6000°K	4322	42	650x650x40h	4,2
60x60 NW	BPL60600EANB	595x595x10,5h	Natural White	White	4200°K	4078	42	650x650x40h	4,2
60x60 WW	BPL60600EAWB	595x595x10,5h	Warm White	White	3000°K	3761	42	650x650x40h	4,2
60x120 NW	BPL60120EANW	1195x595x14h	Natural White	Aluminum	4200°K	6470	85	1350x660x60h	10,5
60x120 WW	BPL60120EAWW	1195x595x14h	Warm White	Aluminum	3000°K	6082	85	1350x660x60h	10,5

🇮🇹 Pannello LED 60x60 - 60x120

- Cornice e struttura in alluminio
- Adatto per sostituire incassi standard per tubi fluo
- Grande omogeneità luminosa
- Funziona in bassa tensione con trasformatore 24V DC specifico fornito a richiesta
- Consumo limitato

🇬🇧 LED panel 60x60 - 60x120

- Structure and frame in aluminum
- Suitable for replacing standard fixtures for fluo tubes
- Great homogeneity of light
- Safety low voltage with specific 24V DC drivers (supplied on request)
- Limited consumption

🇩🇪 LED-Tafel 60x60 - 60x120

- Rahme und Körper aus Aluminium
- Für direkten Ersatz von standard Leuchtstoffröhren geeignet
- Groß Homogenität des Lichts
- NV-betrieb durch besonderen 24VDC Transformator auf Anfrage geliefert
- Begrenzter Verbrauch

🇫🇷 Panneau LED 60x60 - 60x120

- Encadrement et corps en aluminium
- Approprié pour le remplacement des encastrables standard à tubes fluo
- Luminosité très homogène
- Il marche en basse tension avec un transformateur 24V DC (livré sur demande) - Consommation limitée

🇪🇸 Panel LED 60x60 - 60x120

- Estructura y marco de aluminio
- Adecuado para remplazo directo de lampara estandar con tubos de fluorescencia
- Excelente homogeneidad luminica
- Alta seguridad por funcionamiento a baja tension, con drivers especificos de 24VDC (bajo demanda) - Bajo consume

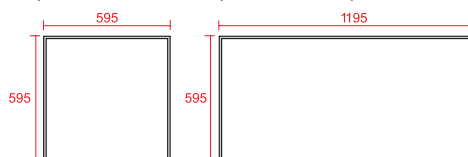

LED-SKI PANEL DRI

60x60

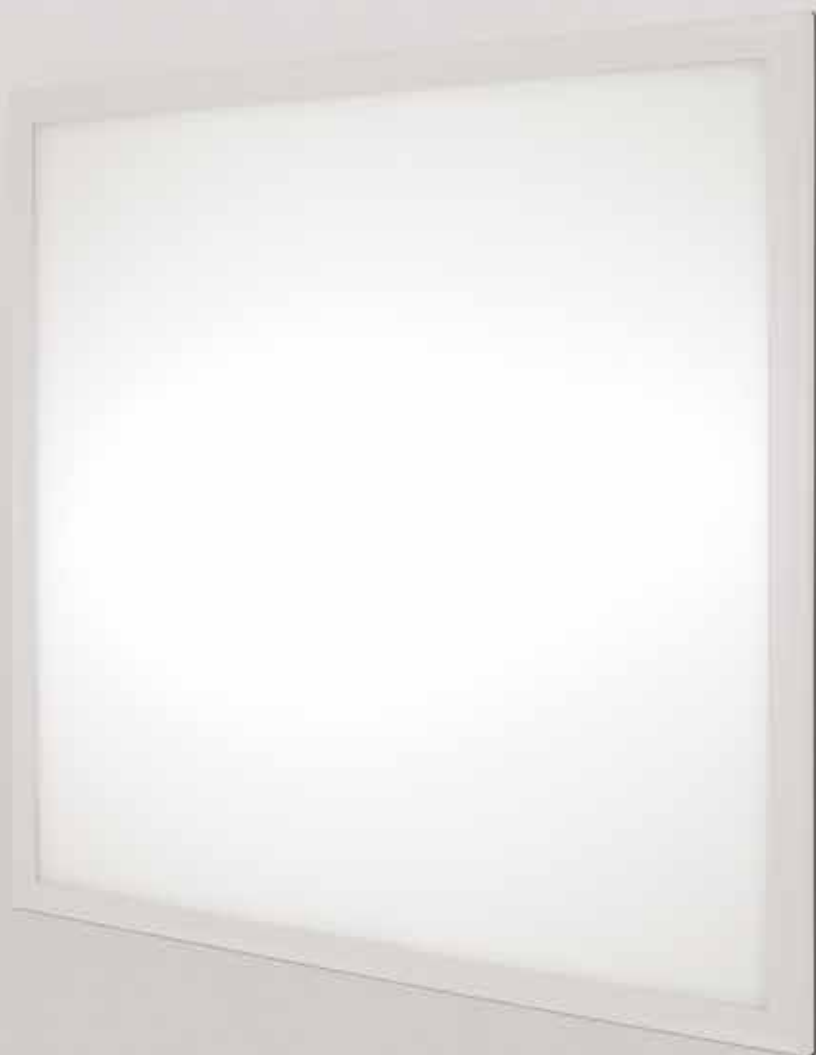

Pannelli LED • LED panels

LED-SKY PANEL DRI 60x60 Pannelli LED • LED panels

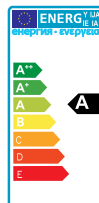

IP52 RoHS

24 Volt
Safety Voltage

Molle BPLKITSRING



Optional: ceiling kit

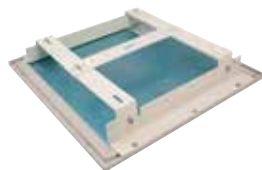

Part N°: BPLKITCEIL1B



Optional: closed ceiling kit (60x60 only)



Part N°: BPLKITBOX00A Aluminium

Part N°: BPLKITBOX00B White

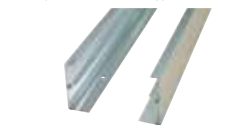

Optional: suspension kit

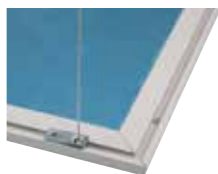

Part N°: BPLKIT4X150C



Optional: wall kit

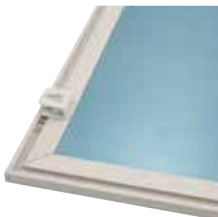

Part N°: BPLKITWALLOB



Type	Part N°	Dimensions	Colour (mm)	Frame colour	°Kelvin	Lumen	Power (W)	Packing box dimensions (mm)	Weight (kg)
60x60 CW	BPL6060DRICW	595x595x10,5h	Cool White	Aluminum	6000°K	3918	42	670x620x30h	3,7
60x60 NW	BPL6060DRINW	595x595x10,5h	Natural White	Aluminum	4200°K	3407	42	670x620x30h	3,7
60x60 WW	BPL6060DRIWW	595x595x10,5h	Warm White	Aluminum	3000°K	2895	42	670x620x30h	3,7
60x60 CW	BPL6060DRICB	595x595x10,5h	Cool White	White	6000°K	3918	42	670x620x30h	3,7
60x60 NW	BPL6060DRINB	595x595x10,5h	Natural White	White	4200°K	3407	42	670x620x30h	3,7
60x60 WW	BPL6060DRIWB	595x595x10,5h	Warm White	White	3000°K	2895	42	670x620x30h	3,7

Pannello LED 60x60 DRI

- Cornice e struttura in alluminio
- Adatto per sostituire incassi standard per tubi fluo
- Grande omogeneità luminosa
- Funziona in bassa tensione con trasformatore 1A specifico
- Consumo limitato

- Approprié pour le remplacement des encastrables standard à tubes fluo
- Luminosité très homogène
- Il marche en basse tension avec un transformateur 1A
- Consommation limitée

LED panel 60x60 DRI

- Structure and frame in aluminum
- Suitable for replacing standard fixtures for fluo tubes
- Great homogeneity of light
- Safety low voltage with specific 1A drivers
- Limited consumption

Panel LED 60x60 DRI

- Estructura y marco de aluminio
- Adecuado para remplazo directo de lampara estandar con tubos de fluorescencia
- Excelente homogeneidad luminica
- Alta seguridad por funcionamiento a baja tension, con drivers especificos de 1A
- Bajo consume

LED-Tafel 60x60 DRI

- Rahme und Körper aus Aluminium
- Für direkten Ersatz von standard Leuchtstoffröhren geeignet
- Groß Homogenität des Lichts- Dicke 10,5 mm
- NV-betrieb durch besonderen 1A Transformator
- Begrenzter Verbrauch

Panneau LED 60x60 DRI

- Encadrement et corps en aluminium

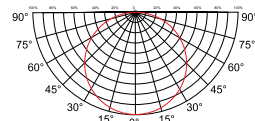
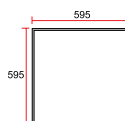

LED-SKY PANEL

30x30 • 30x60 • 30x120



Pannelli LED • LED panels

LED-SKY PANEL 30x30 • 30x60 • 30x120 Pannelli LED • LED

panels modular ceilings

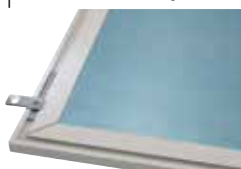

Molle BPLKITSRING



Optional: ceiling kit

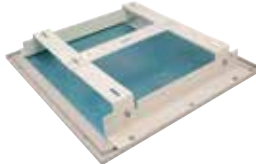

Part N°: BPLKITCEILOB



Optional: suspension kit

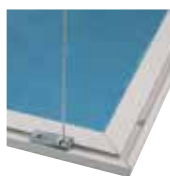

Part N°: BPLKIT4X150C



Optional: wall kit



Part N°: BPLKITWALLOB

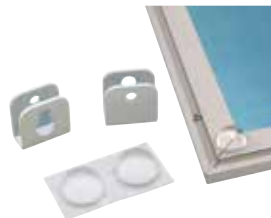

Vedere pagina 138 per i kit che includono l'alimentatore - See page 138 for kits including drivers

Type	Part N°	Dimensions (mm)	Colour	°Kelvin	Lumen	Power (W)	Packing box dimensions (mm)	Weight (kg)
30x30 CW	BPL30300EACW	295x295x10,5h	Cool White	6000°K	698	10	350x310x40h	1,1
30x30 NW	BPL30300EANW	295x295x10,5h	Natural White	4200°K	659	10	350x310x40h	1,1
30x30 WW	BPL30300EAWW	295x295x10,5h	Warm White	3000°K	619	10	350x310x40h	1,1
30x60 CW	BPL30600EACW	595x295x10,5h	Cool White	6000°K	1550	22	620x350x40h	1,9
30x60 NW	BPL30600EANW	595x295x10,5h	Natural White	4200°K	1450	22	620x350x40h	1,9
30x60 WW	BPL30600EAWW	595x295x10,5h	Warm White	3000°K	1376	22	620x350x40h	1,9
30x120 CW	BPL30120EACW	1195x295x10,5h	Cool White	6000°K	3510	46	1200x350x40h	4,0
30x120 NW	BPL30120EANW	1195x295x10,5h	Natural White	4200°K	3390	46	1200x350x40h	4,0
30x120 WW	BPL30120EAWW	1195x295x10,5h	Warm White	3000°K	3187	46	1200x350x40h	4,0

🇮🇹 Pannello LED 30x30 - 30x60 - 30x120

- Cornice e struttura in alluminio
- Adatto per sostituire incassi standard per tubi fluo
- Grande omogeneità luminosa- Spessore 10,5 mm
- Funziona in bassa tensione con trasformatore 24V DC specifico fornito a richiesta
- Consumo limitato

🇬🇧 LED panel 30x30 - 30x60 - 30x120

- Structure and frame in aluminium
- Suitable for replacing standard fixtures for fluo tubes
- Great homogeneity of light
- Thickness 10,5 mm
- Safety low voltage with specific 24V DC drivers (supplied on request)
- Limited consumption

🇩🇪 LED-Tafel 30x30 - 30x60 - 30x120

- Rahme und Körper aus Aluminium
- Für direkten Ersatz von standard Leuchtstoffröhren geeignet
- Groß Homogenität des Lichts- Dicke 10,5 mm
- NV-betrieb durch besonderen 24VDC Transformator auf Anfrage geliefert
- Begrenzter Verbrauch

🇫🇷 Panneau LED 30x30 - 30x60 - 30x120

- Encadrement et corps en aluminium
- Approprié pour le remplacement des encastrables standard à tubes fluo

- Luminosité très homogène
- Épaisseur 10,5 mm
- Il marche en basse tension avec un transformateur 24V DC (livré sur demande) - Consommation limitée

🇪🇸 Panel LED 30x30 - 30x60 - 30x120

- Estructura y marco de aluminio
- Adecuado para remplazo directo de lampara estandar con tubos de fluorescencia
- Excelente homogeneidad luminica
- Grosor 10,5 mm
- Alta seguridad por funcionamiento a baja tension, con drivers especificos de 24VDC (bajo demanda) - Bajo consume

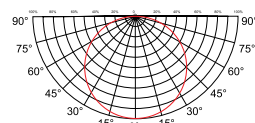
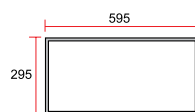
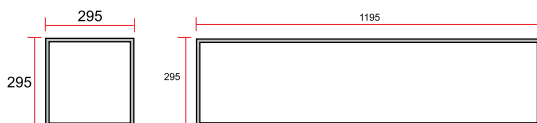

LED-SKY PANEL RGB



Pannelli LED • LED panels

LED-SKY PANEL RGB Pannelli LED • LED panels



Vedere pagina 138 per i kit che includono l'alimentatore - See page 138 for kits including drivers



Part N°: BPLKITCEILOB for 30x30
Part N°: BPLKITCEI1B for 60x60 - 60x120

Standard: for modular ceilings

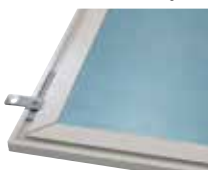

Molle BPLKITSRING



Optional: ceiling kit

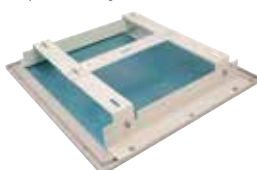

Part N°: BPLKITCEILOB



Optional: suspension kit

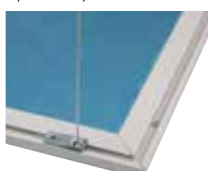

Part N°: BPLKIT4X150C



Optional: wall kit

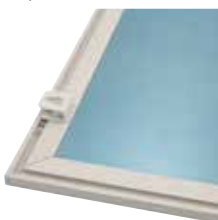

Part N°: BPLKITWALLOB



Type	Part N°	Dimensions (mm)	Colour	Power (W)	Packing box dimensions (mm)	Weight (kg)
30x30 RGB	BPL30300EARG	295x295x10,5h	RGB	10	350x310x40h	1,1
60x60 RGB	BPL60600EARG	595x595x10,5h	RGB	42	650x650x30h	4,2
60x120 RGB	BPL60120EARG	1195x595x14h	RGB	55	1350x660x60h	10,5

🇮🇹 Pannello LED RGB

- Cornice e struttura in alluminio
- Adatto per sostituire incassi standard per tubi fluo
- Grande omogeneità luminosa - Spessore 10,5 mm
- Funziona in bassa tensione con driver QLT mod. RBOX55
- Consumo limitato: 60x120 55W - 60x60 42W - 30x30 10W

🇬🇧 LED panel RGB

- Structure and frame in aluminum
- Suitable for replacing standard fixtures for fluo tubes
- Great homogeneity of light
- Thickness 10,5 mm
- Safety low voltage with QLT RBOX55 (supplied on request)
- Limited consumption: 60x120 55W - 60x60 42W - 30x30 10W

🇩🇪 LED-Tafel RGB

- Rahme und Körper aus Aluminium
- Für direkten Ersatz von standard Leuchtstoffröhren geeignet
- Groß Homogenität des Lichts
- Dicke 10,5 mm
- NV-betrieb durch besonderen QLT RBOX55 auf Anfrage geliefert
- Begrenzter Verbrauch: 60x120 55W - 60x60 42W - 30x30 10W

🇫🇷 Panneau LED RGB

- Encadrement et corps en aluminium
- Approprié pour le remplacement des encastrables standard à tubes fluo
- Luminosité très homogène - Épaisseur 10,5 mm
- Il marche en basse tension avec QLT RBOX55 (livré sur demande)
- Consommation limitée: 60x120 55W - 60x60 42W - 30x30 10W

🇪🇸 Panel LED RGB

- Estructura y marco de aluminio
- Adecuado para remplazo directo de lampara estandar con tubos de fluorescencia
- Excelente homogeneidad luminica
- Grosor 10,5 mm
- Alta seguridad por funcionamiento a baja tension, con drivers QLT RBOX55 (bajo demanda)
- Bajo consume: 60x120 55W - 60x60 42W - 30x30 10W

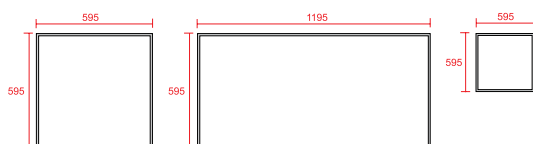

ROUND PIZZA-LED



Incassi LED • LED downlights

ROUND PIZZA-LED Incassi LED • LED downlights



RAL 9010



Vedere pagina 138 per i kit che includono l'alimentatore - See page 138 for kits including drivers

Type	Part N°	Dimensions (mm)	Colour	°Kelvin	Lumen	Power (W)	Installation hole (mm)	Packing box dimensions (mm)	Weight (kg)
ROUND 95 NW	BD09524TNW1B	Ø 95x28h	Natural White	4200°K	395	8	Ø 80	200x150x60h	0,21
ROUND 95 WW	BD09524TWW1B	Ø 95x28h	Warm White	3000°K	372	8	Ø 80	200x150x60h	0,21
ROUND 140 NW	BD14024TNW1B	Ø 140x28h	Natural White	4200°K	695	11	Ø 120	240x180x60h	0,33
ROUND 140 WW	BD14024TWW1B	Ø 140x28h	Warm White	3000°K	656	11	Ø 120	240x180x60h	0,33
ROUND 170 NW	BD17024TNW1B	Ø 170x31h	Natural White	4200°K	1066	16	Ø 145	260x200x60h	0,43
ROUND 170 WW	BD17024TWW1B	Ø 170x31h	Warm White	3000°K	1006	16	Ø 145	260x200x60h	0,43
ROUND 200 NW	BD20024TNW1B	Ø 200x31h	Natural White	4200°K	1195	17	Ø 180	330x230x60h	0,57
ROUND 200 WW	BD20024TWW1B	Ø 200x31h	Warm White	3000°K	1127	17	Ø 180	330x230x60h	0,57
ROUND 275 NW	BD27524TNW1B	Ø 275x31h	Natural White	4200°K	2167	28	Ø 250	380x340x60h	1,00
ROUND 275 WW	BD27524TWW1B	Ø 275x31h	Warm White	3000°K	2044	28	Ø 250	380x340x60h	1,00
ROUND 330 NW	BD33024TNW1B	Ø 330x31h	Natural White	4200°K	2876	36	Ø 310	470x360x60h	1,70
ROUND 330 WW	BD33024TWW1B	Ø 330x31h	Warm White	3000°K	2713	36	Ø 310	470x360x60h	1,70

Incasso a LED tondo extrapiatto

- Cornice e struttura in alluminio verniciato
- Grande omogeneità luminosa
- Funziona in bassa tensione con trasformatore 24V DC specifico fornito a richiesta
- Consumo limitato
- Lunga durata

Round extra flat recessed LED fixture

- Structure and frame in lacquered aluminium
- Extra flat
- Safety low voltage with specific 24V DC drivers (supplied on request)
- Limited consumption

Runde extraflache LED Einbaustrahler

- Rahme und Körper aus lackiertem Aluminium
- NV-betrieb durch besonderen 24VDC Transformator auf Anfrage geliefert
- Begrenzter Verbrauch
- Lange Lebensdauer

Encastrable à LED rond extra plat

- Encadrement et corps en aluminium verni
- Luminosité très homogène
- Il marche en basse tension avec un transformateur 24V DC (livré sur demande)
- Consommation limitée
- Longue durée de vie

Focos empotrables a LED extra plano

- Estructura y marco de aluminio pintado
- Excelente homogeneidad luminica
- Alta seguridad por funcionamiento a baja tension, con drivers específicos de 24VDC (bajo demanda)
- Bajo consume
- Larga vida

SQUARE PIZZA-LED



Incassi LED • LED downlights

SQUARE PIZZA-LED Incassi LED • LED downlights



RAL 9010



Vedere pagina 138 per i kit che includono l'alimentatore - See page 138 for kits including drivers

Type	Part N°	Dimensions (mm)	Colour	°Kelvin	Lumen	Power (W)	Installation hole (mm)	Packing box dimensions (mm)	Weight (kg)
SQUARE 100 NW	BD10024QNW1B	100x100x28h	Natural White	4200°K	303	6	85x95	200x190x60h	0,26
SQUARE 100 WW	BD10024QWW1B	100x100x28h	Warm White	3000°K	286	6	85x95	200x190x60h	0,26
SQUARE 150 NW	BD15024QNW1B	150x150x28h	Natural White	4200°K	727	12	125x125	250x240x60h	0,46
SQUARE 150 WW	BD15024QWW1B	150x150x28h	Warm White	3000°K	686	12	125x125	250x240x60h	0,46
SQUARE 180 NW	BD18024QNW1B	180x180x28h	Natural White	4200°K	1134	18	160x160	270x260x60h	0,59
SQUARE 180 WW	BD18024QWW1B	180x180x28h	Warm White	4200°K	1070	18	160x160	270x260x60h	0,59
SQUARE 250 NW	BD25024QNW1B	250x250x31h	Natural White	4200°K	2136	31	225x225	350x340x60h	1,05
SQUARE 250 WW	BD25024QWW1B	250x250x31h	Warm White	3000°K	2015	31	225x225	350x340x60h	1,05
SQUARE 330 NW	BD33024QNW1B	330x330x31h	Natural White	4200°K	3147	42	305x305	460x370x60h	1,70
SQUARE 330 WW	BD33024QWW1B	330x330x31h	Warm White	3000°K	2969	42	305x305	460x370x60h	1,70

🇮🇹 Incasso a LED quadro extrapiatto

- Cornice e struttura in alluminio verniciato
- Grande omogeneità luminosa
- Funziona in bassa tensione con trasformatore 24V DC specifico fornito a richiesta
- Consumo limitato
- Lunga durata

🇬🇧 Square extra flat recessed LED fixture

- Structure and frame in lacquered aluminum
- Extra flat
- Safety low voltage with specific 24V DC drivers (supplied on request)
- Limited consumption

🇩🇪 Viereckige extraflache LED Einbastrahler

- Rahme und Körper aus lackiertem Aluminium
- NV-betrieb durch besonderen 24VDC Transformator auf Anfrage geliefert
- Begrenzter Verbrauch
- Lange Lebensdauer

🇫🇷 Encastrable à LED carré extra plat

- Encadrement et corps en aluminium verni
- Luminosité très homogène
- Il marche en basse tension avec un transformateur 24V DC (livré sur demande)
- Consommation limitée
- Longue durée de vie

🇪🇸 Focos empotrables a LED cuadrado extra plano

- Estructura y marco de aluminio pintado
- Excelente homogeneidad luminica
- Alta seguridad por funcionamiento a baja tension, con drivers específicos de 24VDC (bajo demanda)
- Bajo consume
- Larga vida



BUD



Incassi LED • LED downlights

BUD Incassi LED • LED downlights



Vedere pagina 138 per i kit che includono l'alimentatore - See page 138 for kits including drivers

Type	Part N°	Dimensions (mm)	Colour	Lumen (lm)	Voltage Max (V)	Current Max (mA)	Beam °	Power Max (W)	Installation hole (mm)	Packing box dimensions (mm)	Weight (kg)
BUD 78 NW	BD078CCTNWOB	Ø 78x53h	NW 4000°K	324	11	500	46°	6	Ø67	115x96x85	0,13
BUD 98 NW	BD098CCTNWOB	Ø 96x60h	NW 4000°K	606	40	240	40°	10	Ø83	130x120x90	0,21
BUD 116 NW	BD116CCTNWOB	Ø 116x80h	NW 4000°K	998	40	350	20°	14	Ø102	155x125x100	0,31
BUD 142 NW	BD142CCTNWOB	Ø 142x101h	NW 4000°K	1336	40	500	25°	20	Ø122	160x160x130	0,57
BUD 210 NW	BD210CCTNWOB	Ø 210x150h	NW 4000°K	1911	39	700	50°	28	Ø180	215x215x180	1,56
BUD 78 WW	BD078CCTWWOB	Ø 78x53h	WW 3000°K	300	11	500	46°	6	Ø67	115x96x85	0,13
BUD 98 WW	BD098CCTWWOB	Ø 96x60h	WW 3000°K	562	40	240	40°	10	Ø83	130x120x90	0,21
BUD 116 WW	BD116CCTWWOB	Ø 116x80h	WW 3000°K	921	40	350	20°	14	Ø102	155x125x100	0,31
BUD 142 WW	BD142CCTWWOB	Ø 142x101h	WW 3000°K	1299	40	500	25°	20	Ø122	160x160x130	0,57
BUD 210 WW	BD210CCTWWOB	Ø 210x150h	WW 3000°K	1879	39	700	50°	28	Ø180	215x215x180	1,56

Incasso a LED tondo ad alta potenza

- Led CITIZEN
- Cornice estetica e struttura dissipante in alluminio
- Grande omogeneità luminosa
- Per installazioni di tipo professionale
- Funziona in bassa tensione con trasformatore elettronico specifico a corrente costante, fornito a richiesta
- Lunga durata

Focos empotrables a LED de alta potencia

- Led de CITIZEN
- Estructura de disipación y marco estético en aluminio
- Alta y homogénea luminosidad
- Para uso profesional
- Baja tensión con convertidor de corriente constante específico (suministrado bajo demanda)
- Larga duración

Round extra powerful recessed LED downlight

- CITIZEN led
- Dissipating structure and aesthetic frame in aluminium
- High brightness homogeneity
- For professional use
- Safety low voltage with specific constant current driver (supplied on request)
- Long life time

LED Rundenbastrahler

- CITIZEN Led
- Ästhetische Rahme und Kühlkörper aus Aluminium
- Große Lichthomogenität
- Für berufliche Installationen geeignet
- Betrieb auf Niedervolt durch besonderen elektronischen Transformator auf Konstantstrom, nur auf Anfrage
- Lange Lebensdauer

Encastrement LED rond haute puissance

- Led CITIZEN
- Encadrement esthétique et structure dissipante en aluminium
- Grande homogénéité lumineuse
- Pour installations de type professionnel
- Fonctionne à basse tension avec un transformateur électronique spécifique à courant constant, fourni sur demande
- Longue durée de vie



ORION



Incassi LED • LED downlights



Vedere pagina 138 per i kit che includono l'alimentatore - See page 138 for kits including drivers

Type	Part N°	Dimensions (mm)	Colour	Lumen (lm)	Voltage Max (V)	Current Max (mA)	Beam °	Power Max (W)	Installation hole (mm)	Packing box dimensions (mm)	Weight (kg)
ORION 135 NW	BD135CCTNW0B	Ø 135x70h	NW 4000°K	904	21	700	80°	15	Ø 105	150x145x80	0,30
ORION 160 NW	BD160CCTNW0B	Ø 160x75h	NW 4000°K	1266	24	700	80°	17	Ø 130	210x190x110	0,45
ORION 190 NW	BD190CCTNW0B	Ø 190x95h	NW 4000°K	1439	27	700	80°	20	Ø 160	210x210x125	0,75
ORION 228 NW	BD228CCTNW0B	Ø 228x100h	NW 4000°K	2083	21	1400	80°	34	Ø 200	255x250x130	1,20
ORION 135 WW	BD135CCTWW0B	Ø 135x70h	WW 3000°K	850	21	700	80°	15	Ø 105	150x145x80	0,30
ORION 160 WW	BD160CCTWW0B	Ø 160x75h	WW 3000°K	1190	24	700	80°	17	Ø 130	210x190x110	0,45
ORION 190 WW	BD190CCTWW0B	Ø 190x95h	WW 3000°K	1353	27	700	80°	20	Ø 160	210x210x125	0,75
ORION 228 WW	BD228CCTWW0B	Ø 228x100h	WW 3000°K	1958	21	1400	80°	34	Ø 200	255x250x130	1,20

Incasso a LED tondo ad alta potenza

- Cornice estetica e struttura dissipante in alluminio
- Grande omogeneità luminosa
- Per installazioni di tipo professionale
- Funziona in bassa tensione con trasformatore elettronico specifico a corrente costante, fornito a richiesta
- Lunga durata

Round extra powerful recessed LED downlight

- Dissipating structure and aesthetic frame in aluminium
- High brightness homogeneity
- For professional use
- Safety low voltage with specific constant current driver (supplied on request)
- Long life time

LED Rundenbastrahler

- Ästhetische Rahme und Kühlkörper aus Aluminium
- Große Lichthomogenität
- Für berufliche Installationen geeignet
- Betrieb auf Niedervolt durch besonderen elektronischen Transformator auf Konstantstrom, nur auf Anfrage
- Lange Lebensdauer

Encastrement LED rond haute puissance

- Encadrement esthétique et structure dissipante en aluminium
- Grande homogénéité lumineuse
- Pour installations de type professionnel
- Fonctionne à basse tension avec un transformateur électronique spécifique à courant constant, fourni sur demande
- Longue durée de vie

Focos empotrables a LED de alta potencia

- Estructura de disipación y marco estético en aluminio
- Alta y homogénea luminosidad
- Para uso profesional
- Baja tensión con convertidor de corriente constante específico (suministrado bajo demanda)
- Larga duración



ORION RGB



Incassi LED • LED downlights

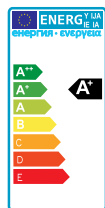

IP50 RoHS

A40RBOX350B

Type	Part N°	Dimensions (mm)	Colour	Lumen (lm)	Voltage Max (V)	Current Max (mA)	Beam °	Power Max (W)	Installation hole (mm)	Packing box dimensions (mm)	Weight (kg)
ORION 160 RGB	BD160CCTRGBB	Ø 160x75h	RGB	315	11,5	3x350 mA	80°	11	Ø 130	210x190x110	0,45
ORION 228 RGB	BD228CCTRGBB	Ø 228x100h	RGB	525	19,5	3x350 mA	80°	17	Ø 200	255x250x130	1,20

Incasso a LED RGB ad alta potenza

- Cornice estetica, struttura dissipante in alluminio, schermo diffuso
- Connettori a innesto rapidi
- Per installazioni RGB di tipo professionale
- Funziona in bassa tensione, corrente costante 350mA, con alimentatore/controller specifico (A40RBOX350B), fornito a richiesta
- Controllo con pulsante o con pannello touch (A40DMXT00000), fornito a richiesta

Round extra powerful recessed RGB LED downlight

- Dissipating structure, aesthetic frame in aluminum, anti-dazzle screen
- Quick connectors
- For professional RGB use
- Safety low voltage, constant current 350mA, with specific driver/controller specific (A40RBOX350B), supplied on request
- Controlled by push button or touch panel (A40DMXT00000), supplied on request

RGB LED Rundeinbaustrahler

- Ableitende Struktur, ästhetische Rahme aus Aluminium, Blendschutzschirm
- Steckverbindungen
- Für professionelle RGB-Einsätze
- Sicherheits-Niederspannung, Konstantstrom 350mA, mit speziellem Treiber / Controller A40RBOX350B (auf Anfrage geliefert)
- Gesteuert durch Taster oder Touch-Panel (A40DMXT00000), auf Wunsch geliefert

Caisson à LED RGB haute puissance

- Encadrement esthétique, structure dissipante en aluminium, écran diffus
- Connecteurs à branchement rapides
- Pour installations RGB de type professionnel

- Fonctionne en basse tension, courant constant 350mA, avec alimentation/contrôle particulier (A40RBOX350B), fourni sur demande
- Contrôle par bouton ou par panneau touch (A40DMXT00000), fourni sur demande

Focos empotrables a LED RGB de alta potencia

- Estructura de disipación y marco en aluminio, una pantalla evita los deslumbramientos
- Conectores rápidos
- Para uso RGB profesional
- Baja tensión (corriente constante 350mA) con convertidor/controlador específico (A40RBOX350B), suministrado bajo demanda
- Regulado a través de un pulsador o controlador táctil (A40DMXT00000), suministrado bajo demanda



A40DMXT00000

OPERA



Incassi LED • LED downlights

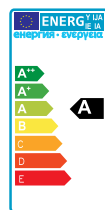

IP54 | RoHS
PHILIPS
LUMILEDS

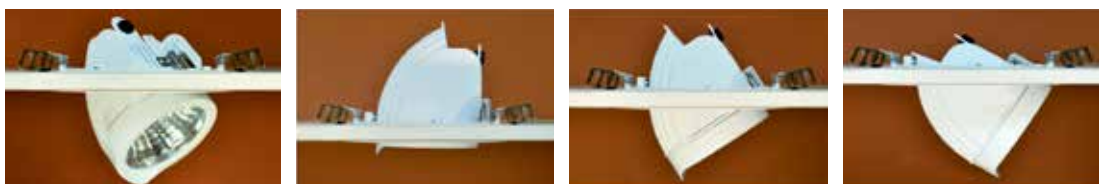

Vedere pagina 138 per i kit che includono l'alimentatore - See page 138 for kits including drivers

Type	Part N°	Dimensions (mm)	Colour	Lumen (lm)	Voltage Max (V)	Current Max (mA)	Beam °	Power Max (W)	Installation hole (mm)	Packing box dimensions (mm)	Weight (kg)
OPERA Small NW	BD19BAS0TNWB	∅ 152x125h	NW 4000°K	1935	37	500	40°	19	∅ 138	170x170x130	0,65
OPERA Large NW	BD27BAS0TNWB	∅ 186x150h	NW 4000°K	2396	38	700	50°	27	∅ 170	200x200x170	1,15
OPERA Small WW	BD19BAS0TWWB	∅ 152x125h	WW 3000°K	1811	37	500	40°	19	∅ 138	170x170x130	0,65
OPERA Large WW	BD27BAS0TWWB	∅ 186x150h	WW 3000°K	2037	38	700	50°	27	∅ 170	200x200x170	1,15

 **Incasso a LED orientabile ad alta potenza**

- Orientabile da 0° a 60°
- Grande omogeneità luminosa
- Per installazioni di tipo professionale
- Funziona in bassa tensione con trasformatore elettronico specifico fornito a richiesta
- Lunga durata

 **Adjustable round extra powerful recessed LED downlight**

- Adjustable from 0° to 60°
- High brightness homogeneity
- For professional use
- Safety low voltage with specific driver (supplied on request)
- Long life time

 **Rund High Power LED-Einbaustrahler (schwenkbar)**

- Schwenkbar ab 0° zu 60°
- Große Lichthomogenität
- Für berufliche Installationen geeignet
- Betrieb auf Niedervolt durch besonderen elektronischen Transformator auf Konstantstrom, nur auf Anfrage
- Lange Lebensdauer

 **Encastrable à LED rond orientable à haute puissance**

- Orientable de 0° à 60°
- Grande homogénéité lumineuse
- Pour installations de type professionnel
- Fonctionne à basse tension avec un transformateur électronique

- spécifique à courant constant, fourni sur demande
- Longue durée de vie

 **Focos empotrables a LED de alta potencia (ajustable)**

- Ajustable de 0° a 60°
- Alta y homogénea luminosidad
- Para uso profesional
- Baja tension con convertidor de corriente constante específico (suministrado bajo demanda)
- Larga duración



KARMA



Incassi LED • LED downlights

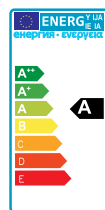

IP54 | RoHS
PHILIPS
LUMILEDS



Vedere pagina 138 per i kit che includono l'alimentatore - See page 138 for kits including drivers

Type	Part N°	Dimensions (mm)	Colour	Lumen (Lm)	Voltage Max (V)	Current Max (mA)	Beam °	Power Max (W)	Installation hole (mm)	Packing box dimensions (mm)	Weight (kg)
KARMA Small NW	BD13BASOQNWB	100x100x67h	NW 4000°K	1246	37	350	40°	13	85x85	110x170x120	0,35
KARMA Large NW	BD28BASOQNWB	145x145x110h	NW 4000°K	2513	38	700	50°	27	138x138	180x180x140	1,25
KARMA Small WW	BD13BASOQWWB	100x100x67h	WW 3000°K	1185	37	350	40°	13	85x85	110x170x120	0,35
KARMA Large WW	BD28BASOQWWB	145x145x110h	WW 3000°K	2263	38	700	50°	27	138x138	180x180x140	1,25

 **Incasso a LED quadrato orientabile ad alta potenza**

- Orientabile da 0° a 80°
- Grande omogeneità luminosa
- Per installazioni di tipo professionale
- Funziona in bassa tensione con trasformatore elettronico specifico fornito a richiesta
- Lunga durata

 **Square extra powerful recessed adjustable LED downlight**

- Adjustable from 0° to 80°
- High brightness homogeneity
- For professional use
- Safety low voltage with specific driver (supplied on request)
- Long life time

 **4-eckige High Power LED-Einbaustrahler (schwenkbar)**

- Schwenkbar ab 0° zu 80°
- Große Lichthomogenität
- Für berufliche Installationen geeignet
- Betrieb auf Niedervolt durch besonderen elektronischen Transformator auf Konstantstrom, nur auf Anfrage
- Lange Lebensdauer

 **Encastrable à LED carré orientable à haute puissance**

- Orientable de 0° à 80°
- Grande homogénéité lumineuse
- Pour installations de type professionnel
- Fonctionne à basse tension avec un transformateur électronique

spécifique à courant constant, fourni sur demande

- Longue durée de vie

 **Focos empotrables a LED de alta potencia**

- Ajustable de 0° a 80°
- Alta y homogénea luminosidad
- Para uso profesional
- Baja tensión con convertidor de corriente constante específico (suministrado bajo demanda)
- Larga duración



GIANT



Proiettori LED • LED floods

GIANT Proiettori LED • LED floods

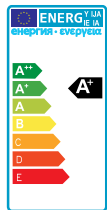

CE EN 55015 • EN 61547 • EN 61347-2-13 • EN 60598-1 • EN 61000-3-2

EMC [IP65] RoHS

Type	Part N°	Dimensions (mm)	Weight kg	LED Type	Flux (lm)	°Kelvin	Input Voltage (V)	Power Max (W)	Power Factor	Packing box Weight (kg)
GIANT 180	BF180400000A	900x340x216h	14,00	Nichia NVSW219	20000	4000°	100÷277	190	>0,95	15,50
GIANT 120	BF120400000A	520x424x226h	9,80	Nichia NVSW219	14500	4000°	100÷277	134	>0,95	10,50
GIANT 60	BF060400000A	418x340x216h	5,40	Nichia NVSW219	7300	4000°	100÷277	64	>0,95	6,00

PROIETTORE LED

- Proiettore orientabile led alta potenza
- Utilizza led NICHIA NVSW219
- Involucro IP65
- Temperatura ambiente operativa -30°C÷+55°C
- Per uso professionale
- CRI >70- Giant 60=HID150W, Giant 120=HID300W, Giant 180=HID700W

LED FLOOD

- Adjustable LED high power flood
- Equipped with NICHIA NVSW219 Led
- IP65 enclosure
- Operating temperature -30°C÷+55°C
- For professional use- CRI >70
- Giant 60=HID150W, Giant 120=HID300W, Giant 180=HID700W

LED-PROJEKTOR

- Einstellbar High Brightness LED-Projektor
- Mit LED NICHIA NVSW219 montiert
- IP65
- Betriebstemperatur: -30°C÷+55°C
- Nur für berufliche Anwendung
- CRI >70- Giant 60=HID150W, Giant 120=HID300W, Giant 180=HID700W

PROJECTEUR LED

- Projecteur orientable Led à haute puissance
- Équipé de Led NICHIA NVSW219
- IP65
- Température ambiante de fonctionnement -30°C÷+55°C
- Usage professionnel
- CRI >70- Giant 60=HID150W, Giant 120=HID300W, Giant 180=HID700W

PROYECTOR LED

- Projector LED ajustable de alta potencia
- Utiliza LED NICHIA NVSW219
- Caja IP65
- Temperatura de funcionamiento -30°C÷+55°C
- Para uso profesional
- CRI >70- Giant 60=HID150W, Giant 120=HID300W, Giant 180=HID700W

GIANT 120

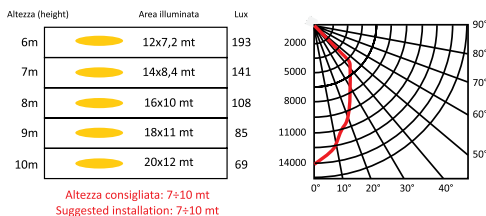

GIANT 60

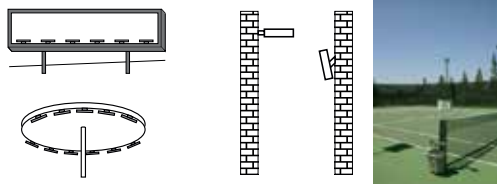
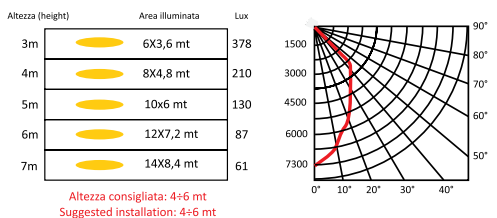

SLIM



Proiettori LED • LED floods

SLIM Proiettori LED • LED floods

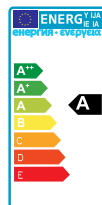

CE EN 55015 • EN 61547 • EN 61347-2-13 • EN 60598-1 • EN 61000-3-2

EMC IP65 RoHS

Type	Part N°	Dimensions	Lumen	CCT°	CRI	Power (W)	Efficiency	P.F.	N. LED
SLIM 10 Black	BFSLIM10400N	135x90x20	630	3985	>80	10	70	>0,9	10
SLIM 10 White	BFSLIM10400B	135x90x20	630	3985	>80	10	70	>0,9	10
SLIM 30 Black	BFSLIM30400N	240x163x30	2250	3985	>80	30	75	>0,9	60
SLIM 30 White	BFSLIM30400B	240x163x30	2250	3985	>80	30	75	>0,9	60
SLIM 50 Black	BFSLIM50400N	296x208x37	3700	3985	>80	50	75	>0,9	100
SLIM 50 White	BFSLIM50400B	296x208x37	3700	3985	>80	50	75	>0,9	100

Proiettore LED Slim

- Proiettore orientabile LED ad alta luminosità
- Nuovo design semplice, pulito, discreto. Adatto anche per usi interni
- Scocca in alluminio pressofuso, 2 colori disponibili, bianco e nero
- Grado di protezione IP65
- CRI >80
- Cavi 50 cm in neoprene
- 3 anni di garanzia

LED Flood

- High flux LED flood
- New clean minimal design. Suitable both for indoor and outdoor
- IP 65 die cast aluminium body, painted in black or white epoxy
- CRI >80
- 50 cm neoprene power cable
- 3 years warranty

LED Projector

- High Power schwenkbar Projektor
- Neu und klares Design - Auch für Inneninstallation geeignet
- Gussaluminiumkörper
- Schutzgrad IP 65
- CRI >80
- Netzkabel aus Neopren 50 cm
- 3 Jahren Garantie

Projecteur LED

- Projecteur orientable LED haute luminosité
- Nouveau design simple, net, discret.
- Adapté également à l'usage interne
- Corps en aluminium moulé sous pression, disponibles en deux couleurs: blanc et noir
- Degré de protection IP65
- CRI >80
- Câble d'alimentation 50 cm en Néoprène
- Garanti 3 ans

Proyector LED

- Proyector LED de alto flujo lumínico
- Nuevo diseño sencillo y minimalista. Apropriadado para aplicaciones

- de interior o exterior
- Cuerpo en aluminio fundido IP65, acabado en pintura epoxy blanco o negro
- CRI >80
- Cable de alimentación Neopreno de 50 cm
- 3 años de garantía

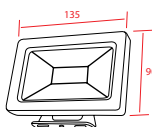

THICKNESS/SPESSORE 20

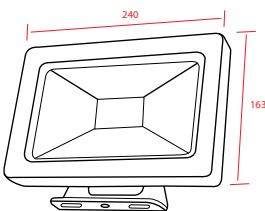

THICKNESS/SPESSORE 30

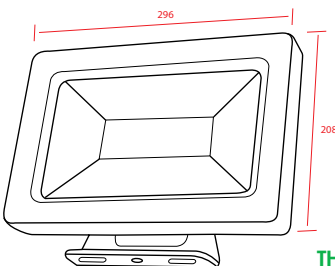

THICKNESS/SPESSORE 37

MEXICO



Proiettori LED • LED floods

MEXICO Proiettori LED • LED floods

 Made in Italy



CE EN 55015 • EN 61547 • EN 61347-2-13 • EN 60598-1 • EN 61000-3-2

EMC **IP65** RoHS 



Type	Part N°	Dimensions (mm)	Weight kg	LED Type	Flux (lm)	°Kelvin	Input Voltage (V)	Power Max (W)	Power Factor	Packing box Weight (kg)
MEXICO 15	BF3511A1540A	150x180x120h	1,100	LUMILEDS	600	4100°	100±250	15	>0,6	1,400
MEXICO 22	BF3511B2240A	200x230x150h	1,800	LUMILEDS	1250	4100°	190±265	22	>0,9	2,100
MEXICO 55	BF3511C5540A	240x280x170h	2,800	BRIDGELUX	3500	4100°	190±265	55	>0,9	3,200

 **Proiettore LED**

- Proiettore orientabile led alta potenza
- Involucro IP65
- Temperatura ambiente operativa -20°C ÷ +50°C
- Per uso professionale
- CRI >80

 **LED flood**

- Adjustable LED high power flood
- IP65 enclosure
- Operating temperature -20 °C ÷ +50°C
- For professional use
- CRI >80

 **LED-PROJEKTOR**

- Einstellbar High Brightness LED-Projektor
- IP65
- Betriebstemperatur: -20°C ÷ +50°C
- Nur für berufliche Anwendung
- CRI >80

 **Projecteur LED**

- Projecteur orientable Led à haute puissance
- IP65
- Température ambiente de fonctionnement -20°C ÷ +50°C
- Usage professionnel
- CRI >80

 **Proyector LED**

- Proyector LED ajustable de alta potencia
- Caja IP65
- Temperatura de funcionamiento -20°C ÷ +50°C
- Para uso profesional
- CRI >80



DAKOTA



Proiettori LED • LED floods

DAKOTA Proiettori LED • LED floods



CE EN 55015 • EN 61547 • EN 61347-2-13 • EN 60598-1 • EN 61000-3-2

EMC IP65 RoHS

DAKOTA 10 657 Lumen

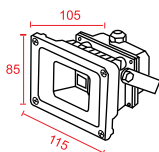

DAKOTA 30 2306 Lumen

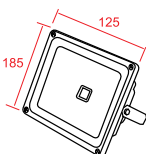

DAKOTA 50 4132 Lumen

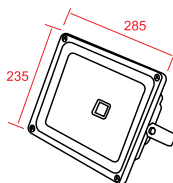

DAKOTA 70 5565 Lumen

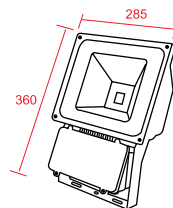

Type	Part N°	Dimensions (mm)	Weight kg	Flux (lm)	°Kelvin	Power W max)	Power (Max (W)	Packing box dimensions (mm)	Packing box Weight (kg)
DAKOTA 10	BF118510400N	115x85x105h	0,580	657	4100°	10	>0,9	100x125x100h	0,600
DAKOTA 30	BF221830400N	185x125x148h	2,150	2306	4100°	30	>0,9	235x200x145h	2,350
DAKOTA 50	BF292450400N	285x235x170h	3,500	4132	4100°	50	>0,9	310x250x170h	3,750
DAKOTA 70	BF362870400N	360x285x115h	5,500	5565	4100°	70	>0,9	365x290x118h	5,800

Proiettore LED

- Proiettore orientabile led alta potenza
- Alimentazione 95÷265V-AC 50÷60Hz
- Utilizza led BRIDGELUX
- Involucro IP65 verniciato con epossidica nera
- Temperatura ambiente operativa -20°C ÷ +50°C
- Per uso professionale
- CRI >75

LED flood

- Adjustable LED high power projector
- Power supply 95 ÷ 265V AC 50÷60Hz
- Equipped with BRIDGELUX Led
- IP65 enclosure painted with black epoxy
- Operating temperature -20°C ÷ +50°C
- For professional use
- CRI >75

LED-PROJEKTOR

- Einstellbar High Brightness LED-Projektor
- Eingang: 95÷265VAC 50÷60Hz
- Mit LED Bridgelux montiert

- Schwarz Epoxy lackierte Gehäuse - IP65
- Betriebstemperatur: -20°C ÷ +50°C
- Nur für berufliche Anwendung
- CRI >75

Projecteur LED

- Projecteur orientable Led à haute puissance
- Alimentation 95÷265V-AC 50÷60Hz
- Équipé de Led BRIDGELUX
- Finition avec du vernis epoxy noir - IP65
- Température ambiante de fonctionnement -20°C ÷ +50°C
- Usage professionnel
- CRI >75

Proyector LED

- Proyector LED ajustable de alta potencia
- Fuente de alimentación de 95 a 265V AC 50-60Hz
- Utiliza LED Bridgelux
- Caja IP65 pintada con epoxi negro
- Temperatura de funcionamiento -20°C ÷ +50°C
- Para uso profesional
- CRI >75

TORPEDO



Plafoniere stagne LED • LED waterproof fixtures

TORPEDO Plafoniere stagne LED • LED waterproof fixtures



CE EN 55015 • EN 61547 • EN 61347-2-13 • EN 60598-1 • UNI 10819:1999 • UNI 11248:2007

EMC IP65 RoHS

Kit per soffitto - Ceiling kit - Einsatzsets im Decke - Kit pour plafond - Kit para plafones



Optional - Part n°: BSKIT2CEILOC

Kit per sospensione - Suspension kit - Sets-Aufhängung - Kit suspension - Kit de suspensión



Optional - Part n°: BSKIT2X1500C

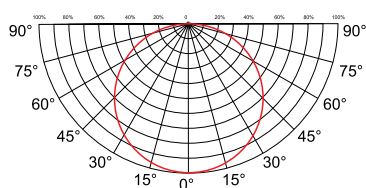
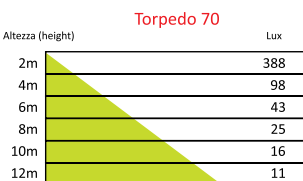
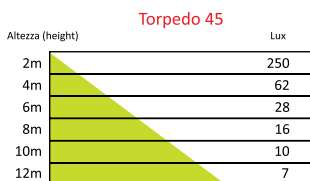

Type	Part N°	Dimensions (mm)	Input V	Weight kg	Flux (lm)	° Kelvin	Power (W max)	Beam
TORPEDO 45	BS450000400G	1180x145x65	100±240	5,90	2855 Lm	4000°K	45	120°
TORPEDO 70	BS700000400G	1180x145x65	100±240	5,90	4430 Lm	4000°K	70	120°

Plafoniera stagna LED IP65

- LED ad alta efficienza
- Sostituisce la tradizionale plafoniera stagna fluorescente
- Power Factor > 0,95
- Assenza di UV, IR, mercurio e sodio
- Accensione istantanea
- Applicazioni tipiche: uffici, aree produttive, supermercati, laboratori, etc.

LED waterproof IP65 fitting

- High efficiency LED
- Ideal replacement for fluo waterproof fitting
- Power factor >0,95
- No UV, IR, mercury or sodium
- Instant ON-OFF- Typical applications: offices, manufacturing areas, supermarkets, laboratories, etc..

IP65 LED Gerät

- High Brightness LED
- Für Ersatz von 2x58W Leuchstofflampen
- Leistungsfaktor >0,95
- UV-IR -Strahlern, Quecksilber und Natrium frei
- Sofortige Einschaltung
- Typische Anwendungen: Büros, Industriegebieten, Labors, Supermärkten usw.

Plafonnier étanche à LED IP65

- Led à haute luminosité
- Pour le remplacement de la classique 2X58W fluo
- Facteur de puissance > 0,95
- Absence d'UV, IR, mercure et sodium
- Allumage immédiat
- Utilisations typiques: bureaux, usines, supermarchés, laboratoires, etc.

Luminarias estancas LED IP65

- LED de alta eficiencia
- Ideal para reemplazar luminarias estancas fluorescentes
- Factor de potencia > 0,95
- Sin luz UV, IR, ni mercurio o sodio
- Encendido/apagado instantáneo
- Instalaciones típicas: Oficinas, fábricas, supermercados, laboratorios, etc.



FUTURA



Plafoniere stagne LED • LED waterproof fixtures

FUTURA Plafoniere stagne LED • LED waterproof fixtures



For LED tubes ONE SIDE INPUT ONLY

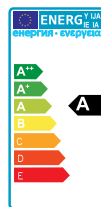

CE EN 55015 • EN 61547 • EN 61347-2-13 • EN 60598-1 • UNI 10819:1999 • UNI 11248:2007

EMC IP65 RoHS



Type	Part N°	Dimensions (mm)	Net weight kg	Suggested LED tube (one side input)	Packing Unit (pcs)	Packing unit dimensions (mm)	Packing unit weight Gross (kg)
FUTURA 60	BS1X0600000B	655x90x90h	0,8	1x60 cm	10	680x190x350h	10,0
FUTURA 120	BS1X1200000B	1265x90x90h	1,5	1x120 cm	6	1290x190x220h	8,1
FUTURA 150	BS1X1500000B	1565x90x90h	1,8	1x150 cm	6	1590x190x220h	13,0
FUTURA TWIN 60	BS2X0600000B	655x125x90h	1,0	2x60 cm	8	680x270x280h	10,6
FUTURA TWIN 120	BS2X1200000B	1265x125x90h	2,0	2x120 cm	6	1290x210x270h	13,0
FUTURA TWIN 150	BS2X1500000B	1565x125x90h	2,4	1x150 cm	6	1590x210x270h	17,4

Vedere pagina 138 per i kit che includono la lampadina LED - See page 138 for kits including LED lamp

🇮🇹 Plafoniera stagna LED IP65 per tubi LED

- Per utilizzo esclusivo con tubi elettronici a LED alimentati su di un solo lato
- Sostituisce la tradizionale plafoniera stagna fluorescente
- Schermo in Policarbonato, clips di chiusura INOX
- Applicazioni tipiche: uffici, aree produttive, supermercati, laboratori, etc.
- Versione con Tubi LED disponibile

🇬🇧 LED tube waterproof IP65 fitting

- To be used with LED electronic tubes with single side input only
- Ideal replacement for traditional fluo waterproof fitting
- Polycarbonate cover, closing clips in stainless steel
- Typical applications: offices, manufacturing areas, supermarkets, laboratories, etc.
- Version with LED tubes available

🇩🇪 IP65 wassergedichte Led-Leuchte

- Nur mit Led-Leuchten mit einseitiger speisung verwenden
- Für Ersatz von Standard wassergedichten Leuchtstofflampen geeignet
- Schirm aus Polycarbonat und Verschlussklammern aus Edelstahl
- Typische Anwendungen: Büros, Industriegebieten, Labors, Supermärkten usw
- Ausführung mit Led Röhren auch verfügbar

🇫🇷 Plafonnier étanche à LED IP65 pour tubes a LED

- Utilisation qu'avec des tubes électroniques a LED alimentés d'une seule côté
- Remplace le plafonnier étanche avec fluorescence
- Reflecteur en polycarbonate, clips de fermeture en INOX
- Utilisations typiques: bureaux, usines, supermarchés, laboratoires
- Disponible aussi une version avec tubes Led intégrés

🇪🇸 Luminarias estancas para tubos LED IP65

- Use sólo tubos electrónicos de LED alimentados en un solo lado
- Ideal para reemplazar luminarias estancas fluorescentes
- Pantalla de Policarbonato, clips de acero inoxidable
- Instalaciones típicas: oficinas, fábricas, supermercados, laboratorios, etc.
- Versiónes con tubos de LED incluidos disponibles

BILLY the LED



Plafoniere LED • LED fixtures

BILLY the LED Plafoniere LED • LED fixtures



CE EN 55015 • EN 61547 • EN 61347-2-13 • EN 60598-1 • EN 61000-3-2

EMC IP50 RoHS

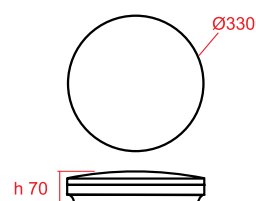
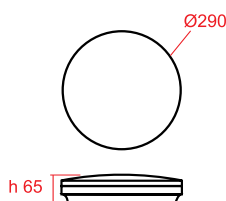
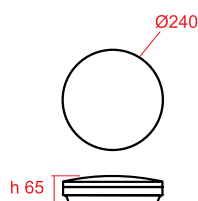

Type	Part N°	Dimensions (mm)	Light Colour	° Kelvin (±10%)	Lumen	Power (W)	Input (V)	CRI	IP	Packing box dimensions (mm)	Weight (kg)
BILLY 10	BIL50241040B	Ø240x65h	NW	4200°K	890	10±1	100÷240 AC	>80	IP50	245x245x69h	0,60
BILLY 15	BIL50291540B	Ø290x65h	NW	4200°K	1240	15±1	100÷240 AC	>80	IP50	306x306x69h	0,83
BILLY 20	BIL50332040B	Ø330x70h	NW	4200°K	1680	20±1	100÷240 AC	>80	IP50	355x355x75h	1,07
BILLY 10	BIL50241030B	Ø240x65h	VV	3000°K	872	10±1	100÷240 AC	>80	IP50	245x245x69h	0,60
BILLY 15	BIL50291530B	Ø290x65h	VV	3000°K	1215	15±1	100÷240 AC	>80	IP50	306x306x69h	0,83
BILLY 20	BIL50332030B	Ø330x70h	VV	3000°K	1646	20±1	100÷240 AC	>80	IP50	355x355x75h	1,07

Plafoniere LED

- Struttura in Policarbonato bianco e schermo in PMMA
- Grande omogeneità luminosa
- Funziona in bassa tensione con trasformatore incorporato
- Consumo molto limitato
- Lunga durata

LED Fixture

- Structure and frame in Polycarbonate, PMMA screen
- Homogeneous light output
- Safety low voltage with specific included driver
- Limited consumption
- Long life time

Led Anbau-Leuchte

- Struktur in weißem Polycarbonat und PMMA Bildschirm
- Homogenes Licht
- NV-Betrieb durch besonderen Transformator
- Begrenzter Verbrauch
- Lange Lebensdauer

Plafonniers LED

- Corps en Polycarbonate blanc et reflecteur en PMMA
- Luminosité très homogène
- Il marche en basse tension avec alimentation intégrée
- Consommation très limitée
- Longue durée de vie

Lamparas de techo/pared LED

- Estructura de policarbonado blanco y pantalla en PMMA
- Excelente homogeneidad luminica
- Alta seguridad por funcionamiento a baja tension, con transformador integrado
- Consumo muy limitado
- Larga vida



AQUA



Plafoniere LED • LED fixtures

AQUA Plafoniere LED • LED fixtures



CE EN 55015 • EN 61547 • EN 61347-2-13 • EN 60598-1 • EN 61000-3-2

EMC IP54 RoHS

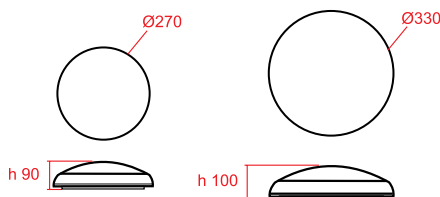

Type	Part N°	Dimensions (mm)	Light Colour	° Kelvin (±10%)	Lumen	Power (W)	Input (V)	CRI	IP	Packing box dimensions (mm)	Weight (kg)
AQUA 10 NW	BIL271040IPB	Ø270x90h	NW	4200°K	890	10±1	100÷240 AC	>80	IP54	250x250x110h	0,80
AQUA 20 NW	BIL322040IPB	Ø330x100h	NW	4200°K	1680	20±1	100÷240 AC	>80	IP54	360x360x110h	1,10
AQUA 10 WW	BIL271030IPB	Ø270x90h	WW	3000°K	872	10±1	100÷240 AC	>80	IP54	250x250x110h	0,80
AQUA 20 WW	BIL322030IPB	Ø330x100h	WW	3000°K	1646	20±1	100÷240 AC	>80	IP54	360x360x110h	1,10

🇮🇹 Plafoniera LED per uso esterno IP54

- Struttura in Policarbonato bianco e schermo in PMMA
- Grande omogeneità luminosa
- Funziona in bassa tensione con trasformatore incorporato
- Consumo molto limitato
- Lunga durata

🇬🇧 IP54 LED fixture for outdoor use

- Structure and frame in Polycarbonate, PMMA screen
- Homogeneous light output
- Safety low voltage with specific included driver
- Limited consumption
- Long life time

🇩🇪 LED Anbau-Leuchte für Außeninstallation IP54

- Struktur in weißem Polycarbonat und PMMA Bildschirm
- Homogenes Licht
- NV-Betrieb durch besonderen Transformator
- Begrenzter Verbrauch
- Lange Lebensdauer

🇫🇷 Plafonniers LED pour l'extérieur IP54

- Corps en Polycarbonate blanc et reflecteur en PMMA
- Luminosité très homogène
- Il marche en basse tension avec alimentation intégrée
- Consommation très limitée
- Longue durée de vie

🇪🇸 Lamparas de techo/pared LED IP54

- Estructura de policarbonado blanco y pantalla en PMMA
- Excelente homogeneidad luminica
- Alta seguridad por funcionamiento a baja tension, con transformador integrado
- Consumo muy limitado
- Larga vida



ZEROflat IP54



Plafoniere LED • LED fixtures

ZEROflat IP54 Plafoniere LED • LED fixtures

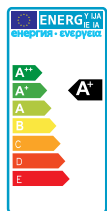

CE EN 55015 • EN 61547 • EN 61347-2-13 • EN 60598-1 • EN 61000-3-2

PF > 0,92 EMC IP54 RoHS

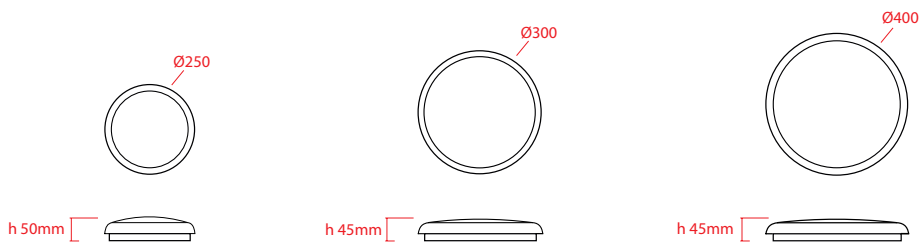

Type	Part N°	Dimensions (mm)	Light Colour	° Kelvin (±10%)	Lumen	Power (W)	Input (V)	CRI	IP	Packing box dimensions (mm)	Weight (kg)
ZERO 25 NW	BZERO25012NW	Ø250	NW	4100°K	1069	12	100÷240 AC	>85	65	260x260x60	0,80
ZERO 30 NW	BZERO30025NW	Ø300	NW	4100°K	2191	25	100÷240 AC	>85	65	310x310x55	1,15
ZERO 40 NW	BZERO40030NW	Ø400	NW	4100°K	2506	30	100÷240 AC	>85	65	410x410x60	1,75
ZERO 25 WW	BZERO25012WW	Ø250	WW	3000°K	1012	12	100÷240 AC	>85	65	260x260x60	0,80
ZERO 30 WW	BZERO30025WW	Ø300	WW	3000°K	2106	25	100÷240 AC	>85	65	310x310x55	1,15
ZERO 40 WW	BZERO40030WW	Ø400	WW	3000°K	2425	30	100÷240 AC	>85	65	410x410x60	1,75

🇮🇹 Plafoniera LED per uso esterno IP54

- Struttura in Policarbonato bianco e schermo in PMMA
- Grande omogeneità luminosa
- Funziona in bassa tensione con trasformatore incorporato
- Consumo molto limitato
- Lunga durata

🇬🇧 IP54 LED fixture for outdoor use

- Structure and frame in Polycarbonate, PMMA screen
- Homogeneous light output
- Safety low voltage with specific included driver
- Limited consumption
- Long life time

🇩🇪 LED Anbau-Leuchte für Außeninstallation IP54

- Struktur in weißem Polycarbonat und PMMA Bildschirm
- Homogenes Licht
- NV-Betrieb durch besonderen Transformator
- Begrenzter Verbrauch
- Lange Lebensdauer

🇫🇷 Plafonniers LED pour l'extérieur IP54

- Corps en Polycarbonate blanc et réflecteur en PMMA
- Luminosité très homogène
- Il marche en basse tension avec alimentation intégrée
- Consommation très limitée
- Longue durée de vie

🇪🇸 Lamparas de techo/pared LED IP54

- Estructura de policarbonado blanco y pantalla en PMMA
- Excelente homogeneidad luminica
- Alta seguridad por funcionamiento a baja tension, con transformador integrado
- Consumo muy limitado
- Larga vida



JAZZflat IP54



Plafoniere LED • LED fixtures

JAZZflat IP54 Plafoniere LED • LED fixtures

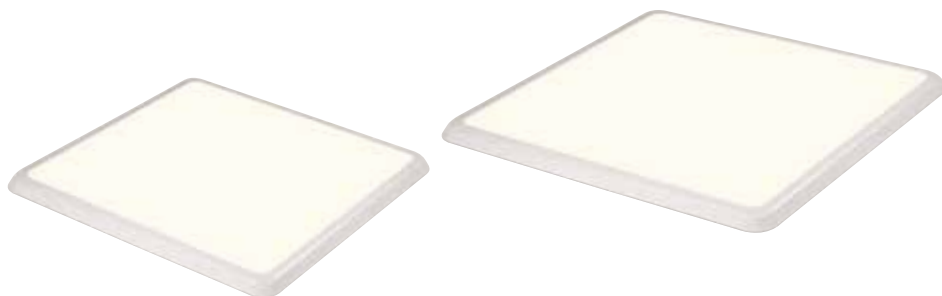

CE EN 55015 • EN 61547 • EN 61347-2-13 • EN 60598-1 • EN 61000-3-2

PF > 0,92 EMC IP54 RoHS

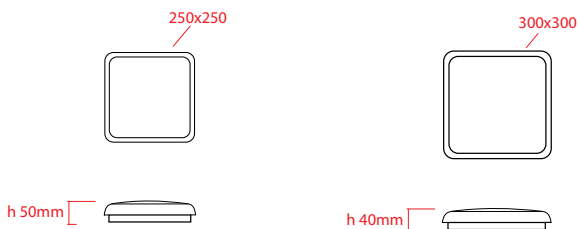

Type	Part N°	Dimensions (mm)	Light Colour	° Kelvin (±10%)	Lumen	Power (W)	Input (V)	CRI	IP	Packing box dimensions (mm)	Weight (kg)
JAZZ 25 NW	BJAZZQ2512NW	250x250	NW	4200°K	1058	12	100÷240 AC	>85	65	260x260x60	0,90
JAZZ 30 NW	BJAZZQ3025NW	300x300	NW	4200°K	2173	25	100÷240 AC	>85	65	260x260x60	0,90
JAZZ 25 WW	BJAZZQ2512WW	250x250	WW	3000°K	1052	12	100÷240 AC	>85	65	310x310x60	1,23
JAZZ 30 WW	BJAZZQ3025WW	300x300	WW	3000°K	2150	25	100÷240 AC	>85	65	310x310x60	1,23

🇮🇹 Plafoniera LED per uso esterno IP54

- Struttura in Policarbonato bianco e schermo in PMMA
- Grande omogeneità luminosa
- Funziona in bassa tensione con trasformatore incorporato
- Consumo molto limitato
- Lunga durata

🇬🇧 IP54 LED fixture for outdoor use

- Structure and frame in Polycarbonate, PMMA screen
- Homogeneous light output
- Safety low voltage with specific included driver
- Limited consumption
- Long life time

🇩🇪 LED Anbau-Leuchte für Außeninstallation IP54

- Struktur in weißem Polycarbonat und PMMA Bildschirm
- Homogenes Licht
- NV-Betrieb durch besonderen Transformator
- Begrenzter Verbrauch
- Lange Lebensdauer

🇫🇷 Plafonniers LED pour l'extérieur IP54

- Corps en Polycarbonate blanc et réflecteur en PMMA
- Luminosité très homogène
- Il marche en basse tension avec alimentation intégrée
- Consommation très limitée
- Longue durée de vie

🇪🇸 Lamparas de techo/pared LED IP54

- Estructura de policarbonado blanco y pantalla en PMMA
- Excelente homogeneidad luminica
- Alta seguridad por funcionamiento a baja tension, con transformador integrado
- Consumo muy limitado
- Larga vida



ZEUS

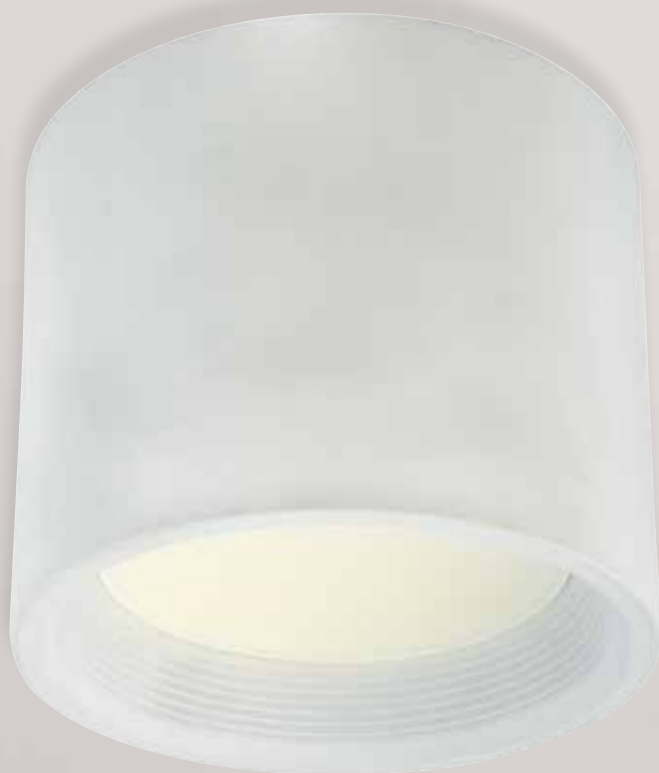

Plafoniere LED • LED fixtures

ZEUS Plafoniere LED • LED fixtures

Made in Italy



CE EN 55015 • EN 61547 • EN 61347-2-13 • EN 60598-1 • EN 61000-3-2

EMC IP54 RoHS

Type	Part N°	Dimensions (mm)	Light Colour	° Kelvin (±10%)	Lumen	Power (W)	Input (V)	P.F.	CRI	Packing box dimensions (mm)	Weight (kg)
ZEUS Small NW	BPC130CCTNW	Ø130x105h	NW	4200°K	835	13	100÷240 AC	>0,84	>80	130x130x120h	0,55
ZEUS Med NW	BPC165CCTNW	Ø165x120h	NW	4200°K	1623	24	100÷240 AC	>0,92	>80	180x180x130h	0,85
ZEUS Large NW	BPC200CCTNW	Ø200x130h	NW	4200°K	2344	32	100÷240 AC	>0,92	>80	210x210x140h	1,25
ZEUS Small WW	BPC130CCTWW	Ø130x105h	WW	3000°K	785	13	100÷240 AC	>0,84	>80	130x130x120h	0,55
ZEUS Med WW	BPC165CCTWW	Ø165x120h	WW	3000°K	1525	24	100÷240 AC	>0,92	>80	180x180x130h	0,85
ZEUS Large WW	BPC200CCTWW	Ø200x130h	WW	3000°K	2203	32	100÷240 AC	>0,92	>80	210x210x140h	1,25

Plafoniera LED

- Struttura in alluminio verniciato
- Grande omogeneità luminosa
- Funziona in bassa tensione con trasformatore incorporato
- Consumo molto limitato
- Lunga durata

LED ceiling fixture

- Painted aluminum structure
- Homogeneous light output
- Safety low voltage with specific included driver
- Limited consumption
- Long life time

LED Anbau-Leuchte

- Structure en aluminium vernis
- Luminosité très homogène
- Il marche en basse tension avec alimentation intégrée
- Consommation tres limitée
- Longue durée de vie

Plafonniers LED

- Corps en Polycarbonate blanc et reflecteur en PMMA
- Luminosité très homogène
- Il marche en basse tension avec alimentation intégrée
- Consommation tres limitée
- Longue durée de vie

Lamparas de techo/pared LED

- Estructura de aluminio pintado
- Excelente homogeneidad luminica
- Alta seguridad por funcionamiento a baja tension, con transformador integrado
- Consumo muy limitado
- larga vida

HIGH BAY 100



Campane LED • LED High Bay

HIGH BAY 100 Campane LED • LED High Bay



CE EN 55015 • EN 61547 • EN 61347-2-13 • EN 60598-1 • UNI 10819:1999 • UNI 11248:2007

EMC IP30 IP54 RoHS

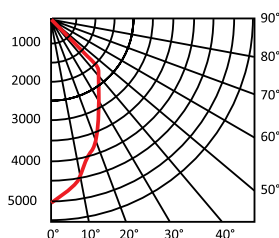

Altezza (height)	Raggio luminoso	Lux
6m	6m	190
7m	7m	150
8m	8m	115
9m	9m	90
10m	10m	70
11m	11m	60
12m	12m	50
13m	13m	40

Altezza consigliata: 8÷10 mt
Suggested installation: 8÷10 mt

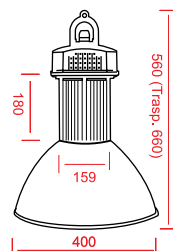

Type	Part N°	IP	Dimensions (mm)	Input V	Weight kg	LED (Bridgelux)	Flux (lm)	° Kelvin	Campana Bell	Power (W max)	Beam	CRI
HIGH BAY100	BC100B40000A	IP30	400x400x560h	90÷264	5,00	1	6500 Lm	4000°K	Aluminium	100	90°	70
HIGH BAY100	BC100B40000T	IP30	400x400x660h	90÷264	5,00	1	6500 Lm	4000°K	Transparent	100	90°	70
HIGH BAY100	BC100B4IP54A	IP54	400x400x560h	90÷264	5,00	1	6500 Lm	4000°K	Aluminium	100	90°	70
HIGH BAY100	BC100B4IP54T	IP54	400x400x660h	90÷264	5,00	1	6500 Lm	4000°K	Transparent	100	90°	70

Disponibili files ottici Eulumdat (.ldt) e IESNA (.ies) • Available files: Eulumdat (.ldt) and IESNA (.ies) • Eulumdat (.ldt) und IESNA (.ies) files verfügbar
Documentation disponible: Eulumdat (.ldt) et IESNA (.ies) • Disponibles archives: Eulumdat (.ldt) e IESNA (.ies)

Campana a LED

- LED ad alta efficienza Bridgelux
- Stessa quantità di luce di 250W ioduri metallici
- Power Factor > 0,9
- Assenza di UV, IR, mercurio e sodio
- Accensione istantanea
- Applicazioni tipiche: magazzini, aree produttive, supermercati, palestre, lavorazione cibi, celle frigorifere, etc.

High power LED high bay

- Bridgelux high efficiency LED
- Ideal replacement for 250W HID
- Power factor >0,9
- No UV, IR, mercury or sodium
- Instant ON-OFF
- Typical applications: warehouse, manufacturing, floodlighting, gymnasium, food processing, cold storage, etc.

High power LED high bay

- High Brightness LED BRIDGELUX
- Gleiche Helligkeit einer 250W Halogen-Metall dampflampe
- Leistungsfaktor: >0,9
- Abwesenheit von UV, IR, Quecksilber und Natrium
- Sofortanschlaltung
- Typische Anwendungen: Lagerhallen, Produktionsstätten
- Supermärkten, Fitness Centre, Lebensmittelverarbeitung, Kühlhaus usw.

Suspension à LED BRIDGELUX haute efficacité

- À comparer avec la quantité de lumière d'une lampe iodure métallique 250W
- Facteur de puissance > 0,9
- LED Bridgelux- Anibsenche de UV, IR, mercure et sodium
- Allumage immediate
- Applications: magasins, usines, supermarchés, gymnases, chambres frigorifiques, etc.

Campanas industriales con LED de alta potencia

- Led Bridgelux de alta eficiencia
- Misma cantidad de luz que una lámpara HID de 250W
- Factor de potencia > 0,9
- No UV, IR, Mercurio o sodio
- Encendido y apagado instantaneo
- Aplicaciones típicas: Almacenes, fábricas, supermercados, gimnasios, almacenes de frio, etc.



HIGH BAY 150



Campane LED • LED High Bay

HIGH BAY 150 Campane LED • LED High Bay

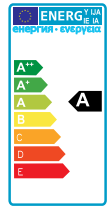

CE EN 55015 • EN 61547 • EN 61347-2-13 • EN 60598-1 • UNI 10819:1999 • UNI 11248:2007

EMC IP30 IP54 RoHS

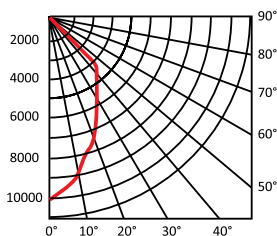

Altezza (height)	Raggio luminoso	Lux
8m	8m	180
9m	9m	145
10m	10m	120
11m	11m	95
12m	12m	80
13m	13m	70
14m	14m	60
15m	15m	40

Altezza consigliata: 10÷14 mt
Suggested installation: 10÷14 mt

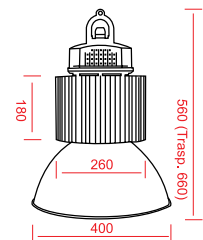

Type	Part N°	IP	Dimensions (mm)	Input V	Weight kg	LED (Bridgelux)	Flux (lm)	° Kelvin	Campana Bell	Power (W max)	Beam	CRI
HIGH BAY150	BC150B40000A	IP30	400x400x560h	90÷264	8,00	4	10500 Lm	4000°K	Aluminium	150	90°	70
HIGH BAY150	BC150B40000T	IP30	400x400x660h	90÷264	8,00	4	10500 Lm	4000°K	Transparent	150	90°	70
HIGH BAY150	BC150B4IP54A	IP54	400x400x560h	90÷264	8,00	4	10500 Lm	4000°K	Aluminium	150	90°	70
HIGH BAY150	BC150B4IP54T	IP54	400x400x660h	90÷264	8,00	4	10500 Lm	4000°K	Transparent	150	90°	70

Disponibili files ottici Eulumdat (.ldt) e IESNA (.ies) • Available files: Eulumdat (.ldt) and IESNA (.ies) • Eulumdat (.ldt) und IESNA (.ies) files verfügbar
Documentation disponible: Eulumdat (.ldt) et IESNA (.ies) • Disponibles archives: Eulumdat (.ldt) e IESNA (.ies)

Campana a LED

- LED ad alta efficienza Bridgelux
- Stessa quantità di luce di 400W ioduri metallici
- Power Factor > 0,9
- Assenza di UV, IR, mercurio e sodio
- Accensione istantanea
- Applicazioni tipiche: magazzini, aree produttive, supermercati, palestre, lavorazione cibi, celle frigorifere, etc.

High power LED high bay

- Bridgelux high efficiency LED
- Ideal replacement for 400W HID
- Power factor >0,9
- No UV, IR, mercury or sodium
- Instant ON-OFF
- Typical applications: warehouse, manufacturing, floodlighting, gymnasium, food processing, cold storage, etc.

High power LED high bay

- High Brightness LED BRIDGELUX
- Gleiche Helligkeit einer 400W Halogen-Metall dampflampe
- Leistungsfaktor: >0,9
- Abwesenheit von UV, IR, Quecksilber und Natrium
- Sofortanschlaltung
- Typische Anwendungen: Lagerhallen, Produktionsstätten
- Supermärkten, Fitness Centre, Lebensmittelverarbeitung, Kühlhaus usw.

Suspension à LED BRIDGELUX haute efficacité

- À comparer avec la quantité de lumière d'une lampe iodure métallique 400W
- Facteur de puissance > 0,9
- LED Bridgelux- Anibsen de UV, IR, mercure et sodium
- Allumage immediate
- Applications: magasins, usines, supermarchés, gymnases, chambres frigorifiques, etc.

Campanas industriales con LED de alta potencia

- Led Bridgelux de alta eficiencia
- Misma cantidad de luz que una lámpara HID de 400W
- Factor de potencia > 0,9
- No UV, IR, Mercurio o sodio
- Encendido y apagado instantaneo
- Aplicaciones típicas: Almacenes, fábricas, supermercados, gimnasios, almacenes de frio, etc.



HIGH BAY 200



Campane LED • LED High Bay

HIGH BAY 200 Campane LED • LED High Bay



CE EN 55015 • EN 61547 • EN 61347-2-13 • EN 60598-1 • UNI 10819:1999 • UNI 11248:2007

EMC IP30 IP54 RoHS

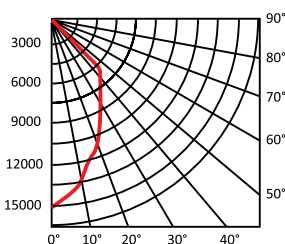

Altezza (height)	Raggio luminoso	Lux
10m	10m	180
11m	11m	150
12m	12m	125
13m	13m	115
14m	14m	90
15m	15m	80
16m	16m	70
17m	17m	50

Altezza consigliata: 12÷16 mt
Suggested installation: 10÷16 mt

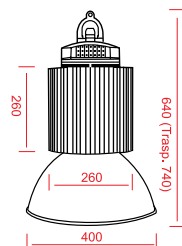

Type	Part N°	IP	Dimensions (mm)	Input V	Weight kg	LED (Bridgelux)	Flux (lm)	° Kelvin	Campana Bell	Power (W max)	Beam	CRI
HIGH BAY200	BC200B40000A	IP30	400x400x640h	90÷264	11,00	4	14000 Lm	4000°K	Aluminium	200	90°	70
HIGH BAY200	BC200B40000T	IP30	400x400x740h	90÷264	11,00	4	14000 Lm	4000°K	Transparent	200	90°	70
HIGH BAY200	BC200B4IP54A	IP54	400x400x640h	90÷264	11,00	4	14000 Lm	4000°K	Aluminium	200	90°	70
HIGH BAY200	BC200B4IP54T	IP54	400x400x740h	90÷264	11,00	4	14000 Lm	4000°K	Transparent	200	90°	70

Disponibili files ottici Eulumdat (.ldt) e IESNA (.ies) • Available files: Eulumdat (.ldt) and IESNA (.ies) • Eulumdat (.ldt) und IESNA (.ies) files verfügbar
Documentation disponible: Eulumdat (.ldt) et IESNA (.ies) • Disponibles archives: Eulumdat (.ldt) e IESNA (.ies)

Campana a LED

- LED ad alta efficienza Bridgelux
- Stessa quantità di luce di 700W ioduri metallici
- Power Factor > 0,9
- Assenza di UV, IR, mercurio e sodio
- Accensione istantanea
- Applicazioni tipiche: magazzini, aree produttive, supermercati, palestre, lavorazione cibi, celle frigorifere, etc.

High power LED high bay

- Bridgelux high efficiency LED
- Ideal replacement for 700W HID
- Power factor >0,9
- No UV, IR, mercury or sodium
- Instant ON-OFF
- Typical applications: warehouse, manufacturing, floodlighting, gymnasium, food processing, cold storage, etc.

High power LED high bay

- High Brightness LED BRIDGELUX
- Gleiche Helligkeit einer 700W Halogen-Metall dampflampe
- Leistungsfaktor: >0,9
- Abwesenheit von UV, IR, Quecksilber und Natrium
- Sofortanschtaltung
- Typische Anwendungen: Lagerhallen, Produktionsstätten
- Supermärkten, Fitness Centre, Lebensmittelverarbeitung, Kühlhaus usw.

Suspension à LED BRIDGELUX haute efficacité

- À comparer avec la quantité de lumière d'une lampe iodure métallique 700W
- Facteur de puissance > 0,9
- LED Bridgelux- Anibsenche de UV, IR, mercure et sodium
- Allumage immediate
- Applications: magasins, usines, supermarchés, gymnases, chambres frigorifiques, etc.

Campanas industriales con LED de alta potencia

- Led Bridgelux de alta eficiencia
- Misma cantidad de luz que una lámpara HID de 700W
- Factor de potencia > 0,9
- No UV, IR, Mercurio o sodio
- Encendido y apagado instantaneo
- Aplicaciones típicas: Almacenes, fábricas, supermercados, gimnasios, almacenes de frio, etc.



HIGH BAY EVO



Campane LED • LED High Bay

HIGH BAY EVO Campane LED • LED High Bay



EN 55015 • EN 61547 • EN 61347-2-13 • EN 60598-1 • UNI 10819:1999 • UNI 11248:2007



EMC IP30 IP65 RoHS

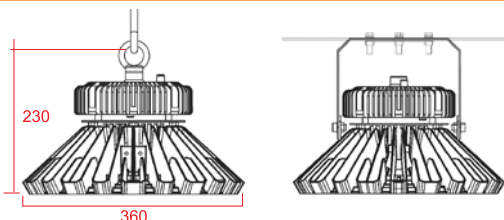

Type	Part N°	IP	Dimensions (mm)	Input V	Weight kg	LED (Bridgelux)	Flux (lm)	° Kelvin	Power (W max)	Beam	CRI
HB EVO 100	BC100EB4000N	IP30	360x360x230h	100±277	6,60	40	>9000 Lm	4000°K	100	120°	>80
HB EVO 120	BC120EB4000N	IP30	360x360x230h	100±277	6,60	50	>12000 Lm	4000°K	120	120°	>80
HB EVO 150	BC150EB4000N	IP30	360x360x230h	100±277	6,60	60	>15000 Lm	4000°K	150	120°	>80
HB EVO 180	BC180EB4000N	IP30	360x360x230h	100±277	6,60	100	>17000 Lm	4000°K	180	120°	>80
HB EVO 200	BC200EB4000N	IP30	360x360x230h	100±277	6,60	100	>19000 Lm	4000°K	200	120°	>80
HB EVO 100	BC100E4IP65N	IP65	360x360x230h	100±277	6,60	40	>9000 Lm	4000°K	100	120°	>80
HB EVO 120	BC120E4IP65N	IP65	360x360x230h	100±277	6,60	50	>12000 Lm	4000°K	120	120°	>80
HB EVO 150	BC150E4IP65N	IP65	360x360x230h	100±277	6,60	60	>15000 Lm	4000°K	150	120°	>80
HB EVO 180	BC180E4IP65N	IP65	360x360x230h	100±277	6,60	100	>17000 Lm	4000°K	180	120°	>80

Disponibili files ottici Eulumdat (.ldt) e IESNA (.ies) •
 Available files: Eulumdat (.ldt) and IESNA (.ies) •
 Disponibles archives: Eulumdat (.ldt) et IESNA (.ies) files verfügbar •
 Documentation disponible: Eulumdat (.ldt) et IESNA (.ies) •
 Disponibles archives: Eulumdat (.ldt) e IESNA (.ies)

Campana a LED IP30/IP65

- LED ad alta efficienza Nichia
- Power Factor > 0,95
- Assenza di UV, IR, mercurio e sodio
- Accensione istantanea
- Applicazioni tipiche: magazzini, aree produttive, supermercati, palestre, lavorazione cibi, celle frigorifere, etc.

High power IP30/IP65 LED High Bay

- Nichia high efficiency LED
- Power factor >0,95- No UV, IR, mercury or sodium
- Instant ON-OFF
- Typical applications: warehouse, manufacturing, floodlighting, gymnasium, food processing, cold storage, etc.

High power LED High Bay IP30/IP65

- High Brightness LED Nichia
- Leistungsfaktor: >0,95
- Abwesenheit von UV, IR, Quecksilber und Natrium
- Sofortanschaltung
- Typische Anwendungen: Lagerhallen, Produktionsstätten,

Supermärkten, Fitness Centre, Lebensmittelverarbeitung, Kühlhaus usw.

Suspension à LED BRIDGELUX haute efficacité IP30/IP65

- Facteur de puissance > 0,95 - LED Nichia
- Absence de UV, IR, mercure et sodium
- Allumage immédiate
- Applications: magasins, usines, supermarchés, gymnases, chambres frigorifiques, etc.

Campanas industriales con LED de alta potencia IP30/IP65

- Led Nichia de alta eficiencia
- Factor de potencia > 0,95
- No UV, IR, Mercurio o sodio
- Encendido y apagado instantaneo
- Aplicaciones típicas: Almacenes, fábricas, supermercados, gimnasios, almacenes de frio, etc.

ALASKA 30

TEXAS 60



Lampioni LED • LED street lights

ALASKA 30 - TEXAS 60 Lampioni LED • LED street lights

Made in Italy

S3 Road Class
S4 Road Class



CE3 Road Class
CE4 Road Class
S1 Road Class
S2 Road Class

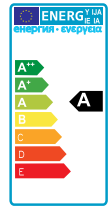

LUMILEDS

EMC IP65 RoHS

CE EN 55015 • EN 61547 • EN 61347-2-13 • EN 60598-1 • UNI 10819:1999 • UNI 11248:2007 • UNI EN 13201-1-2-3-4:2004

ALASKA 30

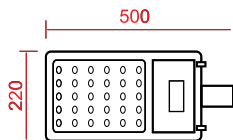

TEXAS 60

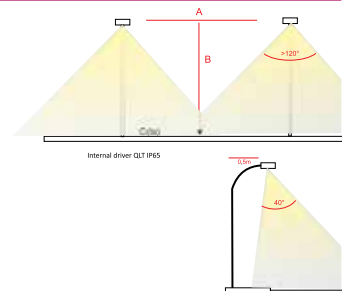
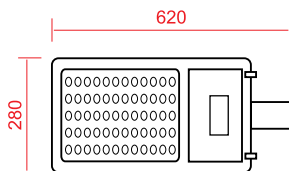

Type	Part N°	Dimensions (mm)	Weight (kg)	LED (Rebel ES)	Flux (lm)	°Kelvin	Power (W max)	Pole Ø (mm)	Packing box dimensions (mm)	Packing box Weight (kg)
ALASKA 30	BL010740030G	220x500x55h	3,3	30	30x105Lm	4000°	37	60	500x250x170	4
ALASKA 30	BL010750030G	220x500x55h	3,3	30	30x105Lm	5000°	37	60	500x250x170	4
TEXAS 60	BL011140060G	280x620x100h	6,5	60	60x105Lm	4000°	74	50÷60	600x380x240	7,5
TEXAS 60	BL011150060G	280x620x100h	6,5	60	60x105Lm	5000°	74	50÷60	600x380x240	7,5

Disponibili files ottici Eulumdat (.ldt) e IESNA (.ies) • Available files: Eulumdat (.ldt) and IESNA (.ies) • Eulumdat (.ldt) und IESNA (.ies) files verfügbar • Documentation disponible: Eulumdat (.ldt) et IESNA (.ies) • Disponibles archives: Eulumdat (.ldt) e IESNA (.ies)

LED street light

- Lampione stradale a Led per pali Ø 60 asse orizzontale
- Alimentazione universale 100÷250V-AC 50÷60Hz
- Power factor >0,95
- Involucro IP65 verniciato con epossidica grigia
- Temperatura ambiente operativa -20°C ÷ +50°C
- Utilizza Led Rebel ES ANSI

LED street light

- Led street light for poles Ø 60mm horizontal axis
- Universal input: 100÷250V AC 50÷60Hz
- Power factor >0,95- IP65 case and epoxy grey painting
- Working range: -20°C ÷ +50°C
- Equipped with led Rebel ES ANSI

Street light LED

- Straßenleuchte für Rohr-Durchmesser Ø 60mm horizontale axe
- Universale Eingangsspannung: 100÷250V AC 50÷60Hz
- Leistungsfaktor: >0,95
- Graue Epoxy-Lackierung – IP65
- Betriebstemperatur: -20°C ÷ +50°C
- Mit led Rebel ES ANSI

LED street light

- Lampadaire à led pour des mats de Ø 60mm axe horizontal
- Alimentation universelle: 100÷250V AC 50÷60Hz
- Facteur de puissance: >0,95
- Finition avec du vernis epoxy gris – IP65
- Température de fonctionnement: -20°C ÷ +50°C
- Equipé de led Rebel ES ANSI

LED street light

- Alumbrado public por led para postes Ø 60mm eje horizontal
- Entrada universal: 100÷250V AC 50÷60Hz
- Factor de potencia: >0,95
- Caja IP65 y pintura de epoxy gris
- Temperatura de funcionamiento: -20°C ÷ +50°C
- Equipado con led REBEL ES ANSI

KITS con alimentatori • including drivers

Incassi Gypsolyte • Gypsolyte fixtures

CB9129G50Q1B	ARAGON	Pag. N° 24	Including: BPORTGU1020N + A43QLH5M300W
CB9247G11Q1B	ARAGON XL	Pag. N° 26	Including: A40QL11130M2 + A10MT030000B
CB9128GV5Q1B	ARAGON GLASS	Pag. N° 28	Including: BPORTGU1020N + A43QLH5M300W
CB9222G50Q1B	ARAGON FLAT	Pag. N° 30	Including: BPORTGU1020N + A43QLH5M300W
CB9223G50Q2B	ARAGON TWIN	Pag. N° 32	Including: 2x BPORTGU1020N + A43QLH5M300W
CB9130G50Q1B	OBLO'	Pag. N° 34	Including: BPORTGU1020N + A43QLH5M300W
CB9248G11Q1B	OBLO' XL	Pag. N° 36	Including: A40QL11130M2 + A10MT030000B
CB9224G50Q1B	OBLO' FLAT	Pag. N° 38	Including: BPORTGU1020N + A43QLH5M300W
CB9131G50Q1B	SLIDE	Pag. N° 40	Including: BPORTGU1020N + A43QLH5M300W
CB9229G50Q1B	DIAGONAL	Pag. N° 42	Including: BPORTGU1020N + A43QLH5M300W
CB9431G30Q1B	FLARE SMALL	Pag. N° 44	Including: A40TR0830W00 + A40SL243500B
CB3013G50Q1B	FLARE MEDIUM	Pag. N° 44	Including: BPORTGU1020N + A43QLH5M300W
CB3014G50Q1B	FLARE LARGE	Pag. N° 44	Including: BPORTGU1020N + A43QLH5M300W
CB9262G50Q1B	NEOS SMALL	Pag. N° 48	Including: BPORTGU1020N + A43QLH5M300W
CB9263G50Q1B	NEOS MEDIUM	Pag. N° 48	Including: BPORTGU1020N + A43QLH5M300W
CB9264G50Q1B	NEOS LARGE	Pag. N° 48	Including: BPORTGU1020N + A43QLH5M300W
CB9268G50T1B	ARGO SMALL	Pag. N° 50	Including: BPORTGU1020N + A43QLH5M300W
CB9269G50T1B	ARGO MEDIUM	Pag. N° 50	Including: BPORTGU1020N + A43QLH5M300W
CB9270G50T1B	ARGO LARGE	Pag. N° 50	Including: BPORTGU1020N + A43QLH5M300W
CB9259G11Q1B	CUBE	Pag. N° 52	Including: A40QL11130M2 + A10MT030000B
CB8444G50T2B	PIPE	Pag. N° 54	Including: 2x BPORTGU1020N + A43QLH5M300W
CB8443G50Q2B	PIPE SQUARE	Pag. N° 54	Including: 2x BPORTGU1020N + A43QLH5M300W
CB2308G50Q1B	ARIEL	Pag. N° 56	Including: BPORTGU1020N + A43QLH5M300W
CB2309G50T1B	PEGASUS	Pag. N° 56	Including: BPORTGU1020N + A43QLH5M300W

Pannelli LED • LED Panels

CBPL6060FRAC	60x60 FRAMELESS	Pag. N° 82	42W	Cool White	QLT Driver: MD60
CBPL6060FRAN	60x60 FRAMELESS	Pag. N° 82	42W	Natural White	QLT Driver: MD60
CBPL6060FRAW	60x60 FRAMELESS	Pag. N° 82	42W	Warm White	QLT Driver: MD60
CBPL6060EACW	60x60 Alu frame	Pag. N° 84	42W	Cool White	QLT Driver: MD60
CBPL6060EANW	60x60 Alu frame	Pag. N° 84	42W	Natural White	QLT Driver: MD60
CBPL6060EAWW	60x60 Alu frame	Pag. N° 84	42W	Warm White	QLT Driver: MD60
CBP6060EACB	60x60 White frame	Pag. N° 84	42W	Cool White	QLT Driver: MD60
CBP6060EANB	60x60 White frame	Pag. N° 84	42W	Natural White	QLT Driver: MD60
CBP6060EAWB	60x60 White frame	Pag. N° 84	42W	Warm White	QLT Driver: MD60
CBPL6012EANW	60x120 Alu frame	Pag. N° 84	85W	Natural White	QLT Driver: MB100-24
CBPL6012EAWW	60x120 Alu frame	Pag. N° 84	85W	Warm White	QLT Driver: MB100-24
CBPL3030EACW	30x30	Pag. N° 88	10W	Cool White	QLT Driver: PDV24
CBPL3030EANW	30x30	Pag. N° 88	10W	Natural White	QLT Driver: PDV24
CBPL3030EAWW	30x30	Pag. N° 88	10W	Warm White	QLT Driver: PDV24
CBPL3060EACW	30x60	Pag. N° 88	21W	Cool White	QLT Driver: FB30
CBPL3060EANW	30x60	Pag. N° 88	21W	Natural White	QLT Driver: FB30

KITS con alimentatori • including drivers

CBPL3060EAWW	30x60	Pag. N° 88	21W	Warm White	QLT Driver: FB30
CBPL30120ECW	30x120	Pag. N° 88	45W	Cool White	QLT Driver: MD60
CBPL30120ENW	30x120	Pag. N° 88	45W	Natural White	QLT Driver: MD60
CBPL30120EWW	30x120	Pag. N° 88	45W	Warm White	QLT Driver: MD60
CBPL3030EARG	30x30	Pag. N° 90	10W	RGB	QLT Driver: RGBOX 55
CBPL6060EARG	60x60	Pag. N° 90	45W	RGB	QLT Driver: RGBOX 55
CBPL6012EARG	60X120	Pag. N° 90	55W	RGB	QLT Driver: RGBOX 55

Incassi LED • LED Downlights

CBD0950TNW1B	ROUND95	Pag. N° 92	8W	Natural White	QLT Driver: PDV 24
CBD1400TNW1B	ROUND140	Pag. N° 92	11W	Natural White	QLT Driver: PDV 24
CBD1700TNW1B	ROUND170	Pag. N° 92	16W	Natural White	QLT Driver: PDV 24
CBD2000TNW1B	ROUND200	Pag. N° 92	17W	Natural White	QLT Driver: PDV 24
CBD2750TNW1B	ROUND275	Pag. N° 92	28W	Natural White	QLT Driver: FB 30
CBD3300TNW1B	ROUND330	Pag. N° 92	36W	Natural White	QLT Driver: MB 40-24
CBD0950TWW1B	ROUND95	Pag. N° 92	8W	Warm White	QLT Driver: PDV 24
CBD1400TWW1B	ROUND140	Pag. N° 92	11W	Warm White	QLT Driver: PDV 24
CBD1700TWW1B	ROUND170	Pag. N° 92	16W	Warm White	QLT Driver: PDV 24
CBD2000TWW1B	ROUND200	Pag. N° 92	17W	Warm White	QLT Driver: PDV 24
CBD2750TWW1B	ROUND275	Pag. N° 92	28W	Warm White	QLT Driver: FB 30
CBD3300TWW1B	ROUND330	Pag. N° 92	36W	Warm White	QLT Driver: MB 40-24
CBD1000QNW1B	SQUARE100	Pag. N° 94	6W	Natural White	QLT Driver: PDV 24
CBD1500QNW1B	SQUARE150	Pag. N° 94	12W	Natural White	QLT Driver: PDV 24
CBD1800QNW1B	SQUARE180	Pag. N° 94	18W	Natural White	QLT Driver: PDV 24
CBD2500QNW1B	SQUARE250	Pag. N° 94	31W	Natural White	QLT Driver: MB40-24
CBD3300QNW1B	SQUARE330	Pag. N° 94	42W	Natural White	QLT Driver: MD 60
CBD1000QWW1B	SQUARE100	Pag. N° 94	6W	Warm White	QLT Driver: PDV 24
CBD1500QWW1B	SQUARE150	Pag. N° 94	12W	Warm White	QLT Driver: PDV 24
CBD1800QWW1B	SQUARE180	Pag. N° 94	18W	Warm White	QLT Driver: PDV 24
CBD2500QWW1B	SQUARE250	Pag. N° 94	31W	Warm White	QLT Driver: MB40-24
CBD3300QWW1B	SQUARE330	Pag. N° 94	42W	Warm White	QLT Driver: MD 60
CBD078CTNW0B	BUD78	Pag. N° 96	6W	Natural White	QLT Driver: NICE 206
CBD098CTNW0B	BUD98	Pag. N° 96	10W	Natural White	QLT Driver: PLK 113
CBD116CTNW0B	BUD116	Pag. N° 96	14W	Natural White	QLT Driver: PLK 112
CBD142CTNW0B	BUD142	Pag. N° 96	20W	Natural White	QLT Driver: PD 315
CBD210CTNW0B	BUD210	Pag. N° 96	27W	Natural White	QLT Driver: FB330
CBD078CTWW0B	BUD78	Pag. N° 96	6W	Warm White	QLT Driver: NICE 206
CBD098CTWW0B	BUD98	Pag. N° 96	10W	Warm White	QLT Driver: PLK 113
CBD116CTWW0B	BUD116	Pag. N° 96	14W	Warm White	QLT Driver: PLK 112
CBD142CTWW0B	BUD142	Pag. N° 96	20W	Warm White	QLT Driver: PD 315

KITS con alimentatori • including drivers

CBD210CTWW0B	BUD210	Pag. N° 96	27W	Warm White	QLT Driver: FB330
CBD135CTNW0B	ORION135	Pag. N° 98	15W	Natural White	QLT Driver: FB 310
CBD160CTNW0B	ORION160	Pag. N° 98	17W	Natural White	QLT Driver: FB 310
CBD190CTNW0B	ORION190	Pag. N° 98	20W	Natural White	QLT Driver: FB 310
CBD228CTNW0B	ORION228	Pag. N° 98	34W	Natural White	QLT Driver: MC56
CBD135CTWW0B	ORION135	Pag. N° 98	15W	Warm White	QLT Driver: FB 310
CBD160CTWW0B	ORION160	Pag. N° 98	17W	Warm White	QLT Driver: FB 310
CBD190CTWW0B	ORION190	Pag. N° 98	20W	Warm White	QLT Driver: FB 310
CBD228CTWW0B	ORION228	Pag. N° 98	34W	Warm White	QLT Driver: MC56
CBD160CCTRGB	ORION160 RGB	Pag. N° 100	11W	RGB	QLT Driver: RGBOX35
CBD228CCTRGB	ORION228 RGB	Pag. N° 100	17W	RGB	QLT Driver: RGBOX35
CBD19BASTNW0B	OPERA190	Pag. N° 102	19W	Natural White	QLT Driver: PD 315
CBD27BASTNW0B	OPERA270	Pag. N° 102	27W	Natural White	QLT Driver: FB 330
CBD19BASTWW0B	OPERA190	Pag. N° 102	19W	Warm White	QLT Driver: PD 315
CBD27BASTWW0B	OPERA270	Pag. N° 102	27W	Warm White	QLT Driver: FB 330
CBD13BASTNW0B	KARMA130	Pag. N° 104	13W	Natural White	QLT Driver: PD 312
CBD28BASTNW0B	KARMA280	Pag. N° 104	28W	Natural White	QLT Driver: FB 330
CBD13BASTWW0B	KARMA130	Pag. N° 104	13W	Warm White	QLT Driver: PD 312
CBD28BASTWW0B	KARMA280	Pag. N° 104	28W	Warm White	QLT Driver: FB 330

Plafoniere LED • LED Fixtures

BS1X060CW00B	FUTURA 60 CW	Pag. N° 116		Cool White	1x60cm (1x10W - 1x1050Lm) 5000K
BS1X120CW00B	FUTURA 120 CW	Pag. N° 116		Cool White	1x120cm (1x20W - 1x2000Lm) 5000K
BS1X150CW00B	FUTURA 150 CW	Pag. N° 116		Cool White	1x150cm (1x22W - 1x2500Lm) 5000K
BS2X060CW00B	FUTURA TWIN 60 CW	Pag. N° 116		Cool White	2x60cm (2x10W - 2x1050Lm) 5000K
BS2X120CW00B	FUTURA TWIN 120 CW	Pag. N° 116		Cool White	2x120cm (2x20W - 2x2000Lm) 5000K
BS2X150CW00B	FUTURA TWIN 150 CW	Pag. N° 116		Cool White	2x150cm (2x22W - 2x2500Lm) 5000K
BS1X060NW00B	FUTURA 60 NW	Pag. N° 116		Natural White	1 x 60cm (1x10W - 1x1000Lm) 4000K
BS1X120NW00B	FUTURA 120 NW	Pag. N° 116		Natural White	1 x 120cm (1x20W - 1x1950Lm) 4000K
BS1X150NW00B	FUTURA 150 NW	Pag. N° 116		Natural White	1 x 150cm (1x22W - 1x2450Lm) 4000K
BS2X060NW00B	FUTURA TWIN 60 NW	Pag. N° 116		Natural White	2 x 60cm (2x10W - 2x1000Lm) 4000K
BS2X120NW00B	FUTURA TWIN 120 NW	Pag. N° 116		Natural White	2 x 120cm (2x20W - 2x1950Lm) 4000K
BS2X150NW00B	FUTURA TWIN 150 NW	Pag. N° 116		Natural White	2 x 150cm (2x22W - 2x2450Lm) 4000K
BS1X060WW00B	FUTURA 60 WW	Pag. N° 116		Warm White	1 x 60cm (1x10W - 1x890Lm) 3000K
BS1X120WW00B	FUTURA 120 WW	Pag. N° 116		Warm White	1 x 120cm (1x20W - 1x1750Lm) 3000K
BS1X150WW00B	FUTURA 150 WW	Pag. N° 116		Warm White	1 x 150cm (1x22W - 1x2100Lm) 3000K
BS2X060WW00B	FUTURA TWIN 60 WW	Pag. N° 116		Warm White	2 x 60cm (2x10W - 2x890Lm) 3000K
BS2X120WW00B	FUTURA TWIN 120 WW	Pag. N° 116		Warm White	2 x 120cm (2x20W - 2x1750Lm) 3000K
BS2X150WW00B	FUTURA TWIN 150 WW	Pag. N° 116		Warm White	2 x 150cm (2x22W - 2x2100Lm) 3000K

