

LED QUALI-Funk

RGB / Farbtemperatur / Dimm 433MHz Funk-Komponenten

 Kollektion 2015

96/288
WattRF
433MHzPF
 $\lambda \geq 0,96$

IP 20

CE

EMC

M

M

F

 $t_a -20^\circ \pm +45^\circ \text{C}$ 

110 mm



...auch mit Tablet und Handy steuerbar

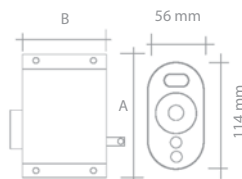

Centralina controllata Wi-Fi o radiocomando uscita RGB / Temperatura colore variabile

- Classe II di isolamento - Bassa tensione - IP20
- Regolazione con comando Wi-Fi, Software Android in dotazione, IOS scaricabile
- Disponibile per controllo RGB o della temperatura del colore
- Alimentazione: 12 o 24V DC. Uscita: PWM 12V o 24V max 3 x 4A
- Radiocomando 433 MHz codificato multifunzione
- Fornito con telecomando a batteria (3 x AAA non incluse)

Wi-Fi Controlled Interface or Radiotransmitter for RGB / Color Temperature Control

- Insulation class II - Low voltage system - IP20
- Wi-Fi control, Android standard software, IOS software compatible (to be downloaded)
- Available for RGB or color temperature control
- Input: 12/24V DC. Output: PWM 12V/24V DC max 3 x 4A
- Radio control 433 Mhz multifunction
- Possible connection of more devices together
- Delivered with battery remote control (3 x AAA not included)

Wi-Fi und Funk Controller für RGB- bzw. Farbtemperatur Steuerung

- Isolationschutzklasse II - Niederspannung - IP20
- Wi-Fi Control, Android Standard Software, IOS Software kompatibel (zum Download)
- In 2 Ausführungen $\overline{\text{W}}\overline{\text{b}}\overline{\text{a}}\overline{\text{r}}$: RGB oder Steuerung der Farbtemperatur
- Eingang: 12/24V DC. Ausgang: PWM 12/24V DC max 3 x 4A
- Fernsteuerung 433 Mhz - Multifunktion
- Steuerung von mehreren Geräten möglich
- Inkl. Fernbedienung (Batterien 3 x AAA nicht $\overline{\text{W}}\overline{\text{b}}\overline{\text{a}}\overline{\text{r}}$ XS Y)

Centrale pilotée par Wi-Fi ou commande-radio. Sortie RGB / Température couleur variable

- Classe II d'isolation - Encastrable - IP20
- Régulation par commande Wi-Fi. Équipée de Software Android, IOS téléchargeable
- Disponible pour contrôle RGB ou de la température de la couleur
- Alimentation: 12V ou 24V DC. Sortie: PWM 12V ou 24V max 3 x 4A
- Commande-radio 433 MHz badgé, multifonctionnel
- Possibilité de piloter plusieurs appareil en même temps
- Fournie avec télécommande à batterie (3 x AAA non incluses)

Controlador Wi-Fi o radio salida RGB / temperatura del blanco

- Aislamiento Clase II - baja tensión - IP20
- Regulación con Wi-Fi, Android Software suministrado, IOS descargable
- Disponible por controlador RGB o por controlador de la temperatura del blanco
- Fuente de alimentación: 12 V o 24 V de CC. Salida: PWM 12V o 24V máximo 3 x 4A
- Control remoto inalámbrico multifuncional codificado 433MHz
- Posibilidad de controlar varios dispositivos simultáneamente
- Suministrado con el mando a distancia (pilas 3 x AAA non incluidas)

Part number	Color	INPUT		I Max	OUTPUT V Max	Watt	Dimensions A x B x C
		Min	Max				
A40WIFIRGB0N	RGB	12	24	12A	Vin -0.5V	144/288 W	109 x 63 x 28,5
A40WIFICT00N	Color Temperature	12	24	8A	Vin -0.5V	96/192 W	109 x 63 x 28,5

120/240
Watt

RF
433MHz

CV
V
I

PF
 $\lambda \geq 0,6$

IP 40

CE

EMC

M

M

F

$t_a -20^{\circ} \div +40^{\circ}C$

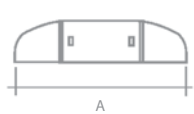
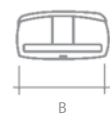

Centralina per radiocomando 433 Mhz con uscita RGB / Dimmer / Temperatura colore variabile

- Classe II di isolamento - Indipendente - IP40
- Disponibile in tre versioni: Dimmer, controllo della temperatura del colore e RGB
- Alimentazione: 12÷24V DC
- Riceve comando dai componenti 433 Mhz
- Possibile sincronizzazione con 4 dispositivi di comando (4 codici)

Centrale pour commande-radio 433Mhz avec sortie RGB/Dimmer/Température couleur variable

- Classe II d'isolation - Indépendant - IP40
- Disponible en trois versions: dimmer, contrôle de la température de la couleur et RGB
- Alimentation: 12÷24V DC
- Reçoit commandes en provenance des composants 433Mhz
- Possibilité de synchronisation de la centrale avec 4 commandes différentes (4 codes)

Radio controlled interface 433 Mhz with RGB / Dimmer / Color Temperature Control

- Insulation class II - For independent mounting - IP40
- Available in 3 versions: dimmer, color temperature control and RGB
- Input: 12÷24V DC
- Receiving signal from 433 Mhz components
- Possible synchronization of max. 4 different control devices (4 codes)

Controlador de mando a distancia 433 Mhz con salida RGB / Dimmer / Variacion del blanco

- Aislamiento Clase II - Independiente - IP40
- Disponible en tres versiones: dimmer, control de la temperatura del blanco y RGB
- Alimentación: 12÷24V DC
- Recibe comandos de los componentes de 433 Mhz
- Posibilidad de sincronización de 4 diferentes unidades de control (4 codigos)

Funk-Controller 433Mhz für RGB / Farbtemperatur / Dimmer Steuerung

- Isolationschutzklasse II - Unabhängiger Einsatz - IP40
- In 3 Ausführungen (Farbtemperatur, RGB, Dimmer)
- 433Mhz Funkempfänger
- 12÷24V DC
- 433Mhz Funkempfänger
- Mögliche Synchronisierung von max. 4 verschiedenen Steuerungssystemen (4 5aVV)

Part number	Color	INPUT		I Max	OUTPUT V Max	Watt	Dimensions A x B x C
		Min	Max				
A40PDL43RBBB	RGB	12	24	3 x 3,3A	Vin -0.1V	120/240 W	138 x 40 x 28,5
A40PDL43CT0B	Color Temperature	12	24	2 x 5A	Vin -0.1V	120/240 W	138 x 40 x 28,5
A40PDL43DIMB	Dimmer	12	24	3 x 3,3A	Vin -0.1V	120/240 W	138 x 40 x 28,5



Radiocomando 433 Mhz RGB / Temperatura colore variabile / Dimmer

- Controlla le centraline WI-FI e PDL43 serie
- Disponibile in tre versioni: RGB, controllo della temperatura del colore e Dimmer
- Alimentazione: batterie 3 x AAA (non incluse)
- Pulsante multifunzione con 9 modalità diverse (non fornite)
- Modalità Sleep per risparmio batterie

Radio Transmitter 433 Mhz RGB / Color Temperature Control / Dimmer

- It controls WI-FI controllers and PDL43 range
- Available in 3 versions: RGB, color temperature control and dimmer
- Input: batteries 3 x AAA (not included)
- Multifunction pushbutton with 9 different modes
- Ssleep Mode for battery saving

Funk-Fernbedienung 433Mhz für Steuerung RGB / Farbtemperatur / Dimmer Controller

- Steuerung von CgS [ZWI-FI g V CgS [Zg] Controller
- In 3 Ausführungen (WIFI Sd RGB, FarTW, bVdfgd Dimmer
- Speisung: Batterien 3 x AAA (nicht [>[Wt]_ X' Y)
- Multifunktion [FsfW mit 9 verschiedenen Funktionen
- Sleep Mode für BatterieVparung

Télécommande 433Mhz RGB / Température de couleur variable / Dimmer

- Contrôle les centrales WI-FI et PDL43 de série
- Disponible en trois versions: RGB, contrôle de la température de la couleur et dimmer
- Alimentation: piles 3 x AAA (non fournies)
- Bouton-poussoir multifonction avec 9 modalités différentes
- Modalité Sleep pour économiser les piles

Radio Transmisor 433 Mhz RGB / control de temperatura del color / regulador de intensidad

- Aislamiento Clase II - baja tensión - IP40
- Controla reguladores WI-FI y de rango PDL43
- Disponible en 3 versiones: RGB, control de temperatura del color y regulador de intensidad
- Alimentación: 3 pilas x AAA (non incluidas)
- Botón multifunction con hasta 9 modos diferentes
- Funcion "sleep" para ahorrar baterias

Part number	Color	OUTPUT	Dimensions A x B x C
A40RC433RGBN	RGB	433 MHz	114 x 56 x 24
A40RC433CT0N	Color Temperature	433 MHz	114 x 56 x 24
A40RC433DIMN	Dimmer	433 MHz	114 x 56 x 24

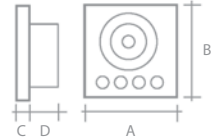
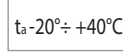

Centralina radiocomando a tocco con uscita RGB / Dimmer / Temperatura colore variabile

- Classe II di isolamento - Da incasso - IP40
- Fornito con scatola plastica per fissaggio a muro o mobile
- Disponibile in tre versioni: Dimmer, controllo della temperatura del colore e RGB.
- Alimentazione: 230V AC
- Radiocomando 433MHz codificato multifunzione
- Compatibile con scatole tipo 86 da incasso

Touch Radio Controller with RGB / Dimmer / Color Temperature Control

- Insulation class II - To be built in - IP40
- Wall box for built-in mounting available
- Available in 3 versions: Dimmer, color temperature control and RGB
- Input: 230V AC
- Radio control 433 Mhz multifunction
- Compatible with electric boxes, type 86

Funk-Wandbedienung für mit RGB / Farbtemperatur / Dimmer Controller

- Isolationschutzklasse II - Zum Einbauen - IP40
-] 73B9VZageM_ >|Wdt_ X\$ Y
- In 3 Ausführungen |Wdt| Sd D94| 8Sd| fW_ bVdSfgd 6|_ Vd
- 4Vd|VeebS` g` Y: 230V AC
- Fernsteuerung 433 Mhz Multifunktion
- Kompatibel mit 7| TSgVosen, Typ86

Commande-radio TOUCH avec sortie RGB/Dimmer/ Température de couleur variable

- Classe II d'isolation - Encastrable - IP40
- Fourni avec boîte plastique pour encastrement au mur ou mobile
- Disponible en trois versions: Dimmer, contrôle de la température de la couleur et RGB.
- Alimentation: 230V AC
- Commande-radio 433MHz badgé, multifonctionnel
- Adaptables aux boîtes encastrables type 86

Radio controlador RGB / Dimmer / temperatura del blanco

- Aislamiento Clase II - para empotrar en pared - IP40
- Disponible en caja de plástico para empotrar en pared o móviles
- Disponible en tres versiones: controlador de la temperatura del blanco y RGB.
- Fuente de alimentación: 230V AC
- Control remoto inalámbrico multifuncional codificado 433MHz
- Compatible con cajas tipo 86 para empotrar

Part number	Color	INPUT	OUTPUT	Dimensions A x B x C x D
A40WALLRGB0N	RGB	0,4W (sleep) / 1,5W (action)	433 MHz	86 x 86 x 13 x 26
A40WALLCT00N	Color Temperature	0,4W (sleep) / 1,5W (action)	433 MHz	86 x 86 x 13 x 26
A40WALLDIM0N	Dimmer	0,4W (sleep) / 1,5W (action)	433 MHz	86 x 86 x 13 x 26

288/500
Watt

$\frac{V}{V}$
CV

PF
 $\lambda \geq 0,96$

IP 40

CE

EMC

M

M

F

$t_a -20^\circ \div +40^\circ C$

45 mm

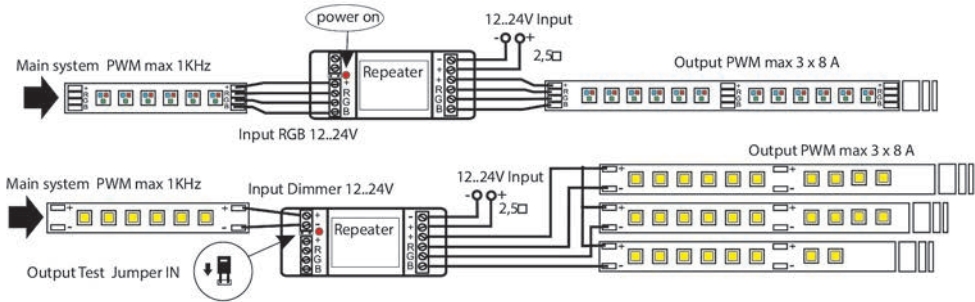
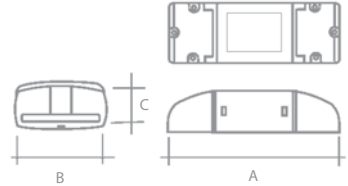

Amplificatore/ripetitore di segnale RGB / Dimmer

- Classe II di isolamento - Bassa tensione - IP40
- Ripete il segnale RGB o Dimmer in ingresso e comanda il carico di uscita
- Alimentazione: 12 o 24V DC
- Uscita: strisce Led a tensione costante 12V o 24V
- Ingresso isolato Master per funzione Dimmer
- Collegamento in cascata di 3 apparecchi

Booster/Repeater signal RGB / Dimmer

- Insulation class II - Low voltage system - IP40
- It repeats the input RGB or dimming signal and controls the output load
- Input: 12 oder 24VDC
- Output: constant voltage LED strips 12VDC or 24VDC
- Isolated Master input for dimming system
- Possible cascade connection of 3 devices

Booster/Repeater Signal RGB / Dimmer

- Isolationschutzklasse II - Niederspannung - IP40
- Wiederholt das Eingangssignal und steuert die Ausgangslast
- Eingangsspannung: 12 oder 24VDC
- Ausgang: Led-Streifen konstantspannung 12V oder 24VDC

- Isoliert Mastereingang für Dimmerfunktion
- Mögliche Kaskadierung bis 3 Geräten

Amplificateur/Répétiteur de signal "RGB"

- Classe II d'isolation - Basse tension - IP40
- Il repète le signal RGB ou Dimmer sur l'entrée et il pilote la charge sur la sortie
- Alimentation: 12 ou 24V DC
- Sortie: rubans led à tension constante 12V ou 24V
- Entrée Master isolée pour fonction Dimmer
- Connexion en cascade jusqu'à 3 appareils

Amplificador/repetidor de señal RGB / Dimmer

- Aislamiento Clase II - baja tensión - IP40
- Repite la señal RGB o Dimmer en entrada y controla la carga de salida
- Alimentación: 12 V DC o 24 V DC
- Salida: tiras de LED 12V o 24V tension constante
- Entrada aislada para la función master Dimmer
- Conexión de 3 dispositivos en cascada

Part number	Color	INPUT		I Max	OUTPUT		Dimensions A x B x C
		Min	Max		V Max	Watt	
A40PWMREPO0B	RGB/Dimmer	12	24	24A	Vin -0.1V	288/500 W	138 x 40 x 28,5

36-100
WattPF
 $\lambda \geq 0,85$

IP 20



EMC

EQUIV.
SELV $t_a -10^{\circ}\div +40^{\circ}\text{C}$ 

MB40



MB100

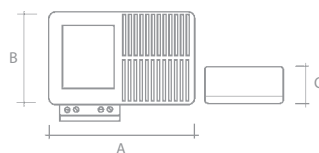

Convertitori LED 12-24V

- Alimentatore da incorporare - IP20 - Classe II di isolamento
- Uscita in tensione costante, $\pm 5\%$
- Protezione autoripristinante contro le sovratemperature e i corto-circuiti sul secondario.
- Rifasatore passivo, costruzione compatta e basso riscaldamento.
- Doppio collegamento di uscita
- Alimentazione: 190 \div 265V/AC o 100..110V/AC 50..60Hz
- Uscita stabilizzata

12-24V LED Drivers

- Built in driver - IP20 - Insulation class II
- Steady voltage output, $\pm 5\%$
- Self-resetting protection against overtemperatures and output short circuits.
- Passive Power factor correction, compact size and reduced heating.
- Double output connection
- Input voltage: 190 \div 265V/AC or 100..110V/AC 50..60Hz
- Steady output.

12-24V LED-Konverter

- Unabhängiger Konverter - IP20 - Isolationsklasse II
- Ausgang in Konstansspannung, $\pm 5\%$
- Schutz gegen Hochtemperaturen g`V =urzschlusse` auf der Sekundärseite

- PTC: passiver Leistungsfaktorkorrekturfilter - Kompakt
- Geringe Wärmeentwicklung
- Doppelter Ausgangsanschluss
- Speisung: 190 \div 265V/AC oder 100..110V/AC 50..60Hz
- Stabilisierte Ausgangsb`S` g`Y.

Convertisseurs LED 12-24V

- Alimentation à incorporer - IP20 - Classe II, double isolation
- Sortie en tension constante, $\pm 5\%$
- Protection à rétablissement automatique contre les surchauffes et les courts-circuits sur le secondaire
- Rephasateur passif de tension, taille compacte et réchauffement faible
- Alimentation: 190 \div 265V/AC ou 100..110V/AC 50..60Hz
- Sortie stabilisée.

Convertidor LED 12-24V

- Convertidor para incorporar - IP20 - Clase de aislamiento II
- Salida en tensión constante, $\pm 5\%$
- Protección con restablecimiento automatico contra los sobrecalentamientos y los cortocircuitos en secundario.
- Corrección del factor de potencia pasiva, tamaño compacto y calentamiento reducido.
- Doble salida
- Alimentación: desde 190 \div 265V/AC o 100..110V/AC 50..60Hz
- Salida estabilizada.

Part number	OUTPUT V	OUTPUT (W)		Dimensions A x B x C
		Max@230V	Max@110V	
A40MB04000N	12V	3,3A 40W		78 x 66 x 29
A40MB040U00N	12V		3A 36W	78 x 66 x 29
A40MB100000N	12V	8A 100W		117 x 89 x 40
A40MB100U00N	12V		5A 60W	117 x 89 x 40
A40MB040240N	24V	1,7A 40W		78 x 66 x 29
A40MB040U24N	24V		1,5A 36W	78 x 66 x 29
A40MB100240N	24V	4A 100W		117 x 89 x 40
A40MB100U24N	24V		2,5A 60W	117 x 89 x 40

96-192
WattPF
 $\lambda \geq 0,95$ IP 65

CE

EMC



M

M

F

110

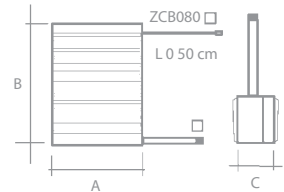
EQUIV.
SELV $t_a -20^\circ \pm +45^\circ \text{C}$
115 mm

Convertitori per LED di potenza

- Alimentatore da incorporare - IP65 - Classe II di isolamento
- Uscita in tensione costante, $\pm 7\%$
- Protezione autoripristinante contro le sovratemperature e i corto-circuiti sul secondario.
- Contenitore plastico termoconduttivo per dissipazione del calore, alto rapporto volume potenza
- Alimentazione: 100÷250V/AC - Uscita stabilizzata

Converters for High Brightness LEDs

- Built-in driver - IP65 - Insulation class II
- Output in steady voltage, $\pm 7\%$
- Self-resetting protection against overtemperatures and output short circuits
- Thermo conductive housing with high heat dissipating capacity.
- Input voltage: 100÷250V/AC - Steady output.

Konverter für High Brightness LED

- Einbaukonverter - IP65 - Isolationsklasse II
- Ausgang in Konstanzspannung, $\pm 7\%$
- Schutz gegen Hochtemperaturen $\pm 7\%$
- Thermoleitfähiges Kunststoffgehäuse als Wärmesenke
- Speisung: 100÷250V/AC - Stabilisierte Ausgangsspannung

Convertisseur pour LED de puissance

- Alimentation à incorporer - IP65 - Classe II, double isolation
- Sortie en tension constante, $\pm 7\%$
- Protection à rétablissement automatique contre les surchauffes et les courts-circuits sur le secondaire
- Boîtier plastique thermoconducteur pour dissipation de la chaleur. Rapport volume/puissance important
- Alimentation: 100÷250V/AC - Sortie stabilisée

Convertidores para LED de potencia

- Convertidor para incorporar - IP65 - Clase II, doble aislamiento
- Salida en tensión constante, $\pm 7\%$
- Protección contra los sobrecalentamientos y los corto-circuitos en el secundario
- Termo contenedor plástico para perfecta disipación de calor, alta proporción volumen/potencia.
- Alimentación: desde 100÷250V/AC - Salida estabilizada.

Part number	OUTPUT V	OUTPUT (W)		Dimensions A x B x C
		_ ax@230V	_ ax@110V	
A40MB150000B	12V	12A 144W	8A 96W	152 x 104 x 46
A40MB200000B	24V	8A 192W	5A 120W	152 x 104 x 46

Radio Control - Installation Examples

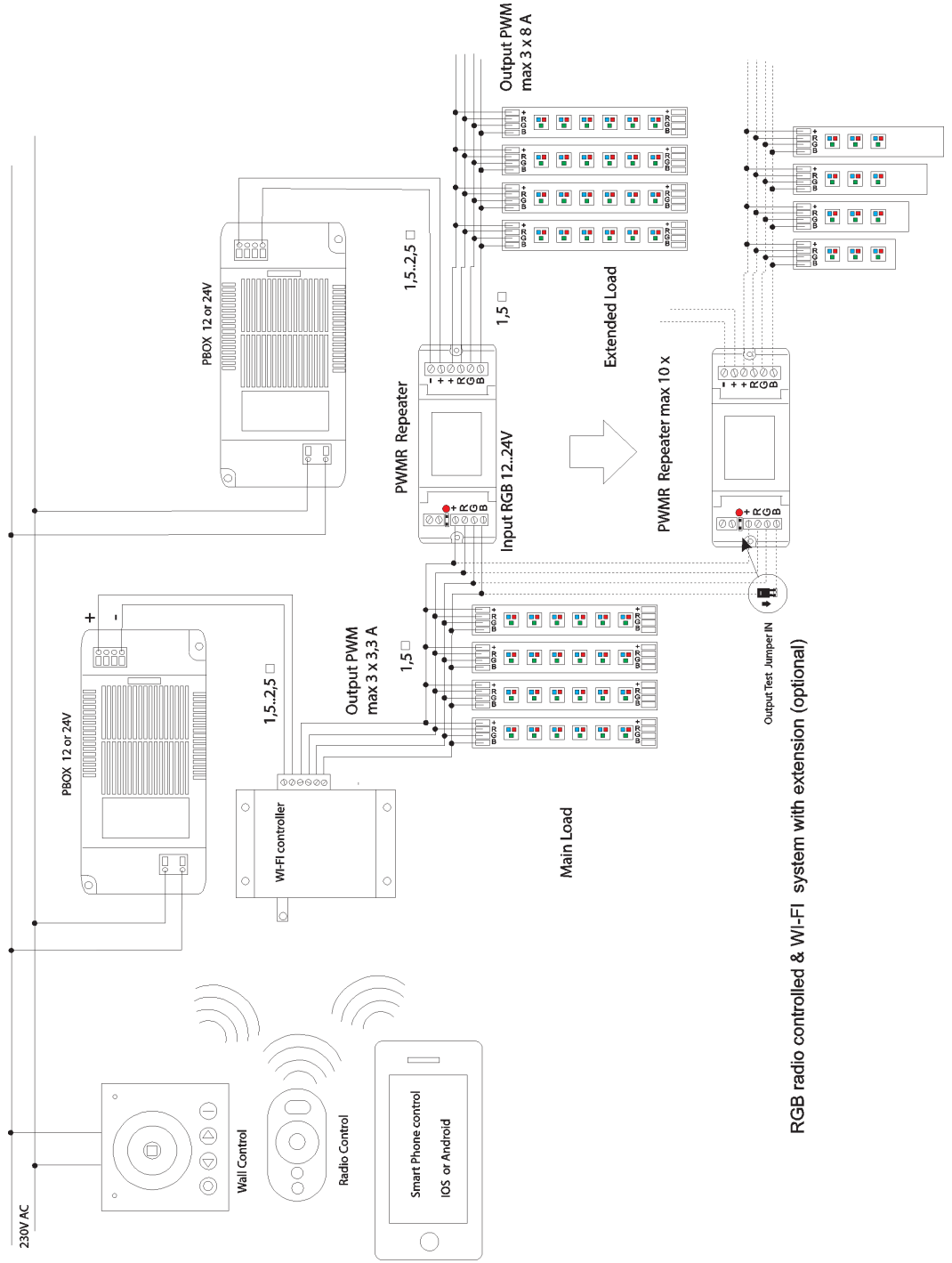

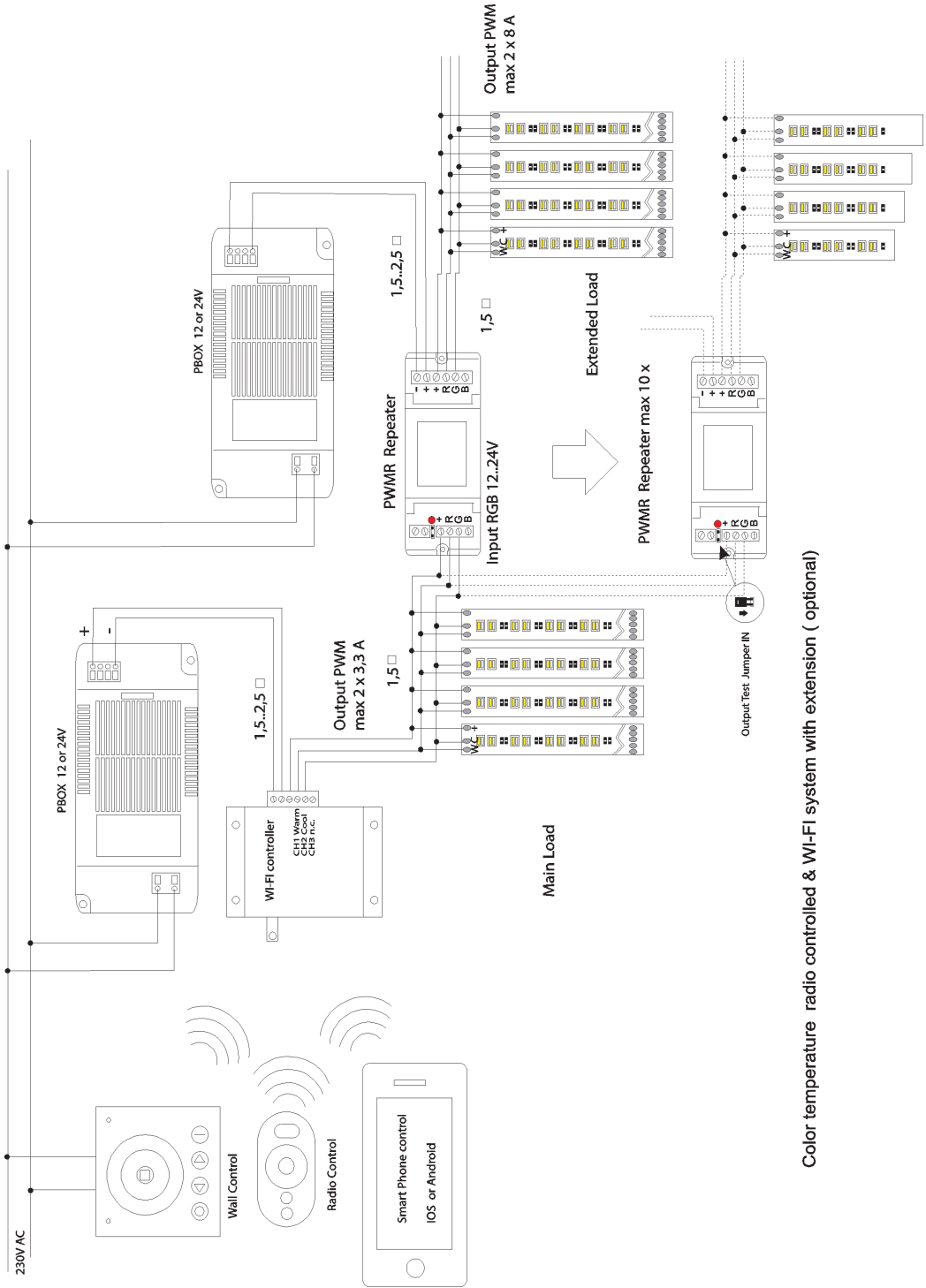

Color temperature radio controlled & Wi-Fi system with extension (optional)

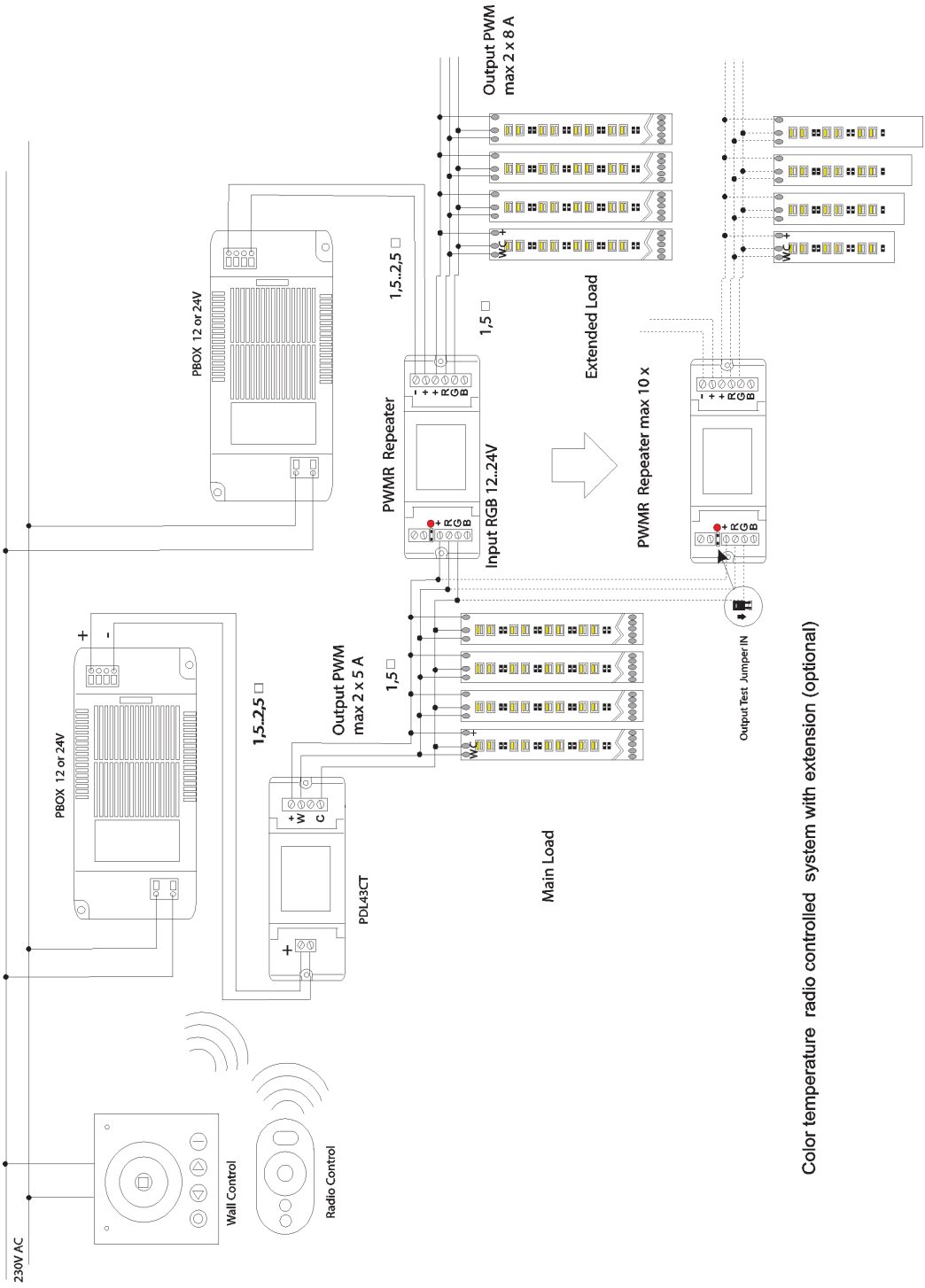

Color temperature radio controlled system with extension (optional)

RC433 Wall 433 radiocomando Caratteristiche e specifiche tecniche

i modelli RC433 e Wall sono una serie di radiocomandi realizzati per comandare le centraline PD43 e WI-FI
 Frequenza di funzionamento: 433MHz con portata circa 30m max. Segnale codificato per evitare interferenze
 Se non utilizzato spegnimento automatico per salvaguardare le batterie. (premere ON per riattivare dopo una pausa)
 Nota : il pulsante MODE permette di selezionare diversi effetti a seconda del telecomando, ogni pressione avanza alla successiva(vedi tabelle)
 Serie RC433 Batterie : 4.5V (AAA*3) Non incluse nella confezione. Consumo 10mA max , 7 uA a riposo(sleep mode)
 Serie Wall Alimentazione :90...250V AC Standby <0,2W Azione 1,5W



Procedura di sincronizzazione (Solo in caso di perdita del codice o nel caso di dispositivi con codici diversi)

1. Accendere l'alimentatore PD43 oppure WI-FI tenendo premuto il tasto MODE del telecomando o del Wall
2. L'alimentatore si porterà al 50% del flusso luminoso(se l'alimentatore non si porta al 50% ripetere il punto 1)
3. Premere il tasto ON del telecomando e poi premere MODE . La luce si porterà dal 50% al 25%
4. Premere il tasto ON del telecomando e poi premere MODE . La luce si porterà dal 25% al 5%
5. Premere il tasto ON del telecomando , la luce si porterà al 100% . la procedura è completata .(Se non avviene ripetere dal punto 1)

NOTA: per le centraline RGB premere il tasto PAUSE al posto del tasto ON

Nota :Ogni ricevitore può ricevere il codice da 4 dispositivi di comando diversi.

Mode CT controllo temperatura

1	Massima luce	Luce regolabile
2	Lampeggio totale	Velocità regolabile
3	Caldo e Freddo progressivo	Velocità regolabile
4	Caldo e Freddo si alternano	Velocità regolabile
5	C e F dissolvenza alternata	Velocità regolabile
6	C al massimo e F lampeggio	Velocità regolabile
7	C al massimo e F dissolvenza	Velocità regolabile
8	C lampeggio F al massimo	Velocità regolabile
9	F al massimo C dissolvenza	Velocità regolabile

Mode RGB controllo colore

1	Bianco Caldo	Luce regolabile
2	Bianco Freddo	Velocità regolabile
3	Bianco Ciclico	Velocità regolabile
4	Rotazione 7 colori	Velocità regolabile
5	Rotazione 7 colori mezzo tono	Velocità regolabile
6	Rotazione 7 colori sfumati	Velocità regolabile
7	Dissolvenza R/B	Velocità regolabile
8	Dissolvenza B/G	Velocità regolabile
9	Dissolvenza G/R	Velocità regolabile

Mode Dimmer

1	Flash	Velocità regolabile
2	Dissolvenza	Velocità regolabile

RC433 WALL series-RF remote control Features & Technical specification

RC433 and Wall is a series of RF full touch remote control designed for LED lighting products.
 Compatible with PD43 series and WI-FI controller.
 RF frequency: 433.92MHz. Transmission Distance : up to 30m , no need line-of-sight Unique encoding avoids signal interference and maintains system's stability..
 Sleep-wake up design, for energy conservation.This series RF will sleep down in more than 20 seconds no used to save the energy. In this case, the touch ring will be no reaction, please touch ON button to wake up the remote control firstly.
 MODE push button : Each touch move to the next.(see table)
 RC433 Working voltage : 4.5V (AAA*3) Not included Working current : 10mA Standby current :7 uA
 Serie Wall Power supply :90...250V AC Standby <0,2W Work 1,5W

Important: Matching procedure (in case of problem or spare part or loosing memory)

- As RF signal sender, set up the RF remote control to a RF led driver (RF receiver) before use.
1. Press and hold the "Mode" key before the "RF LED Driver" powering on, the RF signal light lights red.
 2. Power up the "RF LED Driver", and the LEDs will output 50% brightness (Tip: if the output does not output 50% brightness, indicating that the code learning is not successful, need to repeat the step 1) .
 3. Press the "ON"(CT, DIM)"/"Pause" (RGB)key, then the LEDs will be 25% brightness.
 4. Press the "Mode" key again, then the LEDs will be 5% brightness.
 5. Press the "ON"(CT, DIM)"/"Pause" (RGB) key again, then the LEDs will be 100% brightness, and indicating the successful code learning. If not, repeat from step 1.

Mode CT controllo temperatura

1	Full Power	Brightness is adj.
2	Full Power Flash	Speed is adjustable
3	Warm and Cool fade	Speed is adjustable
4	Warm e Cool flash Flip Flop	Speed is adjustable
5	W e C fade and reverse	Speed is adjustable
6	Warm full Cool Flash	Speed is adjustable
7	Warm full Cool Fade	Speed is adjustable
8	Warm Flash Cool Full	Speed is adjustable
9	Cool Full Warm Fade	Speed is adjustable

Mode RGB controllo colore

1	Warm White	Brightness is adj.
2	Cool White	Speed is adjustable
3	White Breath	Speed is adjustable
4	7 Colors Change	Speed is adjustable
5	7 Colors Smooth	Speed is adjustable
6	7 Colors Fade	Speed is adjustable
7	R/B Crossfade	Speed is adjustable
8	B/G Crossfade	Speed is adjustable
9	G/R Crossfade	Speed is adjustable

Mode Dimmer

1	Flash	Speed Adjustable
2	Fade	Speed Adjustable

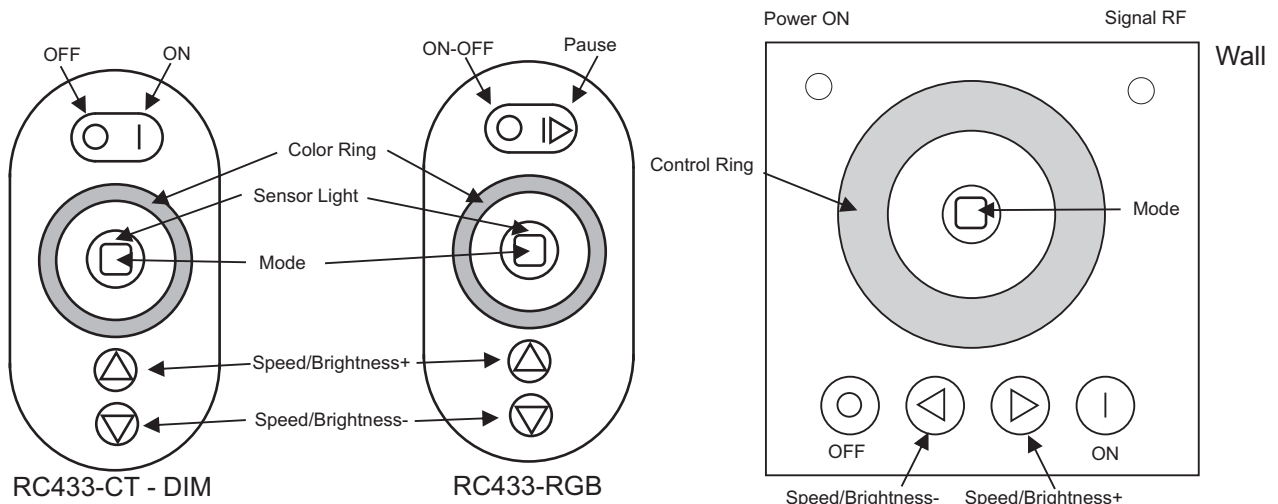

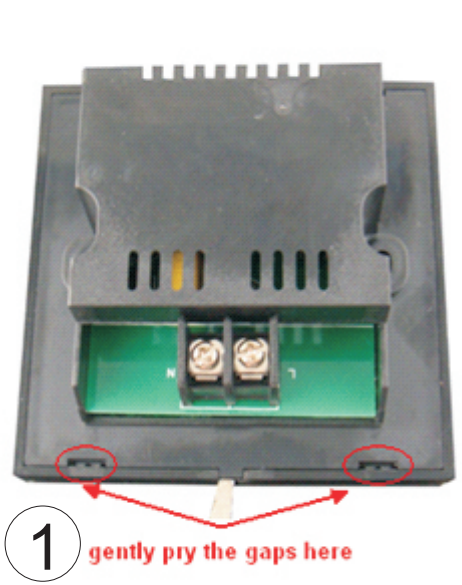

1 gently pry the gaps here

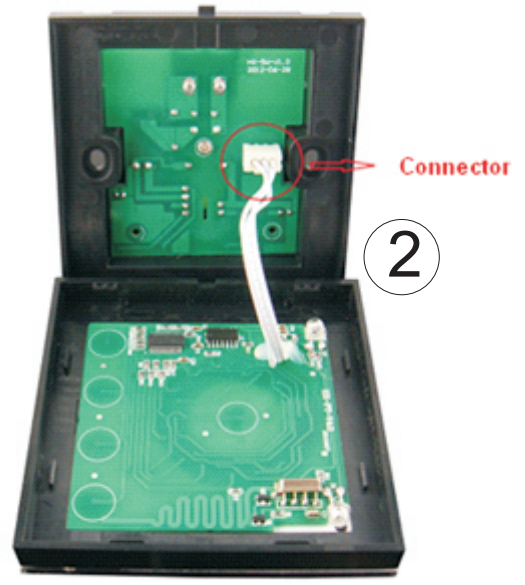

Connector

2

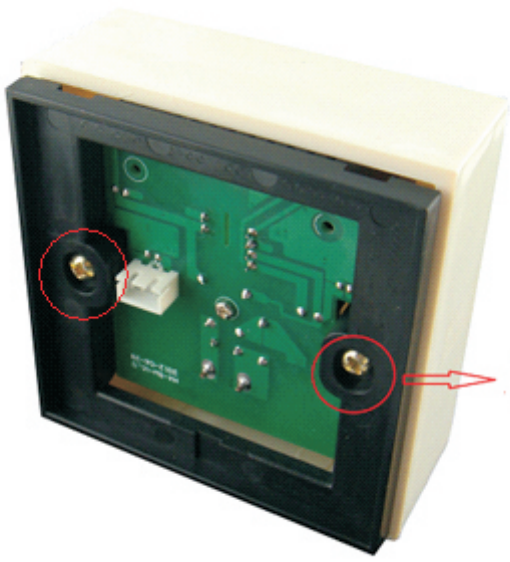

3 fix the base part in the installation box with screws.

3

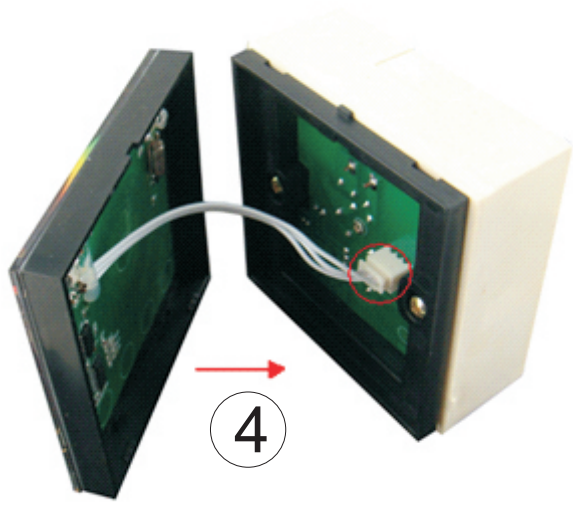

4



5